

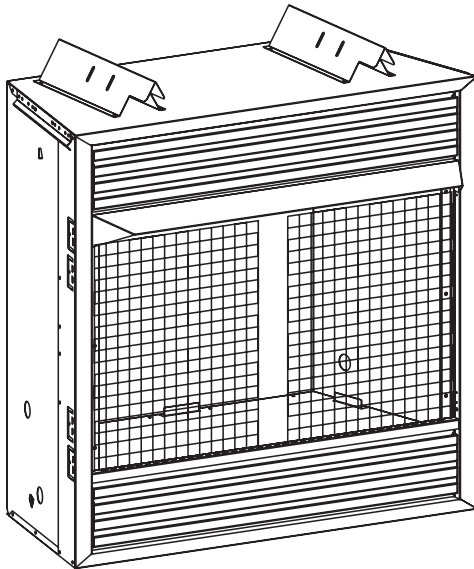

INSTALLATION INSTRUCTIONS AND OWNER'S MANUAL

The *Breckenridge* Vent-Free Universal Fireboxes



Installer: Please leave these instructions with the consumer.

Consumer: Please retain these instructions for future use.

**FOR USE ONLY
WITH VENT-FREE LOG SETS
DO NOT BUILD A WOOD FIRE.**

DO NOT ATTEMPT TO MODIFY OR ALTER THE CONSTRUCTION OF THE FIREBOX OR ITS COMPONENTS. ANY MODIFICATION OR ALTERATION OF CONSTRUCTION MAY VOID THE WARRANTY OF THIS FIREBOX.

CHILDREN AND ADULTS SHOULD BE ALERTED TO THE HAZARDS OF HIGH SURFACE TEMPERATURE AND SHOULD STAY AWAY TO AVOID BURNS OR CLOTHING IGNITION.

YOUNG CHILDREN SHOULD BE CAREFULLY SUPERVISED WHEN THEY ARE IN THE SAME ROOM AS THE FIREBOX.

UNIVERSAL FIREBOX FOR ALL VENT-FREE LOG SETS

MODELS

VFFD-32-1	VFFD-36-1	VFFD-42-1
VFFD-32L-1	VFFD-36L-1	VFFD-42L-1
VFFP-32-1	VFFP-36-1	VFFP-42-1
VFFP-32L-1	VFFP-36L-1	VFFP-42L-1

Effective Date
April 2004

WARNING: If the information in this manual is not followed exactly, a fire or explosion may result causing property damage, personal injury or loss of life.

WHAT TO DO IF YOU SMELL GAS

- Do not try to light any appliance.
- Do not touch any electrical switch; do not use any phone in your building.
- Immediately call your gas supplier from a neighbor's phone. Follow the gas supplier's instructions.
- If you cannot reach your gas supplier, call the fire department.
- A qualified installer, service agency or the gas supplier must perform installation and service of the Vent-Free gas log heater.
- Do not store or use gasoline or other flammable vapors and liquids in the vicinity of this or any other appliance.

WARNING: Improper installation, adjustment, alteration, service or maintenance can cause injury or property damage. Refer to this manual. For assistance or additional information, consult a qualified installer, service agency or the gas supplier.

Carefully review the instructions supplied with the vent-free log set for the minimum firebox size requirement.

DO NOT INSTALL A VENT-FREE LOG SET IN THIS FIREBOX, UNLESS THIS FIREBOX MEETS THE MINIMUM DIMENSIONS REQUIRED FOR THE INSTALLATION.

TABLE OF CONTENTS

SECTION	PAGE
Important Safety Information.....	3
Introduction	3
Clearances	4
Firebox Installation Instructions.....	4-7
Installing Hood	7
Gas Line Connection	8
Optional Louver Installation Instructions	9
Optional Frame Installation Instructions	9
Optional Fresh Air Kit Installation Instructions for Premium Firebox	10-12
Optional Variable Speed Blower Installation Instructions	13-14
Optional Single Speed Blower Installations Instructions.....	15
Optional Brick Liner Installation Instructions	16
Junction Box Wiring Installation Instructions.....	16
Maintenance	16
Parts List	17
How to Order Repair Parts	17
Parts View.....	18
Accessories.....	19-20

IMPORTANT SAFETY INFORMATION

The installation must conform with local codes or, in the absence of local codes, with the National Fuel Gas Code, ANSI Z223.1 (latest edition) and to the National electrical Code, ANSI/NFPA70 (latest edition).

NOTE: Installation and repair should be done by a qualified service person. The appliance should be inspected before use and at least annually by a qualified service person. More frequent cleaning may be required due to excessive lint from carpeting, bedding material, etc. It is imperative that control compartment, burners and circulating air passageways of the appliance be kept clean.

Any safety screen or guard removed for servicing an appliance must be replaced prior to operating the appliance. Provide adequate combustion and ventilation air.

The flow of combustion and ventilation air **MUST NOT** be obstructed.

Provide adequate clearance around air openings into the combustion chamber and adequate accessibility clearance for servicing and proper operation. **NEVER** obstruct the front opening of the appliance.

This Empire Comfort Systems, Inc. firebox and its components have been tested and will operate safely when installed in accordance with this installation manual. Read all instructions before starting installation, then follow these instructions carefully during installation to maximize firebox benefit and safety. Report to your dealer any parts damaged in shipment.

The Empire Comfort Systems, Inc. warranty will be voided by, and Empire Comfort Systems, Inc. disclaims any responsibility for the following actions:

- Installation of any damaged firebox.
- Modification of the firebox or any of the components parts thereof.

- Installation other than as instructed by Empire Comfort Systems, Inc.
- Installation and/or use of any component part or accessory not approved by Empire Comfort Systems, Inc. in combination or assembly with a Empire Comfort Systems, Inc. firebox, not withstanding any independent testing laboratory or other third party approval of such component part or accessory.

Any such action may create a possible fire hazard. Consult your local building codes.

Firebox Screen.

The firebox screen must be in place when the firebox is operating.

INTRODUCTION

Instructions to Installer

1. Installer must leave instruction manual with owner after installation.
2. Installer must have owner fill out and mail warranty card supplied with firebox.
3. Installer should show owner how to start and operate log set that is installed into firebox.

Important

All correspondence should refer to complete Model Number, Serial Number.

Notice: During initial firing of this firebox with a log set installed, its paint will bake out, and smoke will occur. To prevent triggering of smoke alarms, ventilate the room in which the unit is installed.

Qualified Installing Agency

Installation and replacement of gas piping, gas utilization equipment or accessories and repair and servicing of equipment shall be performed only by a qualified agency. The term "qualified agency" means any individual, firm, corporation or company which either in person or through a representative is engaged in and is responsible for (a) the installation or replacement of gas piping or (b) the connection, installation, repair or servicing of equipment, who is experienced in such work, familiar with all precautions required and has complied with all the requirements of the authority having jurisdiction.

The installation must conform with local codes or, in the absence of local codes, with the National Fuel Gas Code, ANSI Z223.1/NFPA 54.*

*Available from the American National Standards Institute, Inc., 11 West 42nd St., New York, N.Y. 10036.

CLEARANCES

Sidewall Clearances: The clearance from the inside of the firebox to any combustible wall should not be less than 6".

Firebox Side and Back Clearances: The firebox outer casing sides and back have zero clearance to combustibles.

Note: When installing firebox as a covered louvers installation, non-combustible material must be used in front of louvers and in front of top standoffs. See drawing on Page 5.

Ceiling Clearances: The ceiling height should not be less than 42" from the top of the firebox opening.

Mantel Clearances: Vent free firebox models must use the hood supplied with the firebox. If a combustible mantel is installed, it must meet the clearance requirements detailed below.

Grate Clearance: The minimum clearance between the front legs of the grate and front edge of the firebox is 2".

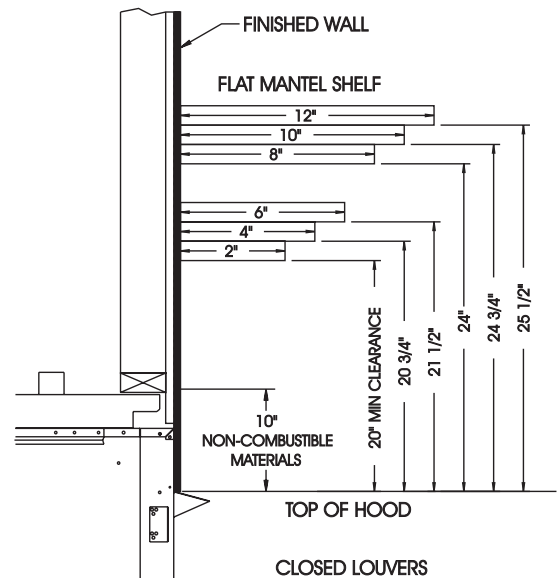
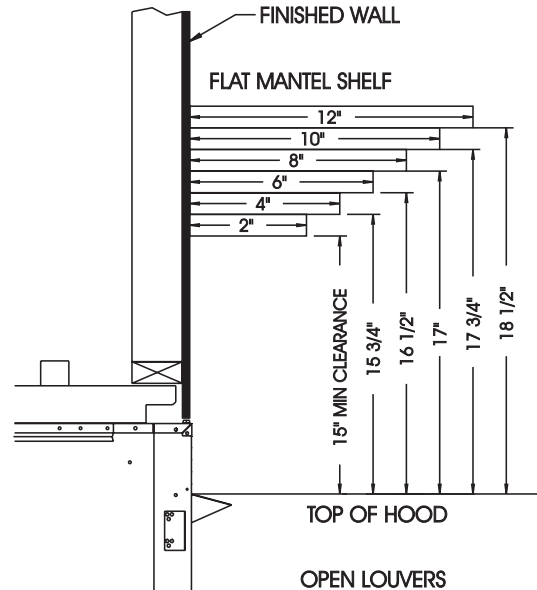
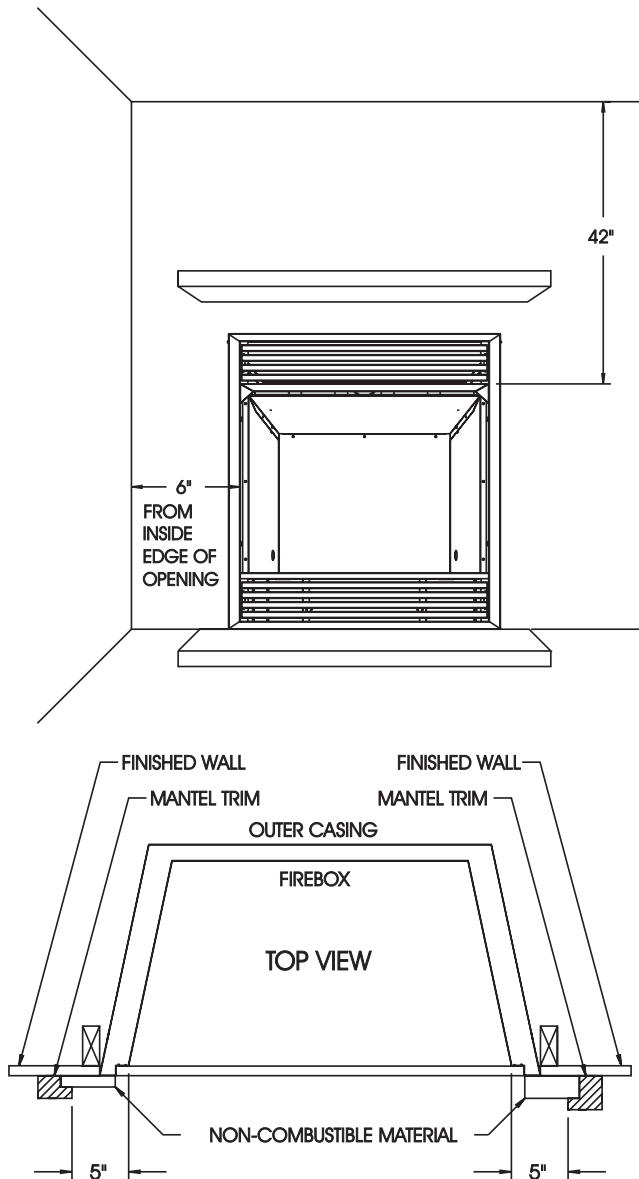

Figure 1
Clearances to combustibles

FIREBOX INSTALLATION INSTRUCTIONS

Any vent-free Gas Log Heater must be "For use with approved ANSI Z21.11.2 Decorative type unvented room heater."

Follow and complete the installation instructions of the gas log set and the requirements of this firebox.

A gas shut off must be in this line.

Check all fittings for leaks before lighting this gas log set.

In planning the installation for the firebox, it is necessary to determine where the unit is to be installed and whether optional accessories are desired. Gas supply piping should also be planned at this time.

The firebox can be mounted on any of these surfaces:

1. A flat hard combustible or non-combustible surface.
2. A raised platform of combustible or non-combustible material.
3. Four (4) corners of the firebox so contact is made on all four perimeter edges on the bottom of the unit. (Example: Four (4) concrete masonry blocks.)

If the firebox is installed directly on carpeting, tile or other combustible material other than wood flooring, it should be installed on a metal or wood panel extending the full width and depth of the unit.

At this point, you should have decided what components to include in your installation, and where the firebox is to be located. If this has not been done, stop and consult your dealer for assistance with this planning.

Firebox Framing

Firebox framing can be built before or after the firebox is set in place. Framing should be positioned to accommodate wall covering and firebox facing material. The firebox framing should be constructed of 2 x 4 lumber or heavier. The framing headers may rest on the top of the firebox standoffs. Refer to Figure 2 and Figure 3 for firebox framing dimensions.

Framing dimension A includes a three inch clearance for standoffs on firebox. After installing firebox into framing, the finished wall surface must cover the three inch opening above the firebox.

Framing Flush Mantel Installation

1. Remove two (2) center screws (that are two inches apart) from each side of firebox for attachment of flush mantel brackets.
2. Attach flush mantel brackets to firebox sides with screws removed in Step 1.

Attention: The clearance hole in flush mantel bracket must face forward for attachment of framing material.

3. Attach framing material around firebox.

Attention: A 1-1/2" exposure on each side of firebox must be maintained for flush mantel installation.

Recessing into Framed Wall Installation

When recessing firebox into framed wall the louvers can either be installed as an open louver installation or the louvers can be covered with a non-combustible material for a covered louver installation. See drawings below.

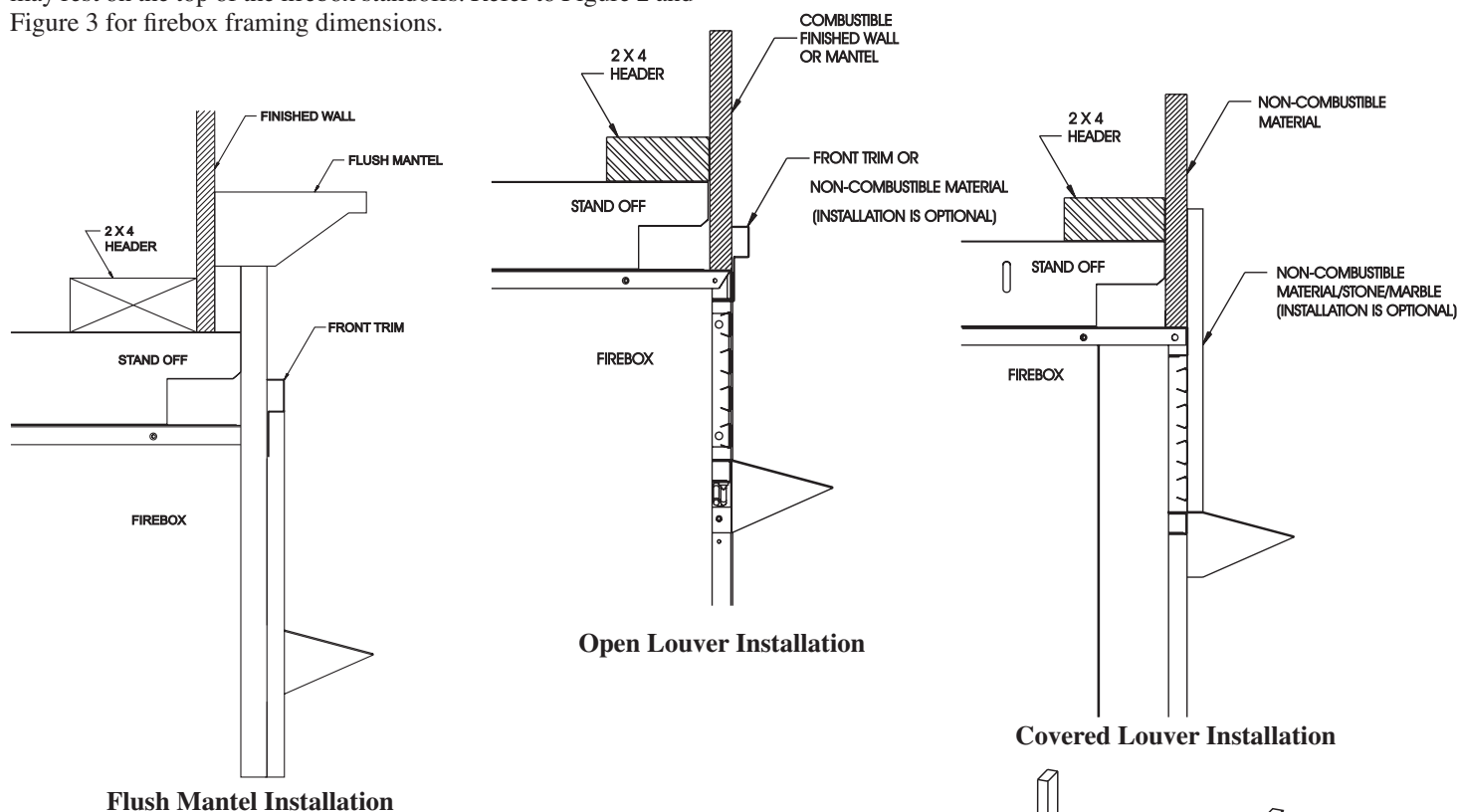

	VFFD-32	VFFD-36	VFFD-42
"A"	37"	39"	41"
"B"	35 3/8"	39 3/8"	45 3/8"
"C"	16 11/16"	20 11/16"	20 11/16"

	VFFP-32	VFFP-36	VFFP-42
"A"	41"	43"	43"
"B"	35 3/8"	39 3/8"	45 3/8"
"C"	20 11/16"	20 11/16"	20 11/16"

Attention: Add 3-3/4" to "A" Dimension when using flush mantel base.

Figure 2
Framing Dimensions

FIREBOX INSTALLATION INSTRUCTIONS (continued)

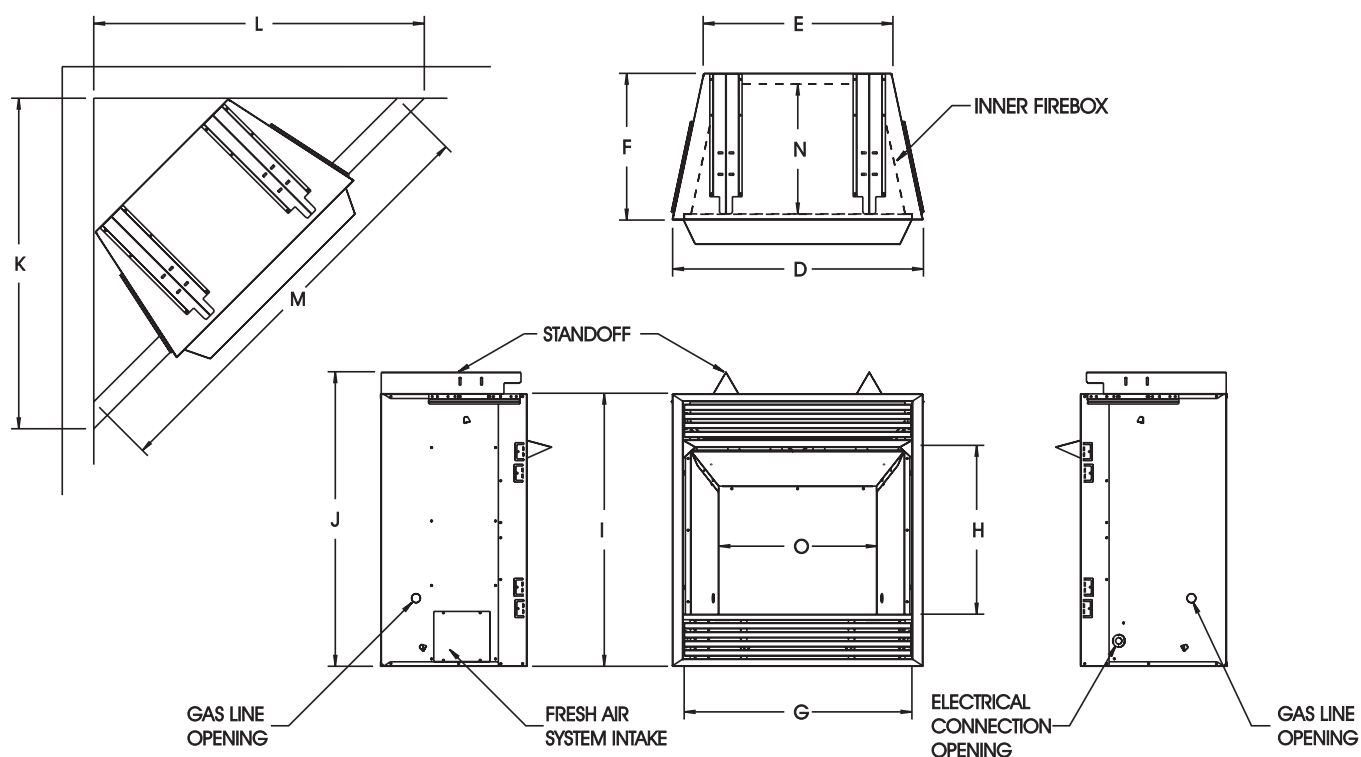

	VFFD-32	VFFP-32	VFFD-36	VFFP-36	VFFD-42	VFFP-42
D	35"	35"	39"	39"	45"	45"
E	28"	26 1/4"	30 1/4"	30 1/4"	36 1/4"	36 1/4"
F	16 1/2"	20 1/2"	20 1/2"	20 1/2"	20 1/2"	20 1/2"
G	32"	32"	36"	36"	42"	42"
H	20 1/4"	24 1/4"	22 1/4"	26 1/4"	24 1/4"	26 1/4"
I	34"	38"	36"	40"	38"	40"
J	37"	41"	39"	43"	41"	43"
K	42 5/16"	46 3/4"	49 5/8"	49 5/8"	53 7/8"	53 7/8"
L	42 5/16"	46 3/4"	49 5/8"	49 5/8"	53 7/8"	53 7/8"
M	52 7/8"	59 1/8"	63 1/8"	63 1/8"	69 1/8"	69 1/8"
N	14"	18"	18"	18"	18"	18"
O	23 3/4"	22"	26"	26"	32"	32"

Figure 3
Firebox Dimensions

FIREBOX INSTALLATION INSTRUCTIONS (continued)

Locating Firebox

Place firebox in framing opening. Use the four (4) nailing tabs provided on the firebox to attach firebox to framing. Additional hole locations will be used for different finishing material with thicknesses of 1/2", 5/8" and 3/4". Attach these materials with screws provided, two (2) per nailing tab.

Nailing tabs should fit directly against framing material. Use at least one (1) nail per tab to secure in place.

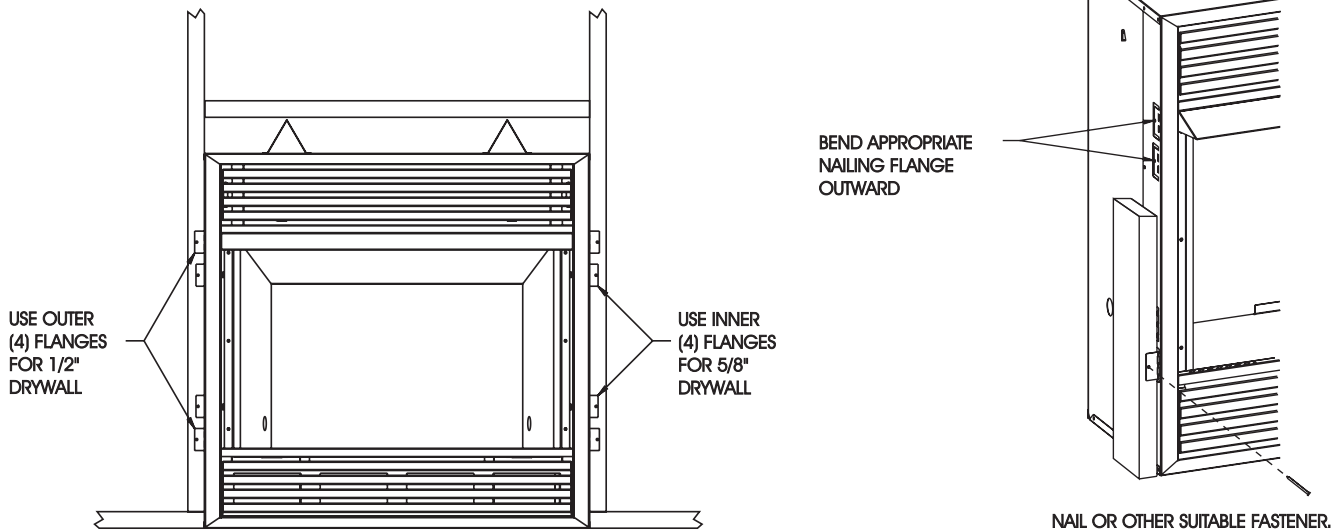

Figure 4
Fasten firebox in place with tabs.

INSTALLING HOOD

A black hood is furnished with each firebox and **MUST** be installed before the firebox is used. Failure to do so may create a possible fire hazard. If brass, stainless steel or gloss black hoods are desired, they can be purchased as an option. Attachment is the same, as our standard black hood.

1. Install one top screw and one screw for each side of the firebox surround. Be careful not to remove the screen rod from the firebox, during this procedure.
2. Line up the holes with holes in hood being installed. Insert screws and tighten securely.

Extended Hoods

If your facing material over 1" in thickness is used to finish this firebox, you must purchase a different hood that will extend out 2" farther into the room. Follow steps 1 and 2 above for installation. Contact your local dealer for details.

Finishing

All joints (top, bottom and sides), where the wall or decorative facing material meets the firebox surround must be completely sealed with a non-combustible material. Refer to Figure 1.

Hearth extensions are recommended, not a requirement for these fireboxes.

Attention: The top and bottom louvers can be covered with non-combustible material.

32" Hoods

VF4H2A-32BL
VF4H2A-32BR
VF4H2A-32BP
VF4H2A-32SS

36" Hoods

VF4H2A-36BL
VF4H2A-36BR
VF4H2A-36BP
VF4H2A-36SS

42" Hoods

VF4H2A-42BL
VF4H2A-42BR
VF4H2A-42BP
VF4H2A-42SS

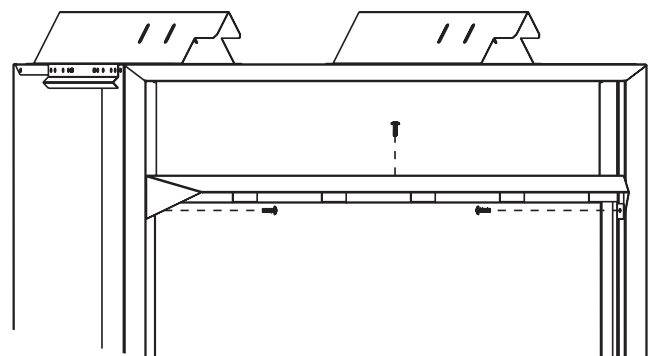

Figure 5
Installation of Hood

GAS LINE CONNECTION

The firebox is designed to accept a 3/8-inch gas line for an approved gas firebox. Have the line installed by a qualified service person in accordance with all building codes. Consult local building codes to properly size the gas supply line leading to the 3/8-inch hook-up at the unit.

Gas access holes are provided on both sides of the firebox. Use a small hammer to remove knockouts in the inner and outer cabinets. On "L" models with refractory brick panel installed, remove the knockout in the refractory brick panel and in the outer cabinet. The knockout in the inner cabinet has been removed. When installing optional ceramic side panel into firebox, lay panel on a flat surface. Remove the knockout in the appropriate side panel from the finish side down. Flex line should be used, if approved by local codes, when the line is being installed in the left side of the firebox. Hard plumbing could get in the way of the air dilution system on the Premium firebox.

Check gas type. Use only the gas type indicated on the gas log set rating plate. If the gas listed on the plate is not your type of gas supply, DO NOT INSTALL. Contact your dealer for proper model.

Always use an external regulator for all LP fireboxes to reduce the supply tank pressure to a maximum of 13" w.c. This is in addition to the regulator fitted to the log set.

WARNING: CONNECTION DIRECTLY TO AN UNREGULATED L.P. TANK CAN CAUSE EXPLOSION.

Install only a ANSI Z21.11.2 vent-free log set into this firebox.

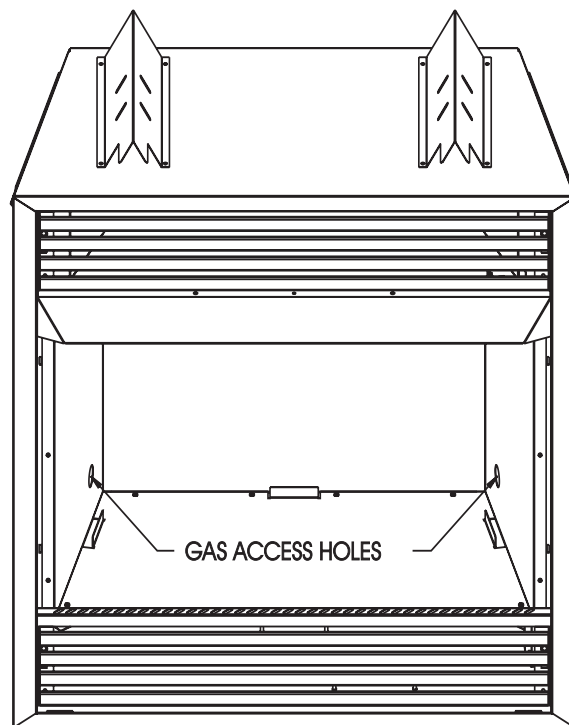

Figure 6

OPTIONAL LOUVER INSTALLATION INSTRUCTIONS

32" Louvers

FBL2A-32BR
FBL2A-32BP
FBL2A-32SS

36" Louvers

FBL2A-36BR
FBL2A-36BP
FBL2A-36SS

42" Louvers

FBL2A-42BR
FBL2A-42BP
FBL2A-42SS

Attention: Remove protective film on brass and stainless steel louvers before installation.

Attention: Wear gloves when handling louver.

1. Remove top louver from firebox.
2. Remove louver brackets from louvers.
3. Insert four (4) optional louvers into louver brackets.
4. Replace top louver into firebox.
5. Repeat Steps 1 through 4 to install optional louvers into bottom louver.

OPTIONAL FRAME INSTALLATION INSTRUCTIONS

Frames for Deluxe Fireboxes

32" Frames

VFF2A-32SBL
VFF2A-32SBR
VFF2A-32SBP
VFF2A-32SSS

36" Frames

VFF2A-36SBL
VFF2A-36SBR
VFF2A-36SBP
VFF2A-36SSS

42" Frames

VFF2A-42SBL
VFF2A-42SBR
VFF2A-42SBP
VFF2A-42SSS

Frames for Premium Fireboxes

32" Frames

VFF2A-32TBL
VFF2A-32TBR
VFF2A-32TBP
VFF2A-32TSS

36" Frames

VFF2A-36TBL
VFF2A-36TBR
VFF2A-36TBP
VFF2A-36TSS

42" Frames

VFF2A-42TBL
VFF2A-42TBR
VFF2A-42TBP
VFF2A-42TSS

Attention: Remove protective film from brass and stainless steel frames before installing.

Attention: Wear gloves when handling frames.

1. Remove top louver from firebox.
2. Remove bottom louver from firebox.
3. If installed, remove three (3) 3/8 Phillips screws from hood and remove hood from firebox.
4. Remove two (2) 3/8 Phillips screws from interior, top of firebox. **Attention:** Do not remove the middle 3/8 Phillips screw from interior, top of firebox.
5. Insert frame side, left into firebox. Use two (2) 3/8 Phillips screws to attach frame side, left to firebox. Use clearance hole located directly above the lower notch and clearance hole located directly below the upper notch in frame side, left for attachment.
6. Repeat Step 5 to attach frame side, right to firebox.
7. Align slot in frame top with middle 3/8 Phillips screw located in interior, top of firebox. Insert frame top into firebox with slot in frame top located behind middle 3/8 Phillips screw.
8. Use two (2) 3/8 Phillips screws removed in Step 4 to attach frame top to firebox.
9. If applicable, use three (3) 3/8 Phillips screws removed in Step 3 to attach hood to firebox.
10. Replace bottom louver onto firebox.
11. Replace top louver onto firebox.
12. Installation of optional frame is completed.

OPTIONAL FRESH AIR KIT INSTALLATION INSTRUCTIONS FOR PREMIUM FIREBOXES

VBA2A Air Dilution Kit for Premium Fireboxes

Models: VFFP-32(L), VFFP-36(L), VFFP-42(L)

Installation of our 6" fresh air kit is simple and easy to complete. This system **MUST BE** installed before the firebox is enclosed with finishing material.

The air will be drawn into the cooling layer of the firebox and be completely separated from the combustion casing of the vent-free firebox.

Cooler outside air will mix with room air, circulating around the firebox to reduce the heat output and bring heated, fresh air into the house to provide a more positive balance.

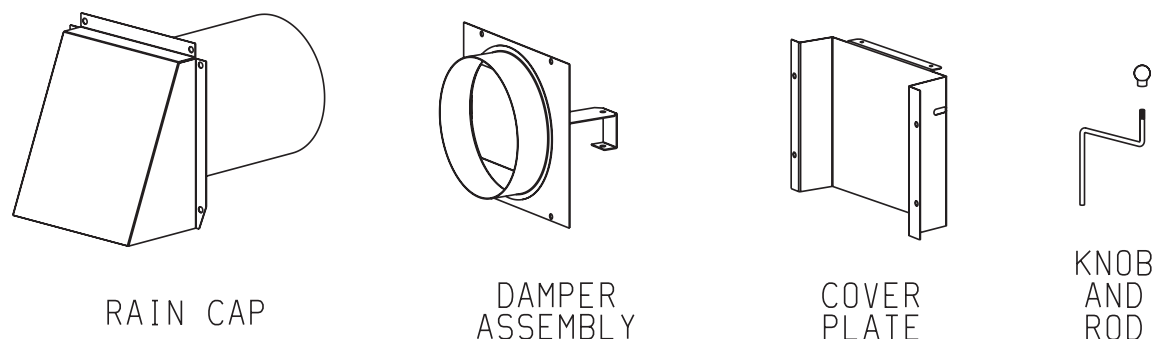

Figure 7
Fresh Air Intake Kit

1. Remove hearth pan from firebox and retain six (6) 10 x 1/2 screws.
2. Remove cover plate from exterior of firebox and retain four (4) 10 x 1/2 screws (See Figure 8).
3. Install damper assembly where the cover plate had been installed on exterior of firebox. Use four (4) 10 x 1/2 screws from Step 2 (See Figure 9).
4. Insert smooth end of damper rod into horizontal slot on inner cover plate.
5. Open door on damper assembly and insert smooth end of damper rod into two clearance holes in tab on damper assembly.
6. Attach inner cover plate to air duct with four (4) 10 x 1/2 screws provided in hardware package.
7. Replace and attach hearth pan to firebox with six (6) 10 x 1/2 screws from Step 1. Use two (2) additional 10 x 1/2 screws provided in hardware package to attach hearth pan to inner cover plate.
8. Thread damper knob onto damper rod.
9. To close damper assembly push in damper knob and lock into place (See Figure 9).
10. To open damper assembly pull out damper knob and lock into place (See Figure 9).
11. Refer to Figure 11 for options available for installation of 6" diameter duct. The duct run can be a maximum length of 40 feet. Insulated duct is recommended when ducting through a heated space. Note: 6" C vent or 6" flex vent can be used.
12. Cut a 6-1/8" diameter hole in structure after determining duct termination (rain cap) location.
13. Caulk exterior of structure that will be contacted by outside air tube (See Figure 11).
14. Insert outside air tube into 6-1/8" diameter hole in structure. Align clearance holes on rain cap with clearance holes on outside air termination plate. Attach rain cap and outside air termination plate to structure with (6) 1-1/2" provided screws.
15. Attach 6" diameter duct to 1-1/2" collar on damper assembly.
16. Route 6" diameter duct to outside air tube.
17. Attach 6" diameter duct to outside air tube.
18. Installation of fresh air kit is completed.

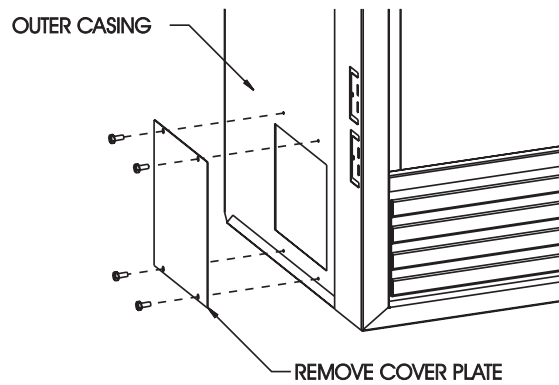

Figure 8

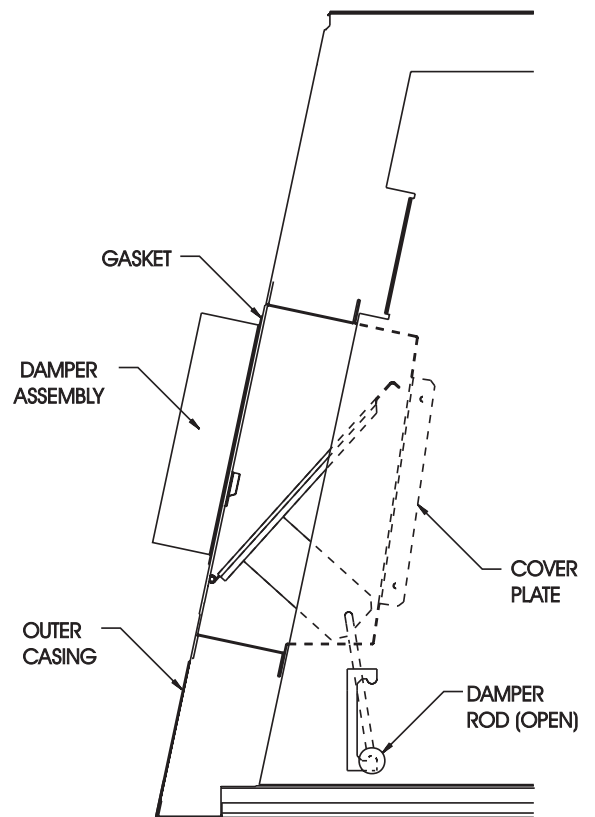
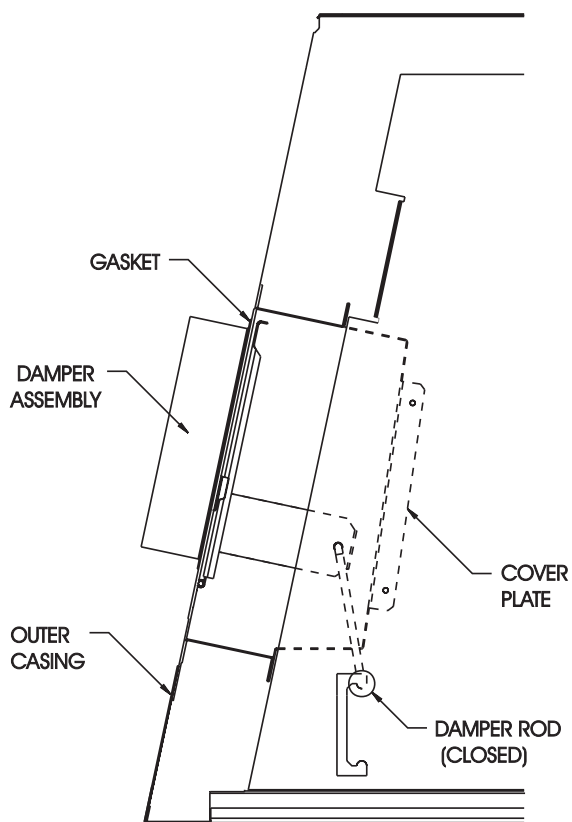

Figure 9
Top View of Air System Installation

OPTIONAL FRESH AIR KIT INSTALLATION INSTRUCTIONS FOR PREMIUM FIREBOXES (continued)

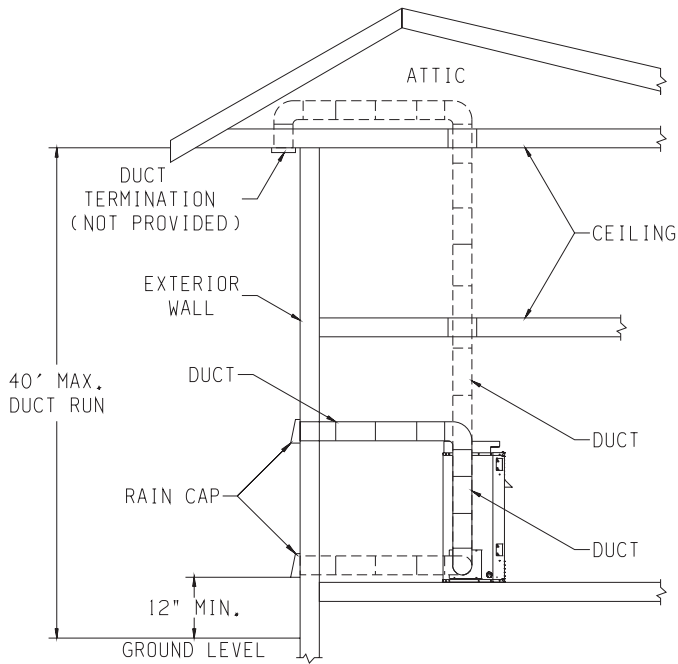

Figure 10
Example of Installation

Parts List

Part Description	Part Number	Quantity Supplied
Damper Assembly	14416	1
Cover Plate	14390	1
Rain Cap	10124	1
Outside Air Termination Assembly	10147	1
Damper Rod	R-7194	1
Knob	R-5015	1
10 x 1/2" Screw	R-2737	6
10 x 1-1/2" Screw	R-1134	6

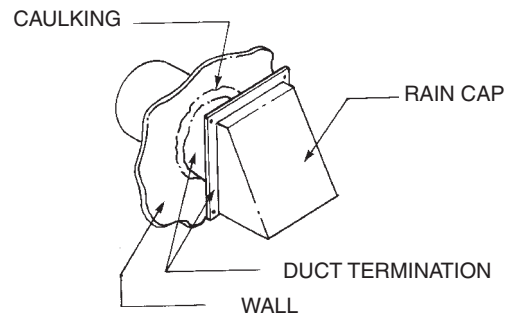

Figure 11
Caulk and Install Duct Termination

NO ELBOWS USED ON AIR DILLUTION KIT

WHEN 90 ° OR 45 ° ELBOWS ARE USED ON AIR DILLUTION KIT

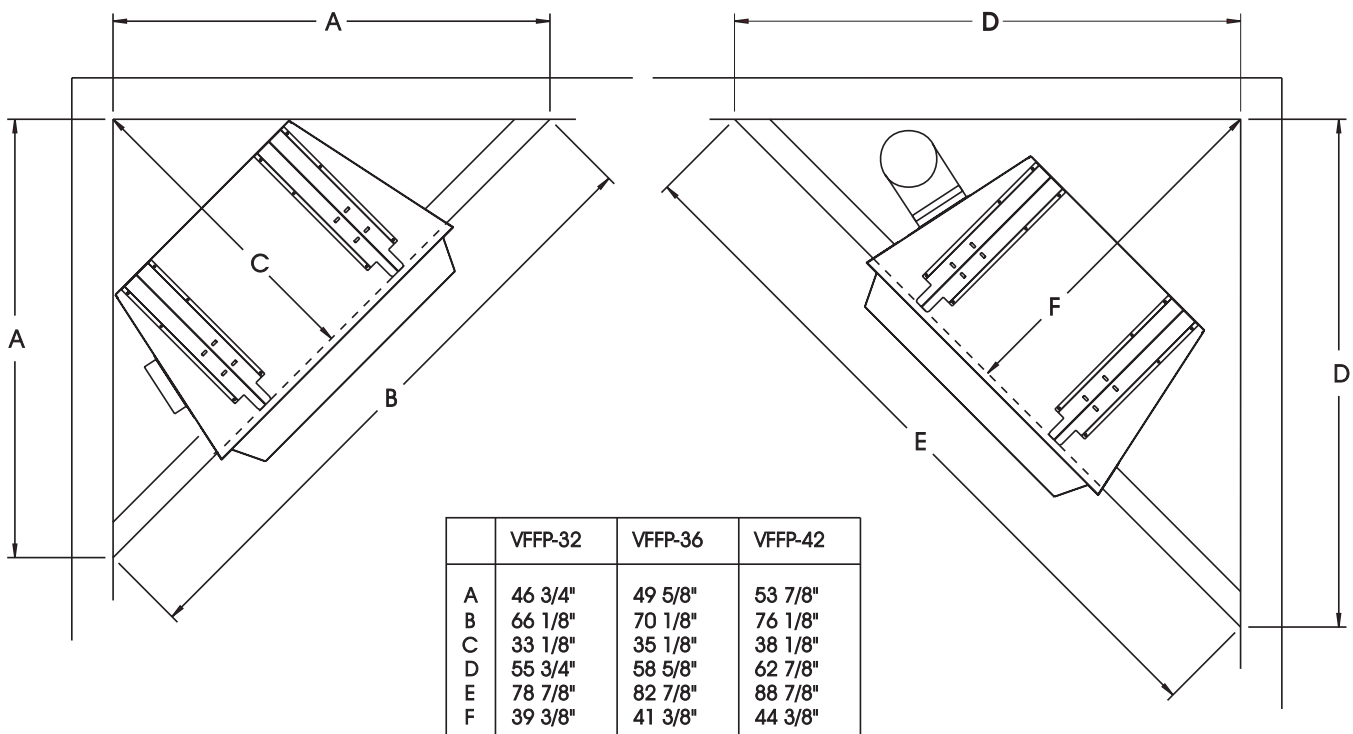

Figure 12

OPTIONAL VARIABLE SPEED BLOWER INSTALLATION INSTRUCTIONS

FBF3A Blower Installation

1. If applicable, turn OFF electric supply to firebox.
2. Remove bottom louver.
3. Refer to page 16, Junction Box Wiring Installation Instructions to complete wiring of junction box.
4. Centered in the rear are two (2) weld studs which protrude upward into the bottom of firebox for attachment of fan.
5. Insert fan into interior, bottom of firebox. The clearance holes on fan mounting bracket must be facing toward the front of firebox. Do not damage gas inlet supply line when fan is inserted into firebox.
6. Align and place front set of clearance holes on fan mounting bracket onto two (2) weld studs.
7. Use two (2) wing nuts to attach blower to weld studs.
8. Located in the right, front are two (2) weld studs which protrude upward into the bottom of firebox for attachment of speed control.
9. Insert speed control into interior, bottom of firebox. Align and place two (2) clearance holes on speed control onto two (2) weld studs.
10. Use two (2) wing nuts to attach speed control to weld studs.
11. To remove top louver grasp louver and pull forward.
12. Refer to Figure 13 for mounting hole location on right side of firebox top. Measure from front edge of firebox top to determine mounting hole location. Remove appropriate screw from firebox top.
13. Refer to Figure 14 for fan control bracket location. Align clearance hole on fan control bracket with screw hole on firebox top. Attach fan control bracket to firebox top with one (1) screw from Step 12.
14. Route fan control wires between the inner casing and outer casing.
15. Connect fan control wires to speed control wires.
16. Plug speed control electric cord into junction box on the right side of firebox.
17. Replace top louver.
18. Replace bottom louver.
19. Installation of FBF3A blower is completed.

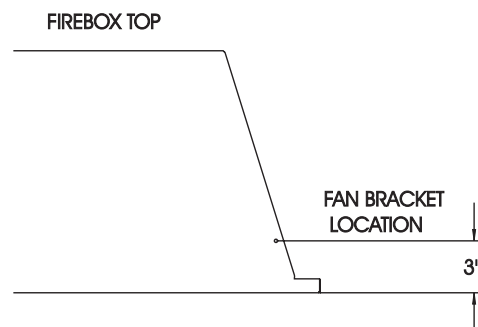

Figure 13

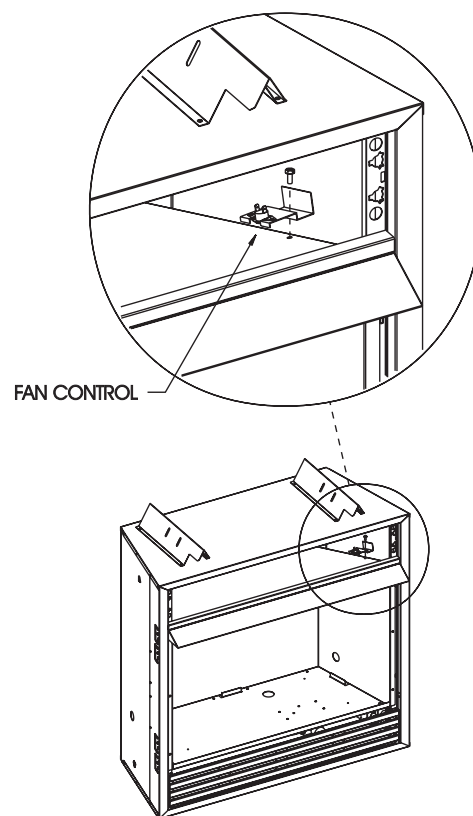

Figure 14

OPTIONAL VARIABLE SPEED BLOWER INSTALLATION INSTRUCTIONS (continued)

Wiring

The appliance, when installed, must be electrically grounded in accordance with local codes or, in the absence of local codes, with the *National Electrical Code, ANSI/NFPA 70*, if an external electrical source is utilized. **This appliance is equipped with a three-prong [grounding] plug for your protection against shock hazard and should be plugged directly into a properly grounded three-prong receptacle. Do not cut or remove the grounding prong from this plug.** For an ungrounded receptacle, an adapter, which has two prongs and a wire for grounding, can be purchased, plugged into the ungrounded receptacle and its wire connected to the receptacle mounting screw. With this wire completing the ground, the appliance cord plug can be plugged into the adapter and be electrically grounded.

CAUTION: Label all wires prior to disconnection when servicing controls. Wiring errors can cause improper and dangerous operation. Verify proper operation after servicing.

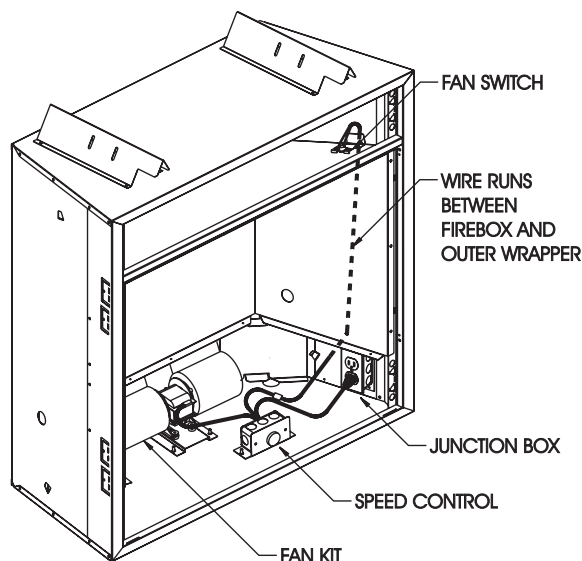

Figure 15

INDEX NO.	PART NO.	DESCRIPTION
1	R-4190	BLOWER ASSEMBLY
2	14050	FAN CONTROL BRACKET
3	R-2503	FAN CONTROL
4	R-5101	WIRE HARNESS
5	R-5298	WIRE ASSEMBLY
6	R-3490	JUNCTION BOX
7	10088	RHEOSTAT BOX BRACKET
8	R-4192	RHEOSTAT KNOB
9	R-4186	RHEOSTAT
10	R-4193	CORD SET
11	10849	BLOWER SUPPORT
NS	10146	BLOWER GASKET (2 REQUIRED)
NS	R-1410	STRAIN RELIEF BUSHING
NS	R-1720	CABLE CLIP

Blower Motor

The blower motor does not have oiling holes. Do not attempt to oil the blower motor.

Blower Wheels

The blower wheels will collect lint and could require periodic cleaning. If the air output decreases or the noise level increases, it indicates a dirty blower wheel. Remove blower and clean blower wheels.

WARNING:

Unplugging of blower accessory will not stop the heater from cycling. To turn off gas to the unvented heater: Push in gas control knob slightly and turn clockwise to "OFF." Do not force.

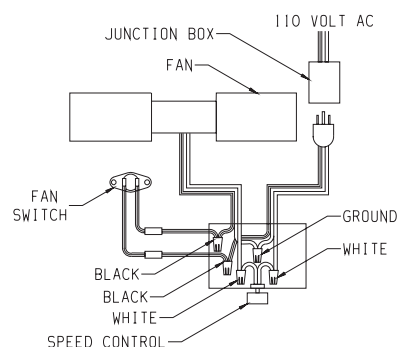

Figure 16

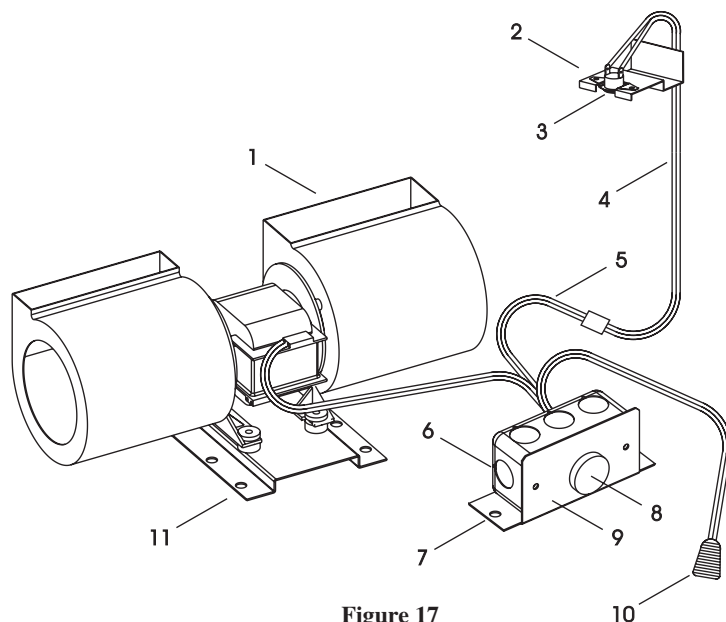

Figure 17

OPTIONAL SINGLE SPEED BLOWER INSTALLATION INSTRUCTIONS

FBB2A Blower Installation

1. If applicable, turn OFF electric supply to firebox.
2. Remove bottom louver.
3. Refer to page 16 Junction Box Wiring Installation Instructions to complete wiring of junction box.
4. Install a wall switch to turn blower ON or OFF. Route wires to junction box.
5. Place blower assembly into bottom of firebox.
6. Insert blower support into mounting tabs and onto weld studs on firebox bottom. Attach two (2) wing nuts onto weld studs.
7. Attach cord set wires to blower assembly wires.
8. Plug cord set into junction box.
9. Replace bottom louver.
10. Installation of FBB2A blower is completed.

INDEX NO.	PART NO.	DESCRIPTION
1	11935	BLOWER DIVERTOR
2	R-6458	CORD SET
3	11932	BLOWER SUPPORT
4	R-6440	BLOWER ASSEMBLY
NS	10146	BLOWER GASKET (2 REQUIRED)
NS	R-1720	CABLE CLIP
NS	R-1499	GROMMETS (3 REQUIRED)
NS	R-1454	BUSHING (3 REQUIRED)

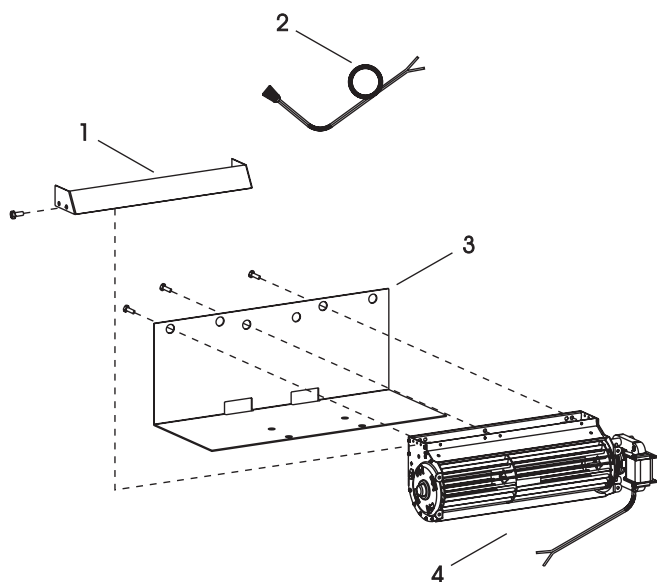

Figure 18

Wiring

The appliance, when installed, must be electrically grounded in accordance with local codes or, in the absence of local codes, with the *National Electrical Code ANSI/NFPA No. 70*, if an external electrical source is utilized. **This appliance is equipped with a three-prong [grounding] plug for your protection against shock hazard and should be plugged directly into a properly grounded three-prong receptacle. Do not cut or remove the grounding prong from this plug.** For an ungrounded receptacle, an adapter, which has two prongs and a wire for grounding, can be purchased, plugged into the ungrounded receptacle and its wire connected to the receptacle mounting screw. With this wire completing the ground, the appliance cord plug can be plugged into the adapter and be electrically grounded.

CAUTION: Label all wires prior to disconnection when servicing controls. Wiring errors can cause improper and dangerous operation. Verify proper operation after servicing.

Blower Motor

The blower motor does not have oiling holes. Do not attempt to oil the blower motor.

Blower Wheels

The blower wheels will collect lint and could require periodic cleaning. If the air output decreases or the noise level increases, it indicates a dirty blower wheel. Remove blower and clean blower wheels.

WARNING:

Unplugging of blower accessory will not stop the heater from cycling. To turn off gas to the unvented heater: Push in gas control knob slightly and turn clockwise to "OFF." Do not force.

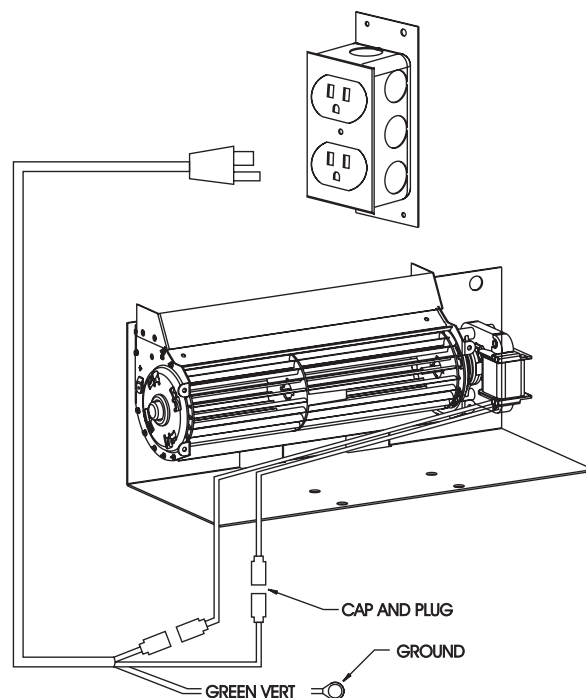

Figure 19

OPTIONAL BRICK LINER INSTALLATION INSTRUCTIONS

1. Remove logs and burner from firebox.
2. Remove knockout from brick liner (right or left) for gas line.
3. Insert back panel into firebox.
4. Insert one (1) side panel into firebox.
5. Use one (1) brick panel bracket to secure side pane. Align clearance hole on brick panel bracket with screw hole in the left or right interior, top of firebox. Use one (1) 10 x 1/2" Phillips screw to attach brick panel bracket to interior, top of firebox.
6. Repeat Steps 4 and 5 to install second side panel.
7. Replace logs and burner into firebox.
8. Installation of optional brick liner is completed.

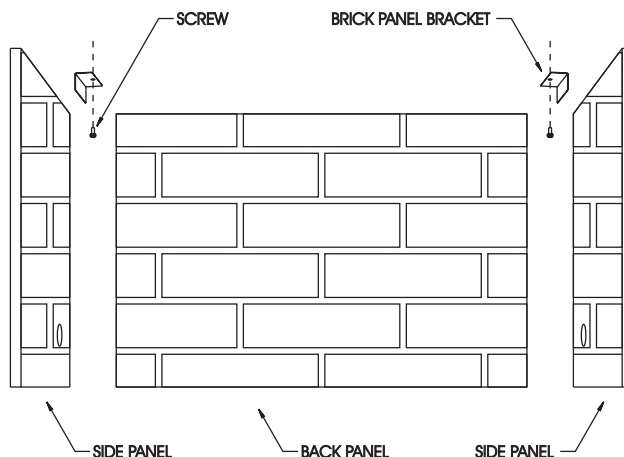

Figure 20
Installation of brick liner

Part Name	VFP2A-32SSA Part No.	VFP2A-32TDA Part No.	VFP2A-36TDA Part No.	VFP2A-42TDA Part No.	VFP2A-36SDA Part No.	VFP2A-42SDA Part No.
Brick Panel Side - Left	R-7082	R-7122	R-7128	R-7128	R-7118	R-7122
Brick Panel Side - Right	R-7083	R-7123	R-7129	R-7129	R-7119	R-7123
Brick Panel Back	R-7084	R-7126	R-7130	R-7132	R-7120	R-7124
Brick Panel Bracket (2 Required)	13958	3958	13958	13958	13958	13958
10 x 1/2" Phillips Screw (2 Required)	R-2737	R-2737	R-2737	R-2737	R-2737	R-2737

JUNCTION BOX WIRING INSTALLATION INSTRUCTIONS

CAUTION: ALL WIRING SHOULD BE DONE BY A QUALIFIED ELECTRICIAN AND SHALL BE IN COMPLIANCE WITH ALL LOCAL, CITY AND STATE BUILDING CODES. BEFORE MAKING THE ELECTRICAL CONNECTION, MAKE SURE THAT MAIN POWER SUPPLY IS DISCONNECTED. THE APPLIANCE, WHEN INSTALLED, MUST BE ELECTRICALLY GROUNDED IN ACCORDANCE WITH LOCAL CODES OR, IN THE ABSENCE OF LOCAL CODES, WITH THE NATIONAL ELECTRICAL CODE ANSI/NFPA 70 (LATEST EDITION)

A factory installed junction box is located on the lower right hand side of the firebox. Wiring must be fed to the junction box and attached to the receptacle that is provided. Remove the knockout in the installed junction box to accept wiring into the junction box. Install a UL listed cable clamp (not supplied) in the knockout hole. Leave approximately 6" of wire in the junction box for connection.

Attach black wire to one side of the receptacle and white wire to opposite side of receptacle. The ground wire should be attached to the green (neutral) screw.

Install the receptacle into the junction box. Attach cover plate.

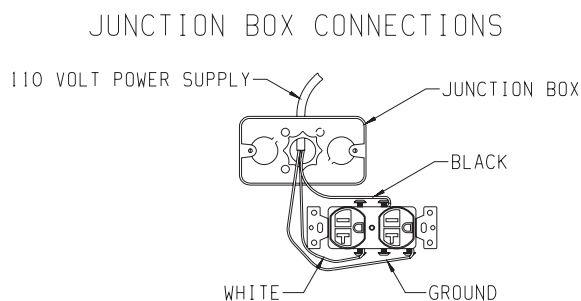

Figure 21

MAINTENANCE

Keep the control compartment, logs and burner area surrounding the logs clean by vacuuming or brushing area at least twice a year.

THE LOGS CAN GET VERY HOT – HANDLE ONLY WHEN COOL.

Always turn off gas to the pilot before cleaning. For relighting, refer to lighting instructions located on the rating plate of the log set.

Never obstruct the flow of the combustion and ventilation air. Keep the front of the firebox clear of all obstacles and materials.

Leave at least 36" clearance from the front of the firebox.

Screens should be closed during operation.

PARTS LIST

INDEX

NO.	DESCRIPTION	VFFD-32(L)-1	VFFP-32(L)-1	VFFD-36(L)-1	VFFP-36(L)-1	VFFD-42(L)-1	VFFP-42(L)-1
1	TOP STANDOFF	11520	11450	11450	11450	11450	11450
2	OUTER WRAPPER TOP	13948	13964	13985	13985	13996	13996
3	TOP HEAT SHIELD	13950	13966	13986	13986	13997	13997
4	LOUVER BRACKET ASSEMBLY W/CLIP	14169	14169	14169	14169	14169	14169
5	LOUVER	14019	14019	13981	13981	14003	14003
6	STANDOFF BRACKET	14124	14124	14124	14124	14124	14124
7	OUTER WRAPPER SIDES & BACK	13947	13963	13984	13991	13995	14004
8	OUTER WRAPPER FRONT POST	16292	16294	16293	13992	16294	13992
9	JUNCTION BOX COVER	R-3491	R-3491	R-3491	R-3491	R-3491	R-3491
10	RECEPTICAL	R-3492	R-3492	R-3492	R-3492	R-3492	R-3492
11	JUNCTION BOX ASSEMBLY	10054	10054	10054	10054	10054	10054
12	OUTER WRAPPER BOTTOM ASSEMBLY	14043	14044	14045	14045	14046	14046
13	FIREBOX SUPPORT	13951	13951	13951	13951	13951	13951
14	FIREBOX BOTTOM	16486	16487	16488	16488	16489	16489
15	INNER FIREBOX ASSEMBLY	14168	14185	14175	14189	14179	14193
16	AIR DILLUTION DUCT	N/A	14156	N/A	14157	N/A	14157
17	SCREEN CURTAIN	R-7054	R-7055	R-4143	R-7056	R-4146	R-7057
18	SCREEN ROD	R-7051	R-7051	R-7052	R-7052	R-7053	R-7053
19	HOOD	13956	13956	13980	13980	14002	14002
20	FIREBOX TOP	13952	13967	13987	13987	13998	13998
NS	AIR DILLUTION COVER PLATE	N/A	14181	N/A	14181	N/A	14181
NS	SCREEN TOOL	R-4159	R-4159	R-4159	R-4159	R-4159	R-4159
NS	REFRACTORY LINER BACK (L)	R-7040	R-7037	R-7043	R-7046	R-7049	R-7050
NS	REFRACTORY LINER RIGHT(L)	R-7041	R-7038	R-7044	R-7047	R-7038	R-7047
NS	REFRACTORY LINER LEFT (L)	R-7042	R-7039	R-7045	R-7048	R-7039	R-7048

HOW TO ORDER REPAIR PARTS

Parts can be ordered **only** through your **service person or dealer**. For best results, the **service person or dealer** should order parts through the distributor. Parts can be shipped directly to the **service person/dealer**.

All parts listed in the Parts List have a Part Number. When ordering parts, first obtain the Model Number from the name plate on your equipment. Then determine the Part Number (**not** the Index Number) and the Description of each part from the following appropriate illustration and list. Be sure to give all this information . . .

Firebox Model Number _____ Part Description _____

Firebox Serial Number _____ Part Number _____

Do not order bolts, screws, washers or nuts. They are standard hardware items and can be purchased at any local hardware store.

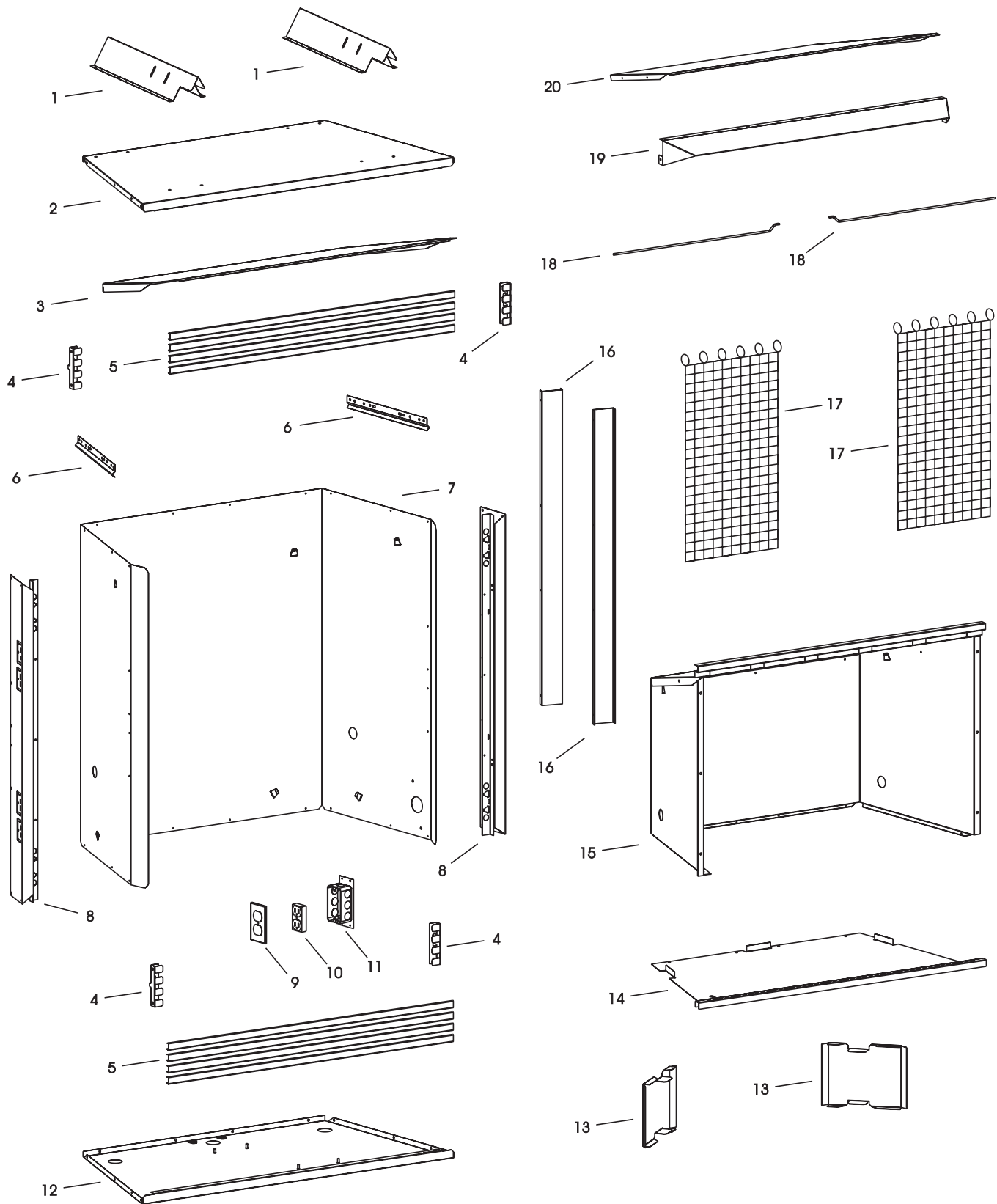

Shipments contingent upon strikes, fires and all causes beyond our control.

PARTS VIEW

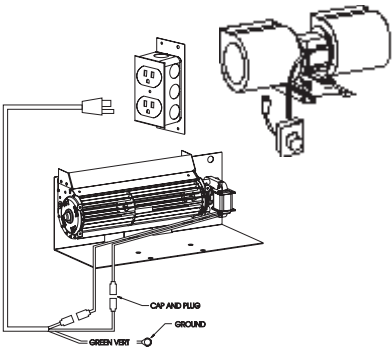
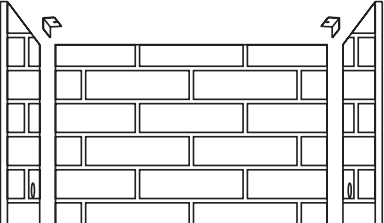
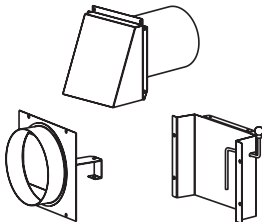
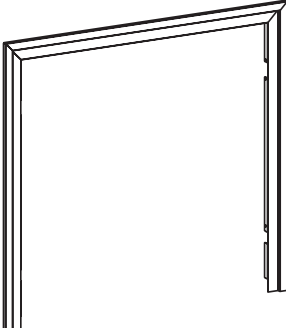

ACCESSORIES

The following accessory parts can be obtained from your Empire Comfort Systems, dealer. Should you need additional information beyond what your dealer can furnish, contact Empire Comfort Systems, Inc., Nine Eighteen Freeburg Ave., Belleville, Illinois 62220-2623

Accessory	Description	Model Numbers
Fan Kit 	Designed to provide forced air flow.	Variable Speed FBB3A-1
	Attention: The variable speed, FBB3A-1 cannot be installed when the top and bottom louvers on the firebox are covered with non-combustible material.	Single Speed FBB2A-1
Brick Liner 	Deluxe Firebox	VFP2A-32SSA VFP2A-36SDA VFP2A-42SDA
	Premium Firebox	VFP2A-32TDA VFP2A-36TDA VFP2A-42TDA
Fresh Air Kit 	Premium Firebox only	VBA2A
Frame Kit 	2-1/2" frame kit for finishing of the firebox, in place of brick, marble or any other finishing materials.	<div> For Deluxe Firebox </div>
	Frame — Black = BL Frame — Brass = BR Frame — Black Porcelain = BP Frame — Stainless Steel = SS	<div> For Premium Firebox </div>
Standard Hood 	Brass hood = BR Black porcelain hood = BP Stainless Steel = SS	VF2H2A-32BR VF2H2A-32BP VF2H2A-32SS VF2H2A-36BR VF2H2A-36BP VF2H2A-36SS VF2H2A-42BR VF2H2A-42BP VF2H2A-42SS

ACCESSORIES (continued)

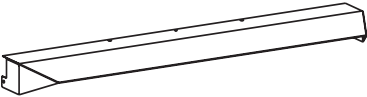
<p>Extended Hood</p> 	<p>Black Extended Hood for stone or brick facing material</p> <p>Brass Extended Hood for stone or brick facing materia</p> <p>Black Porcelain Extended Hood for stone or brick facing material</p> <p>Stainless Steel Extended Hood for stone or brick facing material</p>	<p>VF4H2A-32BL VF4H2A-32BR VF4H2A-32BP VF4H2A-32SS VF4H2A-36BL VF4H2A-36BR VF4H2A-36BP VF4H2A-36SS VF4H2A-42BL VF4H2A-42BR VF4H2A-42BP VF4H2A-42SS</p>
<p>Louvers</p>	<p>Brass Louvers = BR</p> <p>Black Porcelain Louvers = BP</p> <p>Stainless Steel Louvers = SS</p>	<p>FBL2A-32BR FBL2A-32BP FBL2A-32SS FBL2A-36BR FBL2A-36BP FBL2A-36SS FBL2A-42BR FBL2A-42BP FBL2A-42SS</p>
<p>Lower Louver Pivot Conversion</p>	<p>For easy access with use of FBB3A-1 blower</p>	<p>VBD2A-32 VBD2A-36 VBD2A-42</p>



Empire Comfort Systems, Inc.
Nine Eighteen Freeburg Ave.
Belleville, Illinois 62220-2623

PH: 800-851-3153
FAX: 800-443-8648
E-MAIL: info@empirecomfort.com
WEB SITE: www.empirecomfort.com