

Installation Instructions

Model Number IDV33-IDV36 Gas Fired Direct Vent Room Heater Inserts

Model IDV33 Listed Certified for USA. and Canada
Minimum Fireplace Opening Required: 26-1/4"W x 21-3/8"H x 14-3/8"D
Certified to: ANSI Z21.88-2009, CSA 2.33-2009, CGA 2.17-M91

Model IDV36 Listed Certified for USA. and Canada
Minimum Fireplace Opening Required: 30-3/4"W x 25-5/8"H x 14-3/8"D
Certified to: ANSI Z21.88-2009, CSA 2.33-2009, CGA 2.17-M91



INSTALLER: Leave this manual with the appliance.
CONSUMER: Retain this manual for future reference.

This appliance may be installed in an aftermarket permanently located, manufactured home (USA only) or mobile home, where not prohibited by local codes.
This appliance is only for use with the type of gas indicated on the rating plate. This appliance is not convertible for use with other gases, unless a certified kit is used.

**Read this complete manual before beginning installation.
These instructions must be kept with the unit for future reference.**

FOR YOUR SAFETY

⚠ WARNING: If the information in these instructions is not followed exactly, a fire or explosion may result causing property damage, personal injury or loss of life.

⚠ Warning: Improper installation, adjustment, alteration, service or maintenance can cause property damage, personal injury or loss of life. Refer to this manual. Installation and service must be performed by a qualified installer, service agency or the gas supplier.

Do not store or use gasoline or other flammable vapors and liquids in the vicinity of this or any other appliance.

What To Do If You Smell Gas

Do not try to light any appliance.

Extinguish any open flame.

Do not touch any electrical switch.

Do not use any phone in your building.

Immediately call your gas supplier from a neighbour's phone.

If you can not reach your gas supplier, call the fire department.

⚠ WARNING: The IDV33/IDV36 Fireplace Insert was designed for installation in a solid fuel fireplace that has been installed in accordance with national, provincial/state and local building codes and is constructed of noncombustible materials. Do not remove any refractory materials from any masonry solid fuel fireplace.

The IDV33/IDV36 Fireplace Insert was designed for installation in a zero clearance type listed solid fuel burning factory built fireplace. It may be necessary to remove the damper plate, refractory liners, log grates, glass door, and screen rails/mesh. Removal of the smoke baffle is necessary in most cases.



A Division of R-Co. Inc.
2340 Logan Avenue
Winnipeg, Manitoba, Canada R2R 2V3
Ph: (204) 632-1962

⚠ WARNING



**HOT GLASS WILL
CAUSE BURNS.
DO NOT TOUCH GLASS
UNTIL COOLED.
NEVER ALLOW CHILDREN
TO TOUCH GLASS.**

Pre-installation Questions and Answers

About curing of the paint

Your stove or fireplace has been painted with the highest quality silicone stove paint. This paint dries quickly in 15-20 minutes when first applied at the factory. However, due to the high temperature silicone components, the paint will cure when heat is applied to the appliance as it is first used. The following information applies to the curing process to get the paint fully hard and durable.

Fire the appliance four successive times for 10 minutes each firing and a 5 minute cool down between each. Be aware during log and firebox paint curing that a white deposit may be developing on the inside of the glass doors. It is important to remove this white deposit from the glass doors with an appropriate cleaner to prevent build-up (such as Windex or a commercial fireplace glass cleaner).

- Babies, small children, pregnant women and pets should leave the area during the cure phase.
- Ventilate well, open doors and windows.
- Do not touch during curing.

Why does my fireplace or stove give off odour?

It is normal for your fireplace to give off some odour. This is due to the curing of the paint, adhesives, silicones and any undetected oil from the manufacturing process as well as the finishing materials used with the installations (e.g. marble, tile and the adhesives used to adhere this product to the walls can react with heat and cause odours).

It is recommended that you burn your gas fireplace or stove for a minimum of four hours at a time with the fan off after the curing of the paint has been completed. These odours can last upward to 40 hours of burn time; keep burning at a minimum of four hours per use until odours dissipate.

Noise coming from the fireplace?

Noise is caused by the expansion and contraction of metal as the appliance heats up and cools down. This is normal and is similar to the sounds produced by a furnace or heating duct. This noise does not affect the operation or longevity of your fireplace.

Operating Instructions

1. Be sure to read and understand all the instructions in this manual before operation of appliance.
2. Ensure all wiring is correct and properly enclosed to prevent possible shock.
3. Check for gas leaks.
4. Make sure the glass door is properly installed before operation. Never operate the appliance with the glass door removed.
5. Make sure venting and termination cap are installed and unobstructed.
6. If brick or porcelain liners are used, ensure they are installed.
7. Verify that the pilot can be seen when lighting the appliance. If not, the log or rock placement is incorrect.
8. If the unit is turned off, you must wait a minimum of 60 seconds before re-lighting it.

Table of Content

Pre-installation Questions and Answers	2
Operating Instructions	2
Table of Content	3
Mobile Home/Manufactured Housing Installation	4
Warnings, Installations, and Operations	5
Operations and Maintenance Instructions	6
Installation Requirements for the Commonwealth of Massachusetts	6
IDV33 Insert Dimensions and Sizing	7
I33CV Clean View and Surround Sizes	7
I33LK Louver Kit and Surround Sizes	8
IDV36 Insert Dimensions and Sizing	9
I36CV Clean View and Surround Sizes	9
I36LK Louver Kit and Surround Sizes	10
I33CV/I36CV Front Face and Surround Attachment Installation	11
I33LK/I36LK Front Face Attachment Installation	12
Surround Installation for IDV33/IDV36 Fronts	13
Wall Coverings IDV33 IDV36	14
Clearance to Combustible Mantels	15
Venting	16
Installation of Vent Pipe	17
IDV33/IDV36 Riser Kit and Leveling Instructions	18
Glass Door Information	19
Brick and Porcelain Panel Installation	20
Overlay and Double Door Installation	21
Gas Line Installation	22
Burner Installation/Removal	23
Fan Installation/Removal	24
IDV33/IDV36 Insert Burner Component List	25
Millivolt System, Lighting, and Burner Control	26
IPI Electronic Ignition System	27
IPI Lighting Instructions	30
Log Placement – LOGF35	31
Log Placement – LOGF36	32
MQROCK1/MQRSP4 for IDV33/IDV36	33
Conversion Kit Instructions – PART A	35
Gas Conversion for Top Convertible Pilot (Series 019065X) – PART B	36
IDV33 Parts List	37
IDV36 Parts List	37
Parts for IDV33 and IDV36	38
Parts for IDV33/IDV36 Venting	38
Troubleshooting the Gas Control System	39

Mobile Home/Manufactured Housing Installation

This Direct Vent System Appliance must be installed in accordance with the manufacturer's installation instructions and the Manufactured Home Construction and Safety Standard Title 24 CFR, Part 3280, or the current Standard for Fire Safety Criteria for Manufactured Home Installation, Sites, and Communities ANSI/NFPA 501A, and with CAN/CSA Z240 MH Mobile Home Standard in Canada.

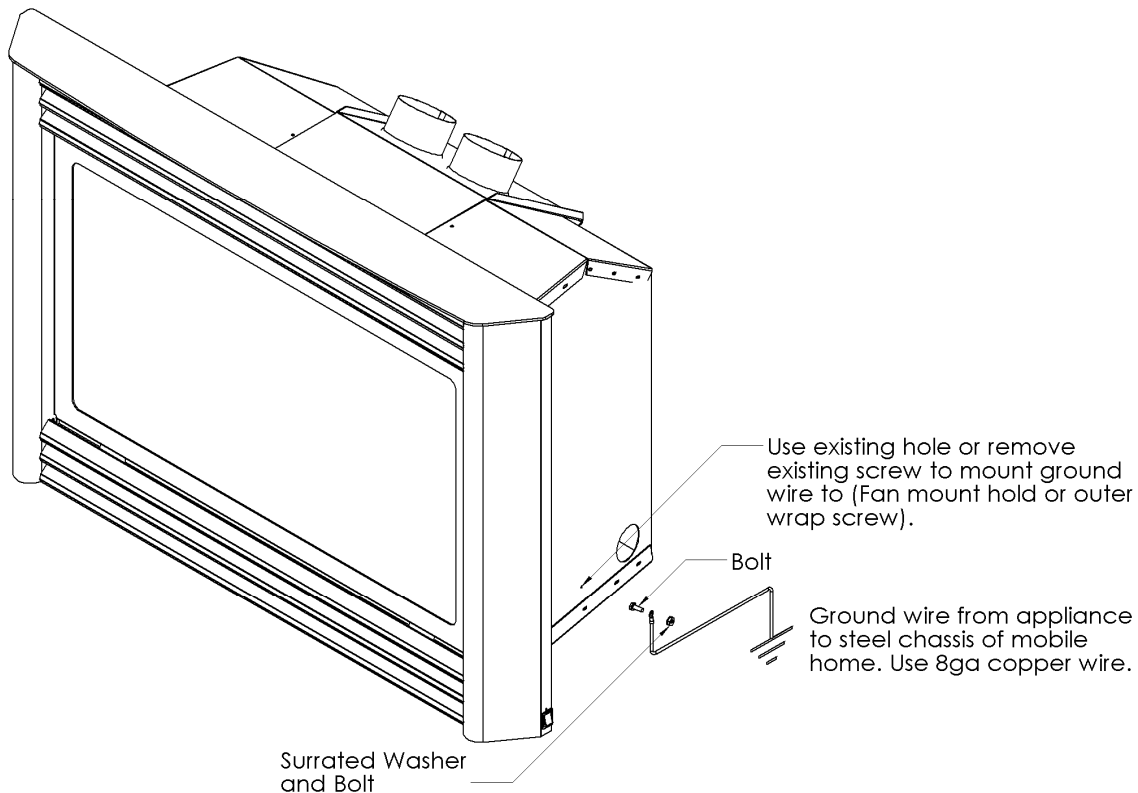

THIS APPLIANCE MAY BE INSTALLED IN MANUFACTURED (MOBILE) HOMES AFTER FIRST SALE.

Please follow the current ANSI/NFPA 70 National Electrical Code in the USA and CAN/CSA C22.1 Canadian National Electrical Code in Canada.

An appliance must be grounded to the steel chassis of the home with 8ga. copper wire using a serrated or star washer to penetrate paint or protective coating to insure grounding.

Use carriage bolt at the attachment point (see diagram above) to secure the appliance to the floor.

Bedroom approved.



Warning: Do not compromise the structural integrity of the manufactured home wall, floor or ceiling, during installation of appliance or venting.

For required venting components see venting installation in appropriate section of this manual.

Warnings, Installations, and Operations

Installation Regulations

This gas appliance must be installed by a qualified installer in accordance with local building codes, or in the absence of local codes, with the current CAN/CGA-B149.1 Installation Code (in Canada) or the current National Fuel Gas Code Z223.1 when installed in the United States.

This appliance, when installed, must be electrically connected and grounded in accordance with local codes, or in the absence of local codes, with the current CSA C22.1 Canadian Electrical Code or with the national Electrical Code; ANSI/NFPA 70-1987 when installed in the United States.

Warning

FOR SAFE INSTALLATION AND OPERATION OF YOUR GAS FIREPLACE PLEASE NOTE THE FOLLOWING:

1. Do not clean when the glass is hot.
2. Do not use abrasive cleaners.
3. Using a substitute glass will void all product warranties.
4. For safe operation, glass doors must be closed.
5. When purging the gas line, the glass front must be removed.
6. Do not strike or abuse glass. Take care to avoid breakage.
7. Do not alter gas orifice.
8. No substitute materials may be used other than factory supplied components.
9. This appliance gives off high temperatures and should be located out of heavy traffic areas and away from furniture and draperies.
10. Children and adults should be alerted to the hazards of the high surface temperatures of this appliance and should stay away to avoid burns or ignition of clothing.
11. Young children should be carefully supervised when they are in the same room as the appliance. Toddlers, young children and others may be susceptible to accidental contact burns. A physical barrier is recommended if there are at risk individuals in the house. To restrict access to a fireplace or stove, install an adjustable safety gate to keep toddlers, young children and other at risk individuals out of the room and away from hot surfaces.
12. Under no circumstances should any solid fuels (wood, paper) be used in this appliance.
13. Under no circumstances should this appliance be modified. Any parts that have to be removed for servicing should be replaced prior to operating this appliance.
14. Installation and repair should be done by a qualified service person. The appliance should be inspected before use and at least annually by a professional service person. More frequent cleaning may be required due to excessive lint from carpeting, bedding material, et cetera. It is imperative that control compartments, burners and circulating air passageways of the appliance be kept clean. Make sure that the gas valve and pilot light are turned off before you attempt to clean this unit.
15. Clothing or other flammable material should not be placed on or near the appliance. This appliance should not be used as a drying rack for clothing nor should Christmas stockings or decorations be hung from it.
16. Do not use this heater if any part has been under water. Immediately call a qualified service technician to inspect the heater and to replace any part of the control system and any gas control which has been under water.
17. Do not operate appliance unless completely installed as per installation instructions.
18. Failure to position the parts in accordance with these diagrams or failure to use only parts specifically approved with this appliance may result in property damage or personal injury.
19. Do not operate appliance with the glass front removed, cracked or broken. Replacement of the glass should be done by a licensed or qualified service person.
20. The front of the fireplace gives off high temperatures that could ignite combustible material which is kept close to the front of the unit.
21. Ensure that power to the Fireplace is turned off before servicing.
22. Do not operate this Fireplace without the glass front or with a broken glass.
23. Improper installation, adjustment, alteration, service or maintenance can cause injury or property damage. Refer to the owner's information manual provided with this appliance. For assistance or additional information consult a qualified installer, service agency, or the gas supplier.
24. Operation of this appliance when not connected to a properly installed and maintained venting system or tampering with the blocked vent shutoff system can result in carbon monoxide (CO) poisoning and possible death.



- Gas fired appliances may be used only for supplemental heat and/or decorative purposes and under no circumstances shall they provide a primary heat source.

- If the factory-built fireplace has no gas access hole(s) provided, an access hole of 1.5in [37.5mm] or less may be drilled through the lower sides or bottom of the firebox in a proper workmanship like manner. This access hole must be plugged with non-combustible insulation after the gas supply line has been installed.
- Cutting any sheet-metal parts of the fireplace, in which the gas fireplace insert is to be installed, is prohibited.
- This appliance must not be connected to a chimney flue serving a separate solid-fuel burning appliance.
- Installer must mechanically attach the supplied label to the inside of the fireplace into which the gas fireplace insert is installed.

⚠ Warning: This fireplace has been converted for use with a gas fireplace insert only and cannot be used for burning wood or solid fuels unless all original parts have been replaced, and the fireplace re-approved by the authority having jurisdiction.

NOTE: It is recommended that a Carbon Monoxide (CO) Detector be installed in or near bedrooms and on all levels of your home. Place a detector about 15ft [4.5m] outside the room that houses your gas appliance.

Certified for installation in a bedroom or bed/sitting room. In Canada must be installed with listed millivolt thermostat. In USA see local codes.

Operations and Maintenance Instructions

For safe installation and operation note the following:

- The Burner/Log Assembly has been engineered and permanently adjusted for proper flame control.
- Periodically remove the logs from the grate assembly and vacuum any loose particles from the grate and burner areas. See Log Placement page to remove logs. Vacuum burner parts and replace logs.
- Never use your gas fireplace as a cooking device.
- Label all wires prior to disconnection when servicing controls. Wiring errors can cause improper and dangerous operation. Verify proper operation after servicing.

Installation Requirements for the Commonwealth of Massachusetts

In the Commonwealth of Massachusetts, the installer or service agent shall be a plumber or gas fitter licensed by the Commonwealth.

When installed in the Commonwealth of Massachusetts or where applicable codes; the unit shall be installed with a CO detector per the requirements listed below.

1. For direct-vent appliances, mechanical-vent heating appliances or domestic hot water equipment, where the bottom of the vent terminal and the air intake is installed below four feet above grade the following requirements must be satisfied:
 - A. If there is not one already present, on each floor level where there are bedroom(s), a carbon monoxide detector and alarm shall be placed in the living area outside the bedroom(s). The carbon monoxide detector shall comply with NFPA 720 (2005 Edition).
 - B. A carbon monoxide detector shall be located in the room that houses the appliance or equipment and shall:
 - Be powered by the same electrical circuit as the appliance or equipment such that only one service switch services both the appliance and the carbon monoxide detector;
 - Have battery back-up power;
 - Meet ANSI/UL 2034 Standards and comply with NFPA 720 (2005 Edition); and
 - Have been approved and listed by a Nationally Recognized Testing Laboratory as recognized under 527 CMR.
 - C. A Product-approved vent terminal must be used, and if applicable, a Product-approved air intake must be used. Installation shall be in strict compliance with the manufacturer's instructions. A copy of the installation instructions shall remain with the appliance or equipment at the completion of the installation.
 - D. A metal or plastic identification plate shall be mounted at the exterior of the building, four feet directly above the location of vent terminal. The plate shall be of sufficient size to be easily read from a distance of eight feet away, and read "Gas Vent Directly Below".
2. For direct-vent appliances, mechanical-vent heating appliances or domestic hot water equipment where the bottom of the vent terminal and the air intake is installed above four feet above grade the following requirements must be satisfied:
 - A. If there is not one already present, on each floor level where there are bedroom(s), a carbon monoxide detector and alarm shall be placed in the living area outside the bedroom(s). The carbon monoxide detector shall comply with NFPA 720 (2005 Edition).
 - B. A carbon monoxide detector shall:
 - Be located in the room that houses the appliance or equipment;
 - Be either hard-wired or battery powered or both; and
 - Shall comply with NFPA 720 (2005 Edition).

A Product-approved vent terminal must be used, and if applicable, a Product-approved air intake must be used. Installation shall be in strict compliance with the manufacturer instructions. A copy of the installation instructions shall remain with the appliance or equipment at the completion of the installation.

For the state of Massachusetts a **T-handle gas shut-off valve** must be used on a gas appliance. This T-handle gas shut-off valve must be listed and approved by the state of Massachusetts. This is in reference to the state of Massachusetts state code CMR238.

IDV33 Insert Dimensions and Sizing

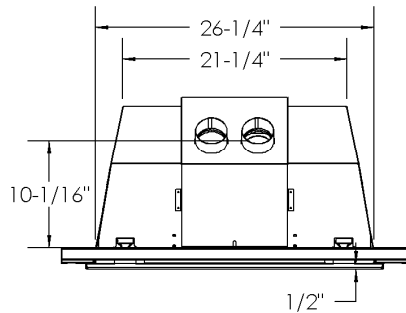
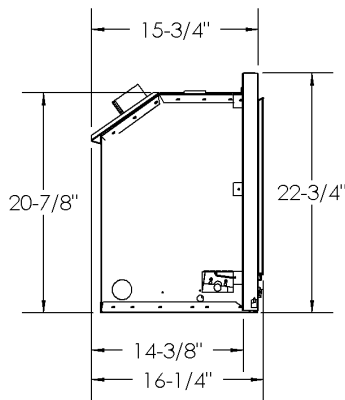
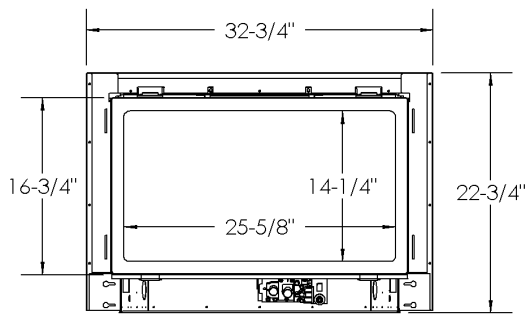

Min. Coverage with Optional I33LK or I33CV			
	Base Unit	I33LK	I33CV
Front Width:	26-1/4"	34-1/2"	32-3/4"
Rear Width:	21-1/4"		
Height:	21-3/8"	24-3/8"	22-3/4"
Depth:	14-3/8"		

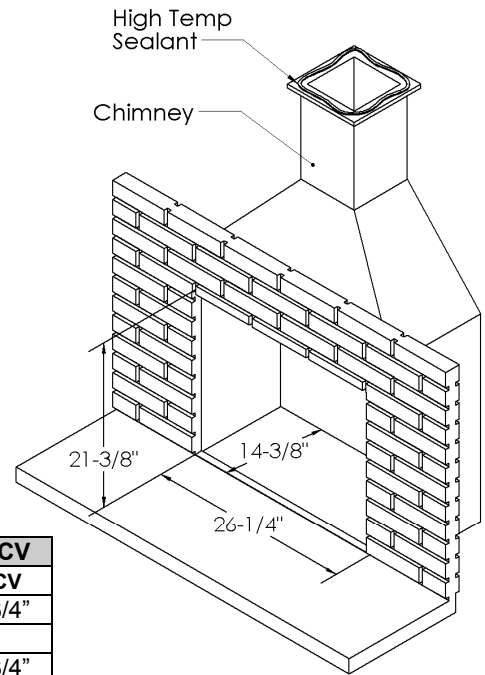

I33CV Clean View and Surround Sizes

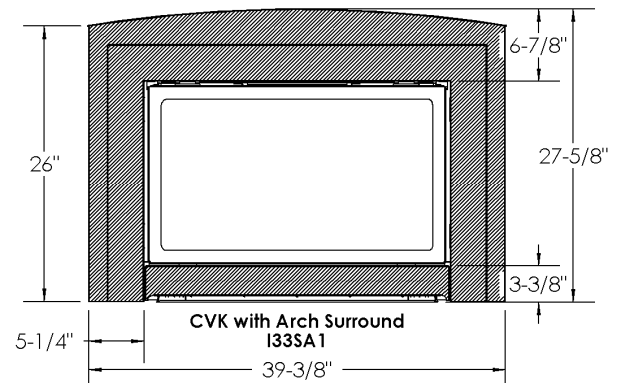
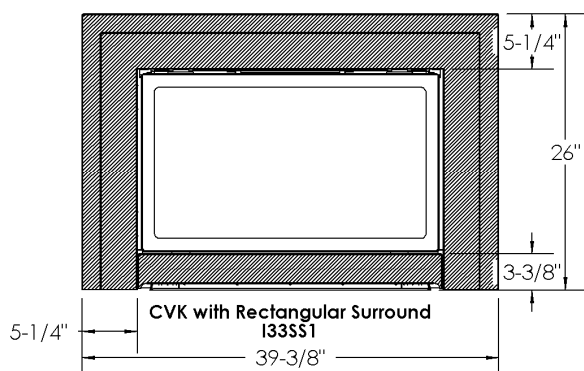
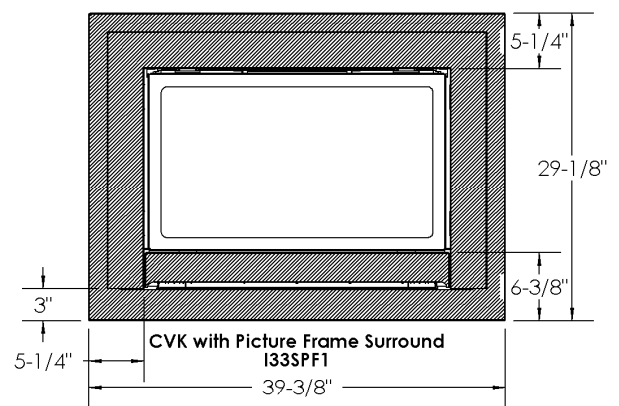
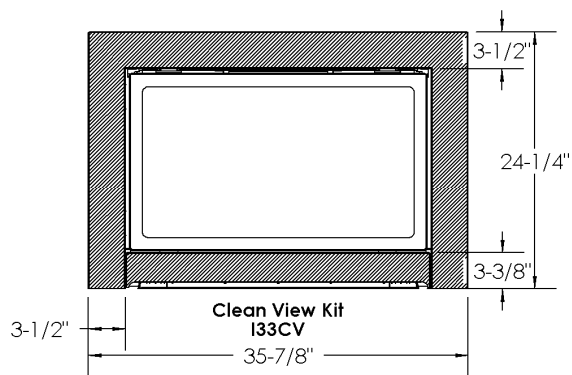

I33LK Louver Kit and Surround Sizes

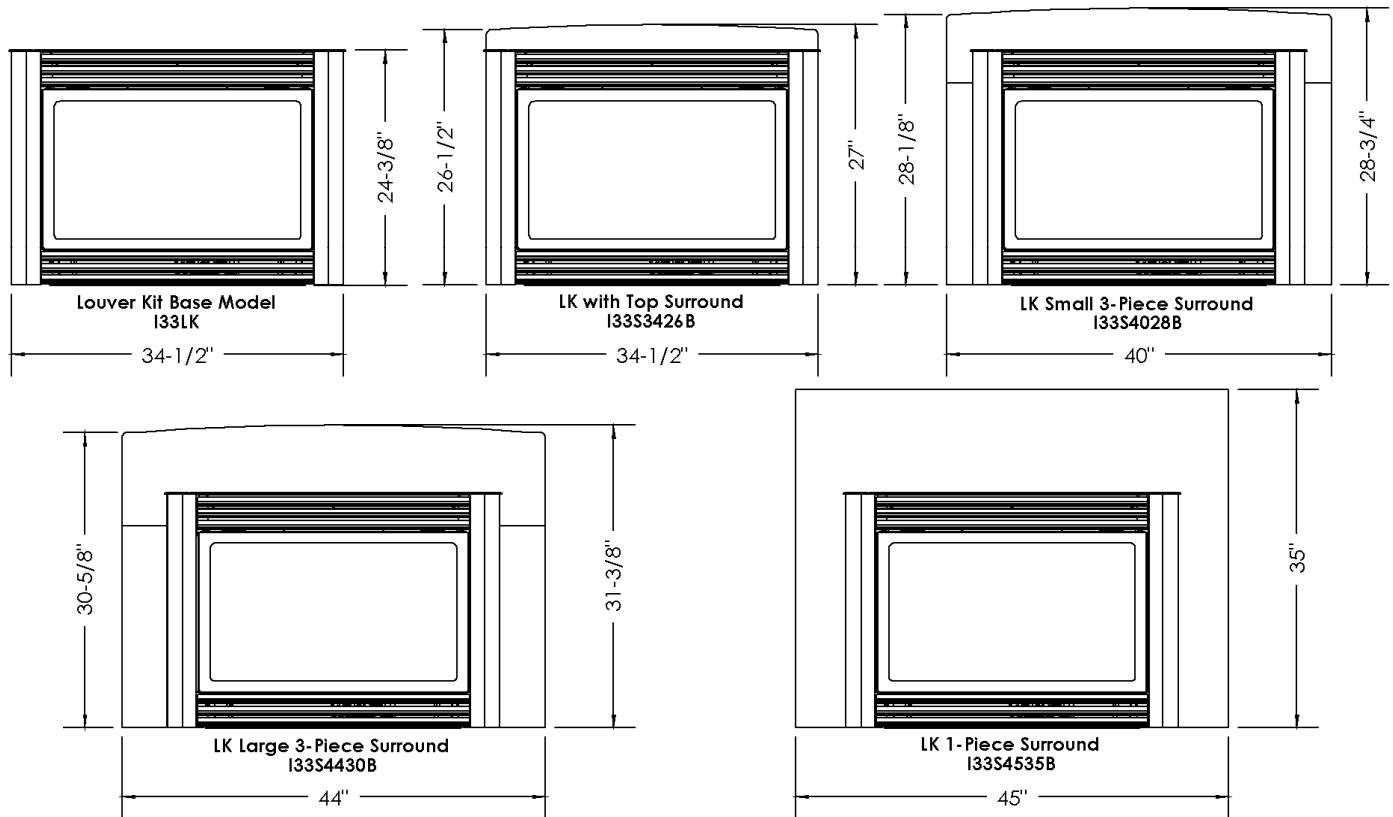

NOTE: The Surrounds shown here are universal and can be used with the I33CV model. Furthermore, the I33S4535B and I36S4736B (1-piece Surround) was designed to be used as a custom cutout surround. Simply trace template and cut out design using the universal surround.

IDV36 Insert Dimensions and Sizing

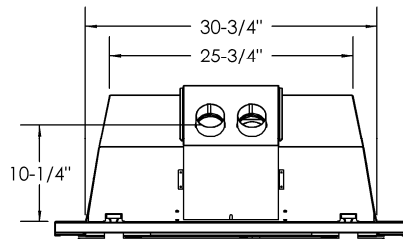
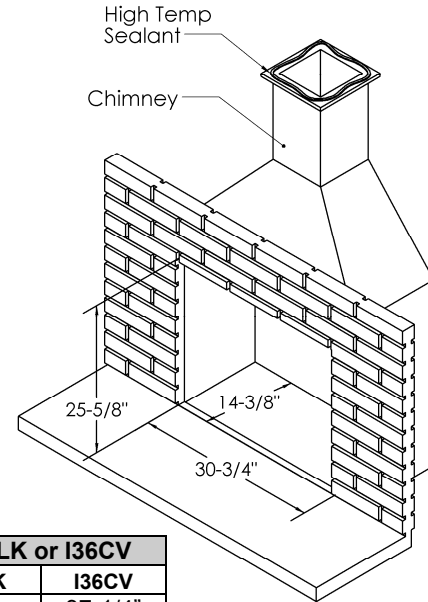
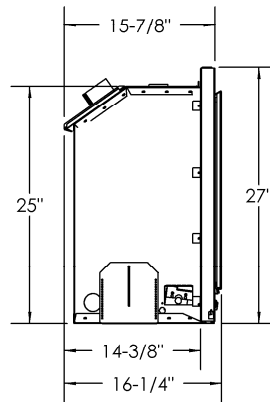
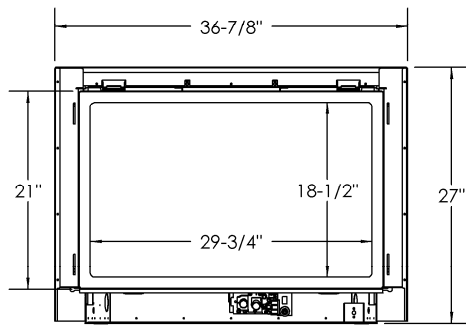

Min. Coverage with Optional I36LK or I36CV			
	Base Unit	I36LK	I36CV
Front Width:	30-3/4"	39"	37-1/4"
Rear Width:	25-3/4"		
Height:	25-5/8"	28-3/4"	27"
Depth:	14-3/8"		

I36CV Clean View and Surround Sizes

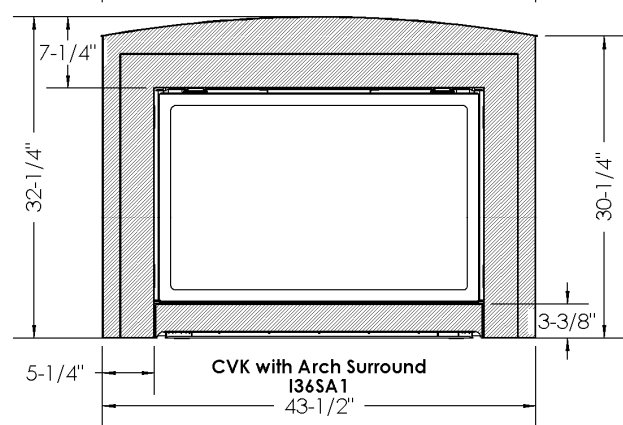
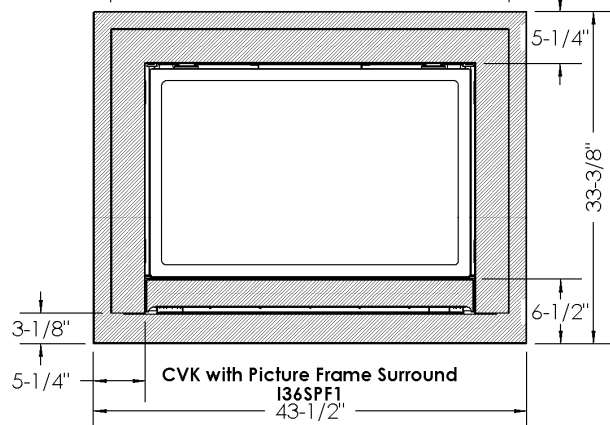
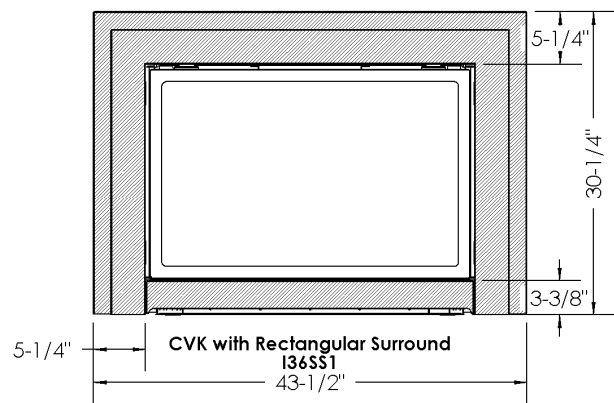
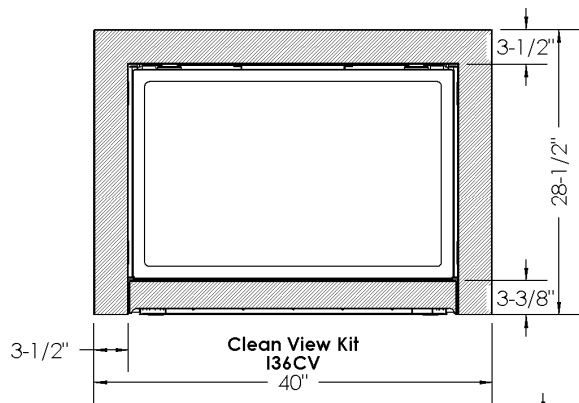

I36LK Louver Kit and Surround Sizes

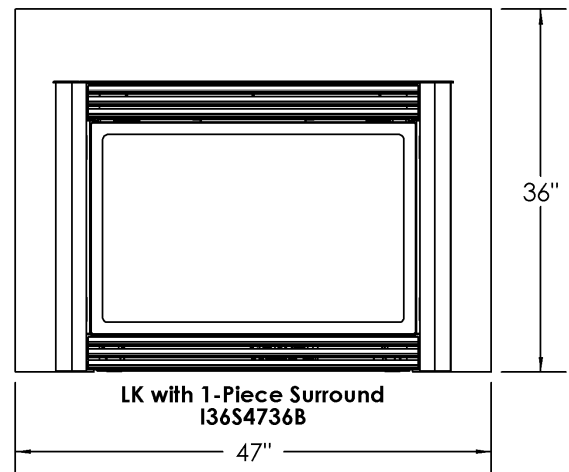
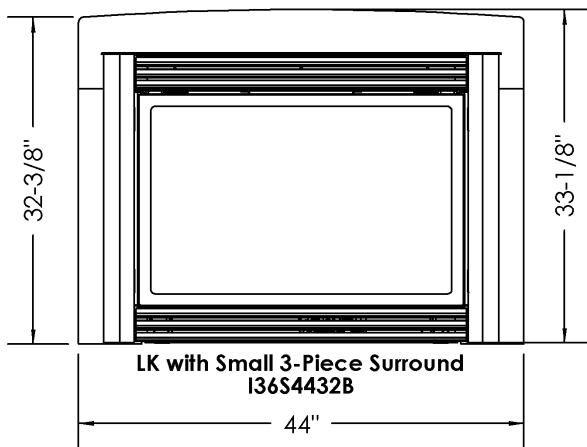
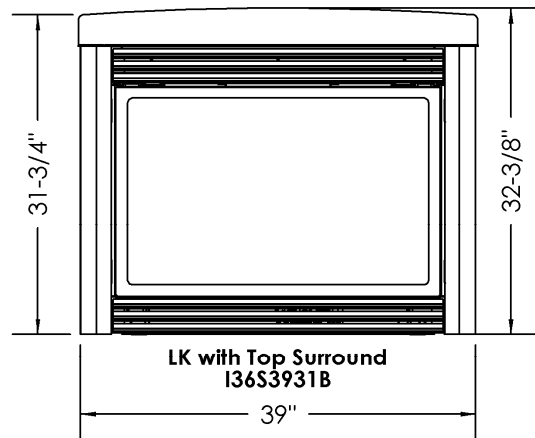
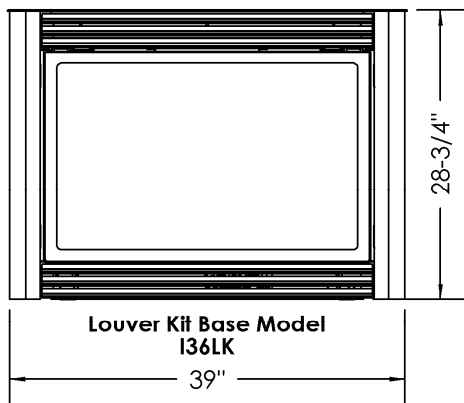

NOTE: The Surrounds shown here are universal and can be used with the I36CV model. Furthermore, the I33S4535B and I36S4736B (1-piece Surround) was designed to be used as a custom cutout surround. Simply trace template and cut out design using the universal surround.

I33CV/I36CV Front Face and Surround Attachment Installation

1. Remove the Top Filler Panel to install vent adapter and venting to the unit. Once this is done, reinstall the Top Filler Panel. Refer to Installation of Vent Pipe for venting information.
2. Install ON/OFF switch into the slot provided located at the lower left hand side of the appliance.
3. If the Optional Surround Kit is being used then fasten them to the Clean View kit with the seven [7] screws provided.
4. Insert the Clean View Mounting Tab into the Clean View Mounting Slots (four [4] places) and lower the Clean View kit into place. If an Optional Surround is to be installed on this appliance, make sure to do so before the Clean View Kit is mounted. Note that the Clean View and Surround assembly simply sits in this position without any other attachment mechanisms. Please refer to the illustration below for guidance.

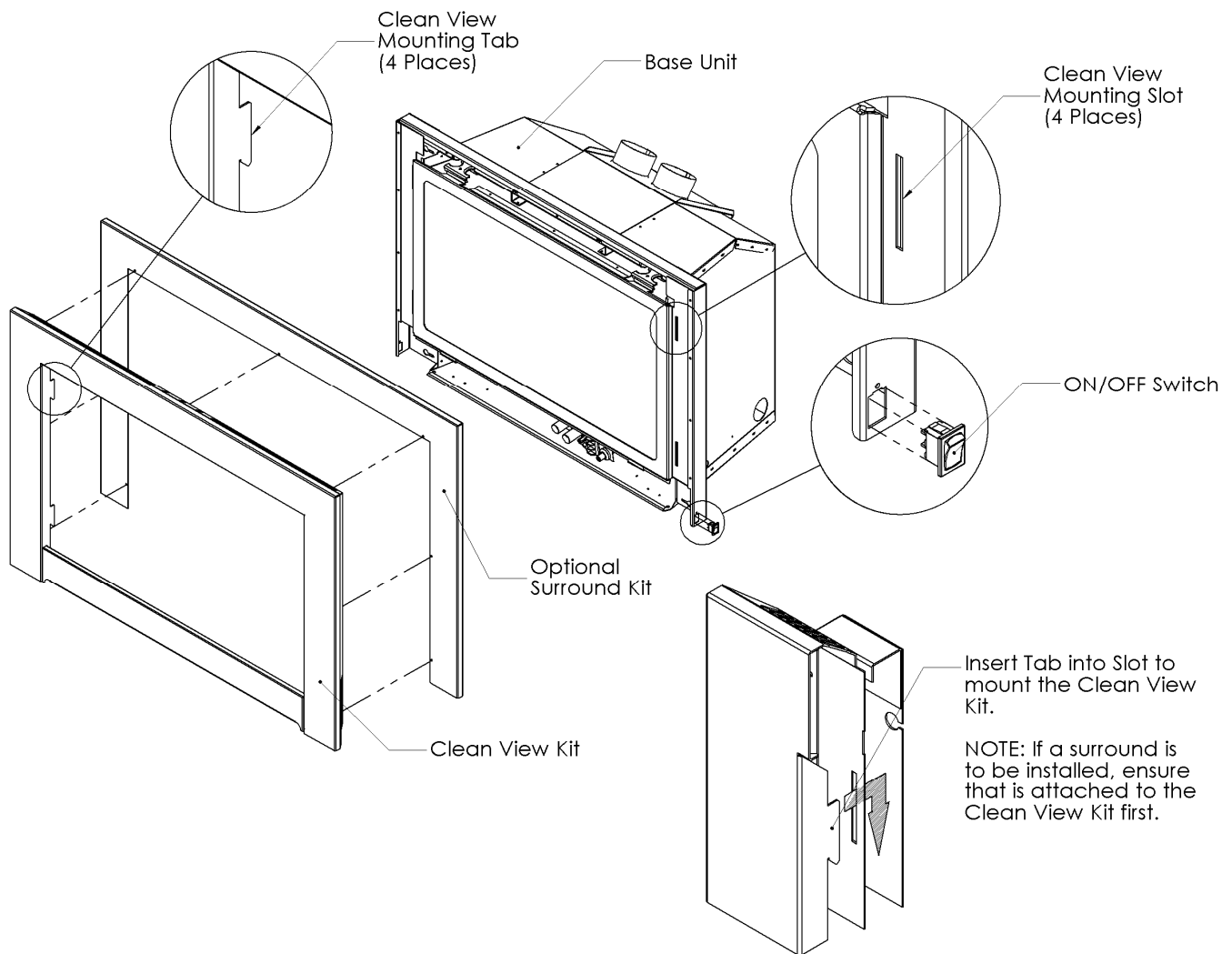

NOTE: The Clean View Surround needs to be removed in order to access the Glass Door and service the unit.

I33LK/I36LK Front Face Attachment Installation

1. Remove the Top Filler piece from the Base unit by unfastening its three [3] screws. This part is not required for the I33LK/I36LK model and therefore can be discarded. However, be sure to keep the screws for fastening the I33LK/I36LK.
2. Install Vent Adapter plate. Please see Installation of Vent Pipe for reference.
3. Install the I33LK/I36LK Front to the appliance by lowering it onto the side attachments, aligning the four [4] Mounting Tabs and Slots together. Position the tabs into the slots and then lock it into place by lowering the I33LK/I36LK Front onto the hook assembly.
4. Once the I33LK/I36LK is in place simply fasten it to the appliance with the three [3] screws taken out from the Top Filler piece.
5. Install the ON/OFF switch into the slot provided located at the lower left hand side of the appliance.

NOTE: The Louver Kit Front does not need to be removed to access the Glass Door and service the unit.

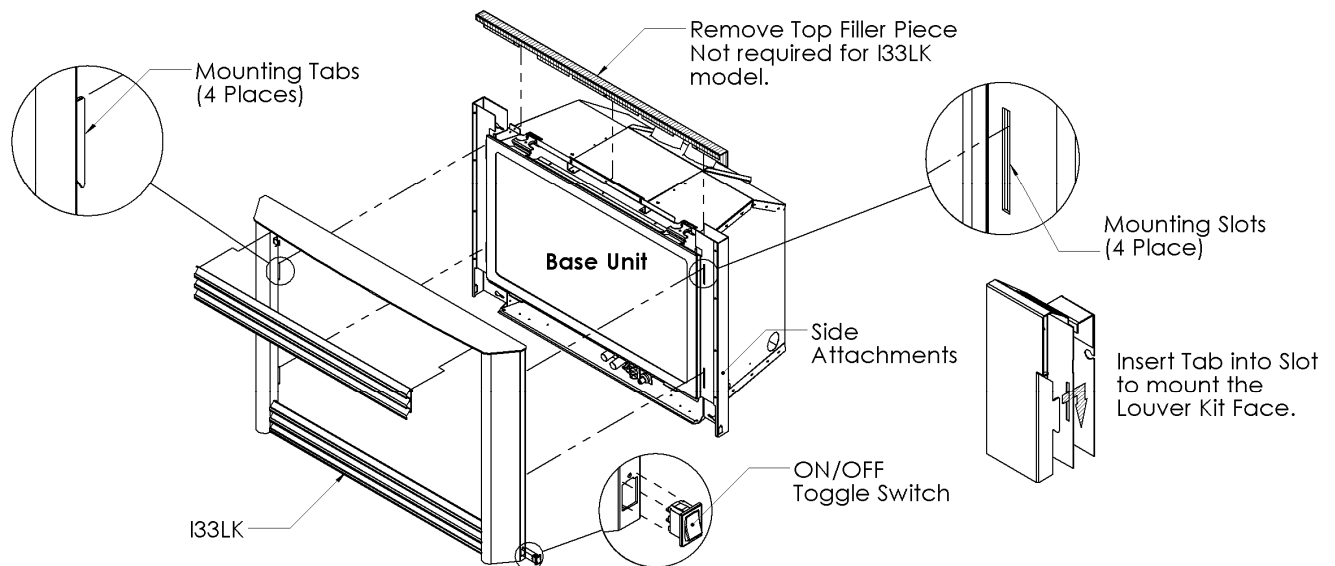

Surround Installation for IDV33/IDV36 Fronts

1. Ensure that the I33LK/I36LK Front is installed before continuing with these steps.
2. When installing a 3-piece surround, please note that the side panels must go first. When installing a 1-piece surround, simply skip the instructions for the side panel installation.
3. Slide side panels in place. Make sure the pre-set screws slide into the slots located behind the side columns. Do not tighten these screws yet. You will need to line up the top panel first.
4. Slide the top panel into place. The top panel lines up with the three [3] slots behind the top grill. Secure the top panel in place with the three [3] pre-set screws.
5. Once the top panel is secured, line up the sides with the top and then tightens the pre-set screws. There are two locations for these pre-set screws on each side panel.

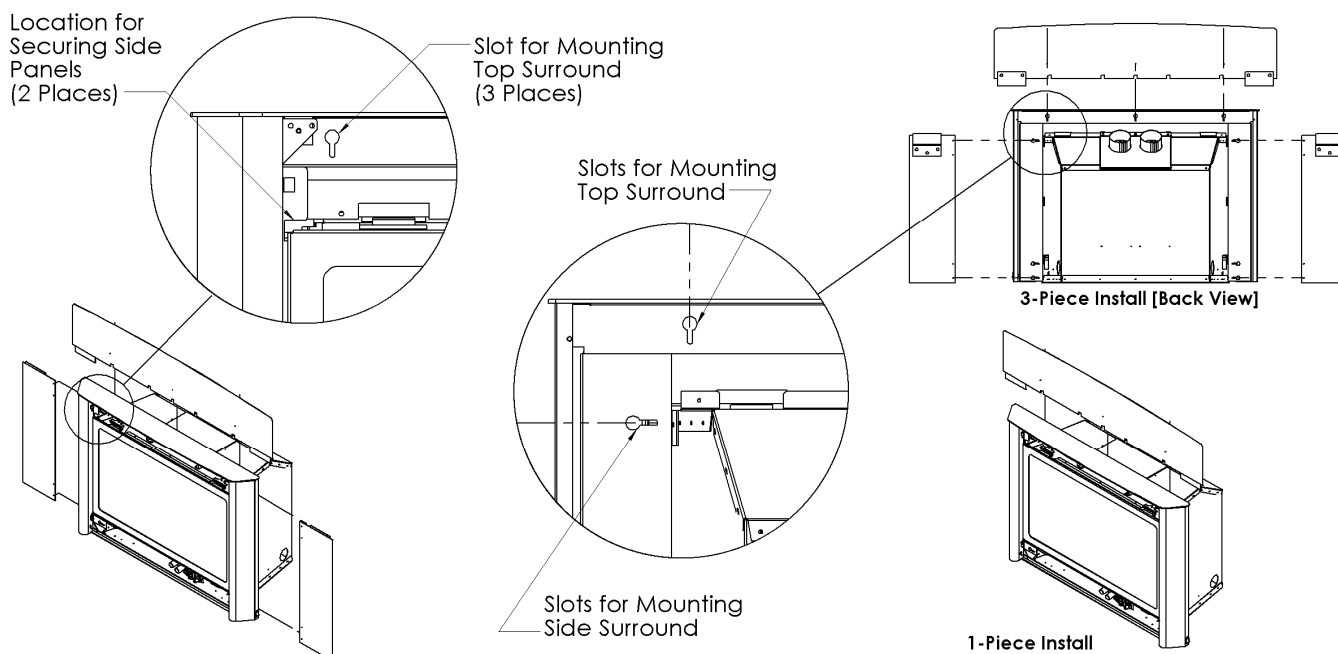

Part No.	Description	Dimensions
I33S3426B	1-Piece Top Surround	34-1/2" x 26-5/8"
I33S4028B	3-Piece Small Surround	40" x 28"
I33S4430B	3-Piece Large Surround	44" x 30-1/2"
I33S4535B	1-Piece Universal Surround	45" x 35"
I36S3931B	1-Piece Top Surround	39" x 32-3/8"
I36S4432B	3-Piece Small Surround	44" x 33-1/8"
I36S4436B	3-piece Large Surround	44" x 35-5/8"
I36S4736B	1-Piece Universal Surround	47" x 36"

Wall Coverings IDV33 IDV36

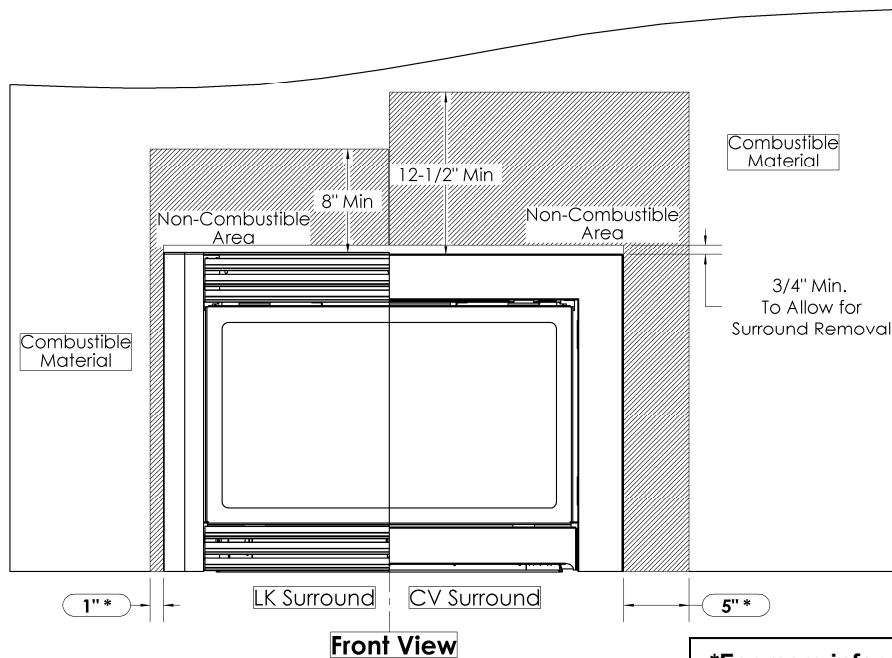
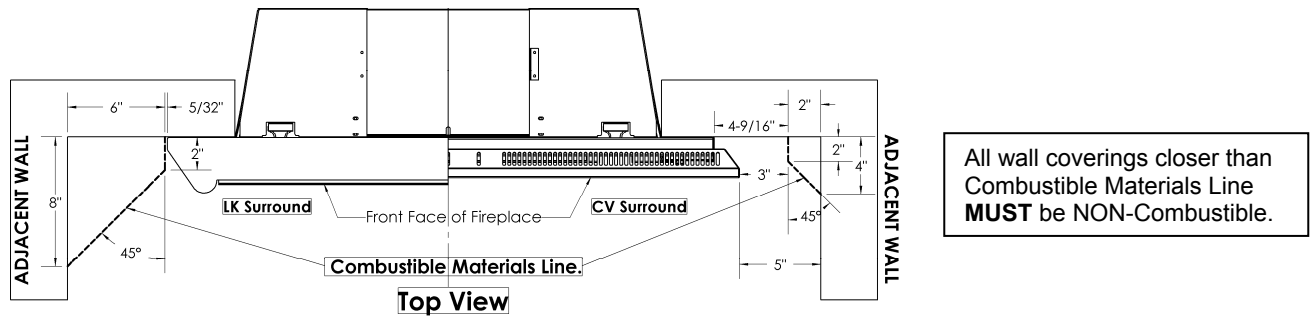
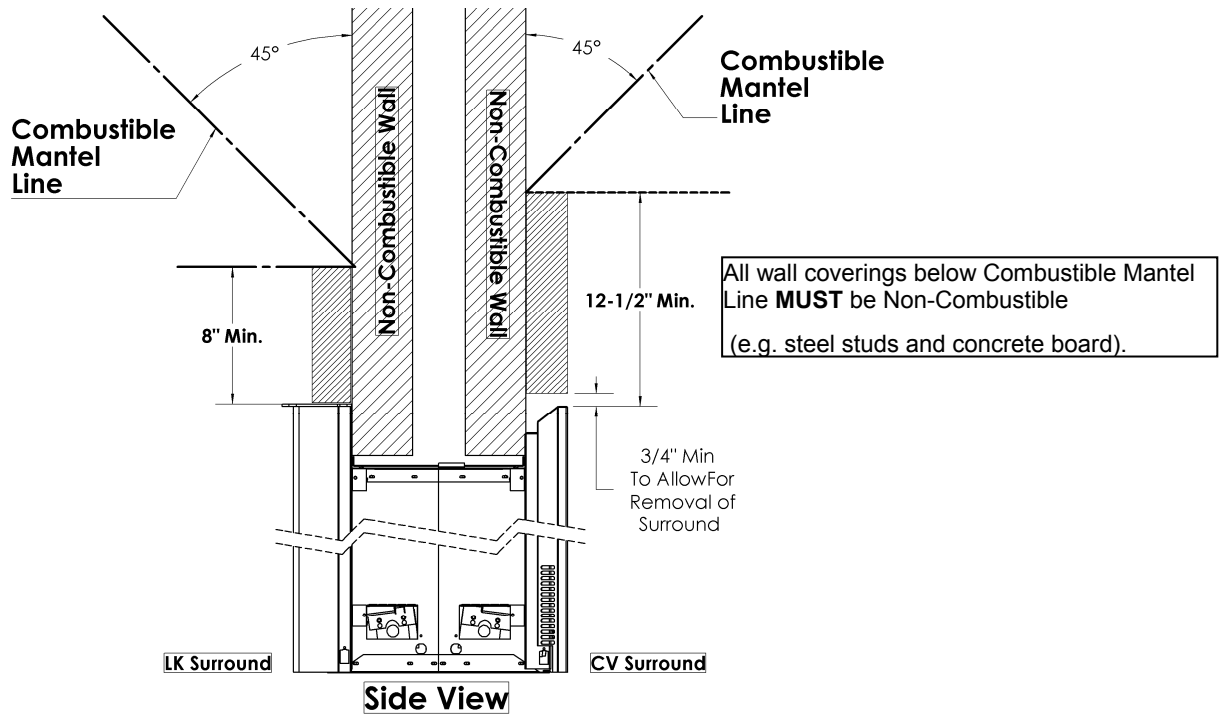

***For more information see Clearance to Combustible Mantels Page.**

Clearance to Combustible Mantels

Before installing any mantels it is important to determine the combustibility of its material(s). There are two types of mantel materials to consider: Combustible and Non-combustible.

A Combustible Mantel is one that consists of material(s) that may discolor, combust, or lose its integrity in the presence of heat. These types of mantel must strictly adhere to the dimensional requirements shown in the figures below. Conversely, a Non-combustible Mantel is one that is constructed with materials that can withstand temperatures above 250°F [121°C]. Non-combustible Mantels can be installed at any height above the fireplace opening and thus not restricted to the clearance requires. Check your local codes and regulations to determine whether your mantel is combustible or non-combustible.

Louver Kit Units		
	I33LK	I36LK
A	10"	11"
B	12"	13"
C	14"	15"
D	16"	17"
E	18"	19"
F	20"	21"
Clean View Unit		
	I33CV	I36CV
G	12.5"	16"
H	14.5"	18"
I	16.5"	20"
J	18.5"	22"
K	20.5"	24"
L	22.5"	26"

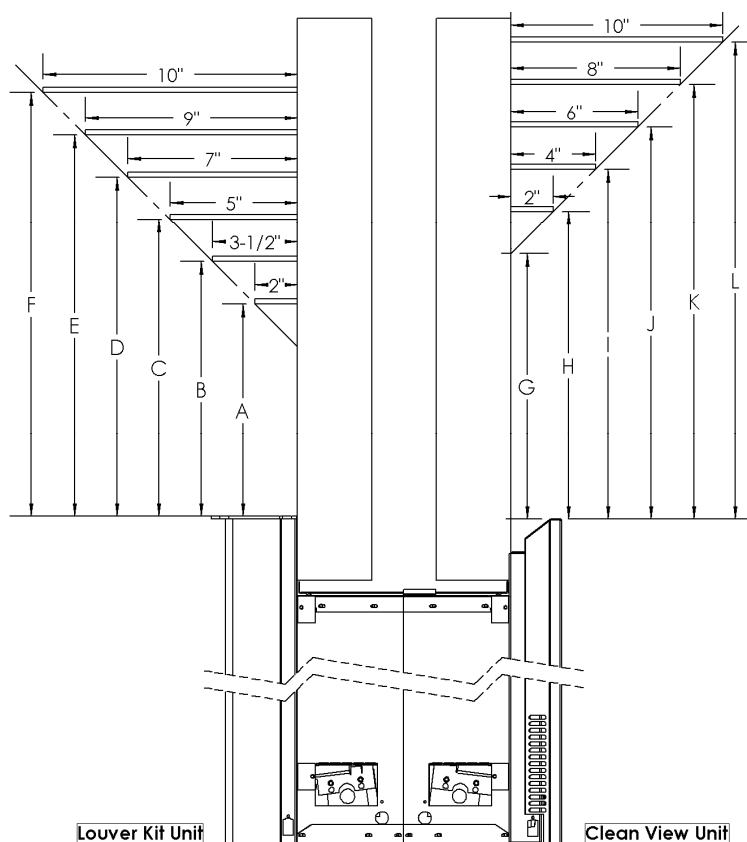

WARNING: Combustible objects must not be placed on a non-combustible mantel unless the non-combustible mantel meets the minimum height and width requirements for a combustible mantel.

Mantel Leg Clearance

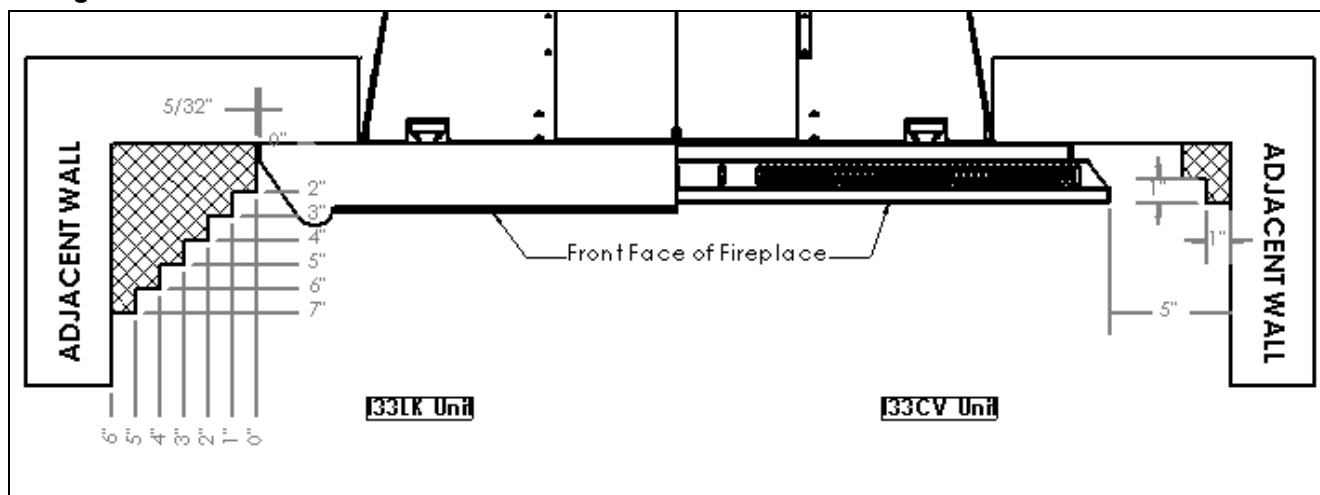

Venting

Vertical Venting in Cold Climates

In cold climate conditions where temperatures go below -10°C [14°F], we recommend that the chase be insulated and where the vent pipe enters into the attic space that the pipe be wrapped with an insulated Mylar sleeve. This will increase the temperature of the vent and help the appliance to vent properly in cold weather conditions.

It is also important in vertical vented direct vent appliances that the appliance be operated daily during the winter months as this will help stop the Termination from freezing up. We recommend using a thermostat set at room temperature to allow the unit to cycle.

This appliance must not be connected to a chimney flue serving a separate solid-fuel burning appliance.

This appliance is approved with Kingsman Flex Vent System (as listed in the manual) or Simpson Dura-vent flex pipe system (#0991 Co-linear Vertical Termination and #0923GK Co-linear Adapter for Termination). This fireplace insert is approved for use with two 3" [7.62cm] diameter gas flex liners.

All venting lining products must be approved and installed according to the vent manufacturers installation instructions. All vent liners must terminate in a rain cap to prevent debris and rain from entering the vent and possibly damaging the appliance or creating an unsafe condition. The area between the existing chimney and liner must be capped off for the same reasons as above and to reduce the chances of venting problems and corrosion of the vent.

If this fireplace insert is to be used to replace an existing fireplace insert the existing vent liner must be of the proper size and if so must be inspected for obstructions, damage and/or corrosion. Replacement must be done as necessary.

Before any vent liner is run through a chimney or other approved venting system, chimney must be inspected, cleaned and repaired if necessary. A chimney which was used for a solid fuel fireplace must be professionally cleaned in order to reduce corrosion of the vent or other possible safety hazards.

Installation of Vertical Termination IDVVT

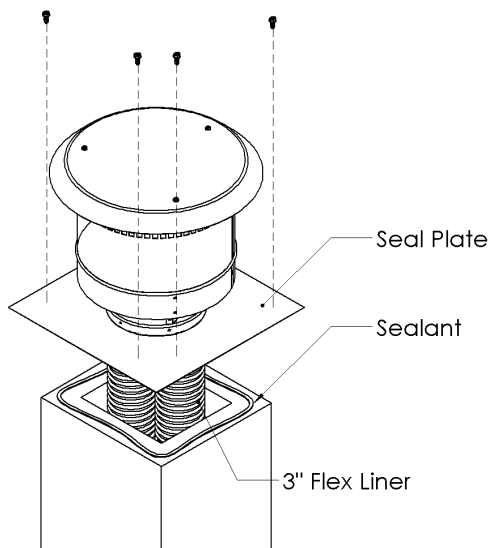

1. Before attaching the flex vents to the termination, you will have to determine how the cap will be attached to the existing chimney crown, clay lined chimney or wood stove vent pipe. The Seal Plate of the termination may be cut, notched and formed to make a good seal to the existing vent or be left flat.
2. Using a high quality sealing compound (RTV Silicone) place a bead of sealant onto the vent or chimney top. This will provide a seal against water and rain from entering the existing flue.

Venting System	
IDVVT	Vertical Vent Termination
IDVFK25	Flex Pipe kit (2ea 3" x 25ft unexpanded flex pipes complete with Millpac and screws.)
#0991	Simpson Duravent Co-linear Termination HW Vertical Top
#0923GK	Simpson Duravent Co-linear Adapter for Co-Liner Termination
NOTE: When using Simpson Duravent Termination order both #0991 and #0923GK.	

	Vertical (rise)	Horizontal (run)
Min.	10ft [3.1m]	0ft [0m]
Max.	40ft [12.2m]	2ft [0.6m]

WARNING: Failure to position the parts in accordance with these diagrams or failure to use only parts specifically approved with this appliance may result in property damage or personal injury.

Cutting any sheet-metal parts of the fireplace, in which the gas fireplace insert is to be installed, is prohibited.

Installation of Vent Pipe

1. Remove the Top Filler and adapter plate from the unit by removing the five [5] screws as shown below. (Fig. 3) Attach the vent pipes to the termination with Millpac and 4 screws per pipe joint. Be sure to label the exhaust and intake flex pipes. Make sure not to connect the exhaust to the intake or vice-versa. Lower the termination and vent pipe down the vent and screw and seal plate to the chimney crown, clay tile chimney or wood stove vent. It may be necessary to pre-drill holes into the chimney crown (depending on material) (8 screws).
2. The two vent pipes should now be hanging in the existing fireplace. Attach the adapter to the two suspended vent pipes with Millpac and screws. Let the adapter hang in place until the unit is ready to be positioned.
3. Slide the unit into place carefully. Ensure that the adapter slides along the top of the unit, in between the guides, and check that it remains flat. (Fig. 2)
4. Once the unit is slid back into position use the two screws previously removed to secure the adapter plate. When tightening the adapter plate check to make sure the plate is flat to the unit and the rear catch lock is engaged over the rear tab of unit. (Fig. 2 & 3)
5. For CV models only: Reattach the Top Filler (Fig. 1A) with three [3] screws before installing the I33CV/I36CV Fronts.
6. When using the I33LK/I36LK unit discard the Top Filler Panel and attach the I33LK/I36LK Front as per the instructions shown in the I33LK/I36LK Front Face Attachment Installation section.
7. Use Millpac to seal the vent pipe joints and ensure that it is free of any leakage.

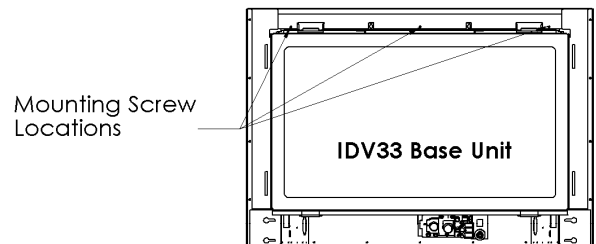
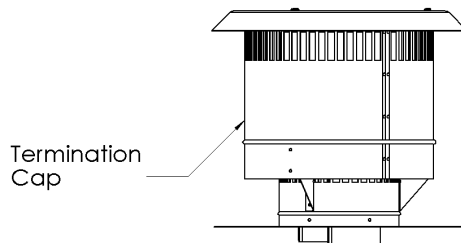

Fig. 1A - Base unit.

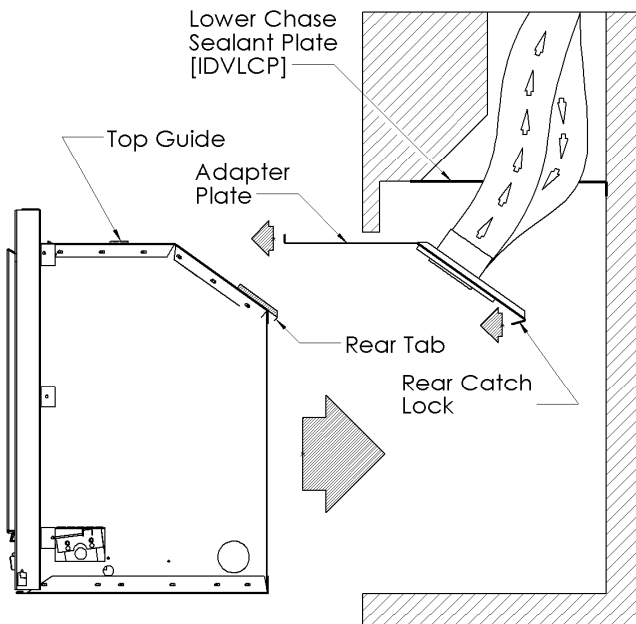

Fig. 2 - Base unit chimney venting install.

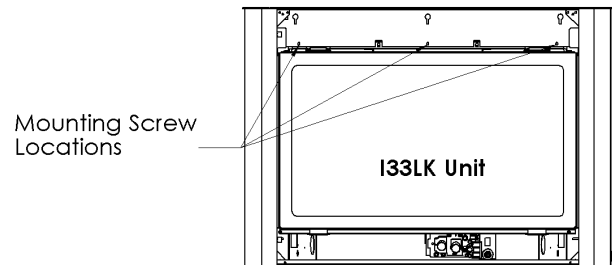

Fig. 1B - Louver kit unit.

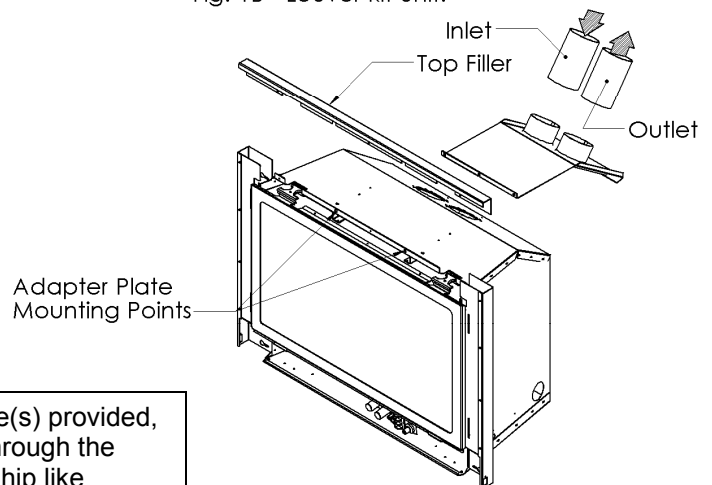

Fig. 3 - Remove top filler to install venting adapter.

NOTE: If the factory-built fireplace has no gas access hole(s) provided, an access hole of 1.5in [37.5mm] or less may be drilled through the lower sides or bottom of the firebox in a proper workmanship like manner. This access hole must be plugged with non-combustible insulation after the gas supply line has been installed.

IDV33/IDV36 Riser Kit and Leveling Instructions

Leveling Instructions

When installing insert it may be necessary to support back of unit. To support back of insert, there are two leveling plates right and left of unit.

1. Measure height required to level unit.
2. Remove two [2] outer screws and loosen center screw holding each plate into position.
3. Slide plates to the required height and align with appropriate holes. Each set of holes equals to a 1/4" of movement up to a maximum of four inches. Insert and tighten all screws (e.g. 1" of movement equals to 4 holes).

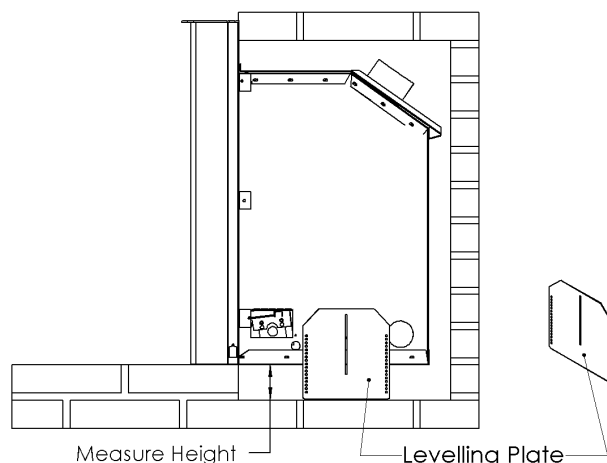

Riser Kit Installation Instructions – Model No.: I33R40 / I33R44

1. Measure height required to make flush with base of unit, Fig. 1. If measurement equals to the height of riser kit 2.5" skip to Step 3. No adjustment will be required.
2. Adjust leveling legs to required height in Step 1, Fig. 3 (Detail A).
3. Locate mounting holes punched into base right and left of unit. Place riser assembly under front of insert and fasten to base with supplied screws, Fig. 2.

Fig. 1 - Side view.

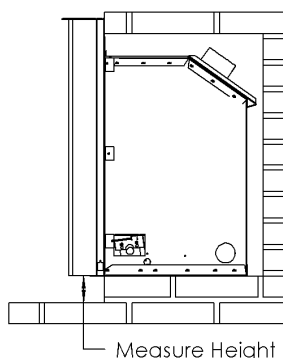

Fig. 2 - Front view with Riser Kit.

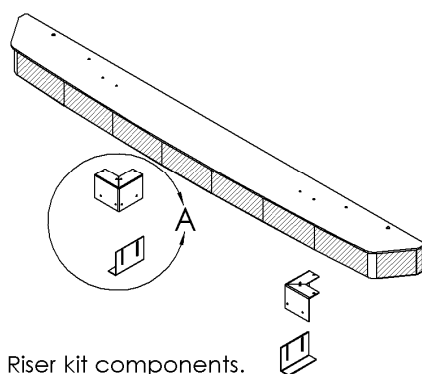
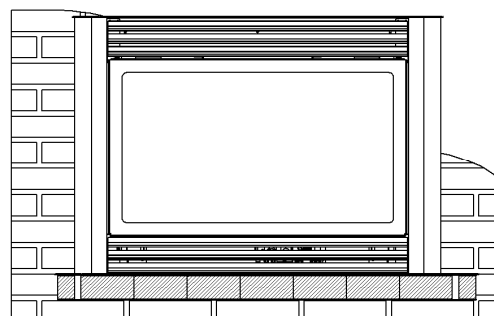
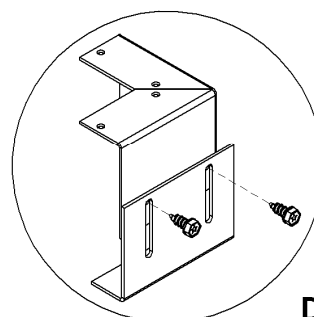

Fig. 3 - Riser kit components.



DETAIL A

WARNING: Failure to position the parts in accordance with these diagrams or failure to use only parts specifically approved with this appliance may result in property damage or personal injury.

Glass Door Information

Glass Cleaning

It will be necessary to clean the glass periodically. During start-up condensation fill form, and cause dust and lint to cling to the surface of the glass. Furthermore, the initial burn cures the paint but also leads to the deposit of a filmy residue. It is therefore recommended that the glass be cleaned two or three times, initially, with non-abrasive common household glass cleansers and warm water. After that, the glass can be cleaned two or three times a season depending on use.

Warning and Cautions

- Do not clean when the glass is hot.
- Do not use abrasive cleaners.
- Using a substitute glass will void all product warranties.
- Do not strike or abuse glass. Care must be taken to avoid breakage of the glass.
- Do not operate this fireplace without the glass front or with a broken glass.

Glass Replacement

REPLACEMENT GLASS FOR BOTH DIRECT VENT UNITS

Only Robax ceramic or coated NeoCeram glass may be used for replacement. The glass must be a minimum of 5mm thick.

Removal of the Glass Door

1. If this unit is a Clean View model then the Clean View Front Face and Surround Attachment Installation on page 11.
2. Remove the door by unlatching the two [2] top latches. To do so, simply place two fingers in the grooves and pull towards yourself while lifting the latch slightly upwards.
3. Once the top of the door is unlatched, pull it outwards and up to unlatch the bottom.
4. To re-install, place the Bottom Door Ledge into the Lower Latch assembly first. Then swing the door closed to seal it against the firebox cavity. Re-latch the Upper Latch assembly to secure the door to the appliance.
5. To replace glass, clean all materials from door frame. Using a high heat silicone (resistant to 500°F [260°C]) apply a bead of approximately 1/32" to all four sides of frame and insert glass with new gasket. The door frame should be on a flat surface with a small amount of weight pressing the glass into the silicone. Let everything dry for approximately 15 to 20 minutes. The door can be re-installed by following step 4.

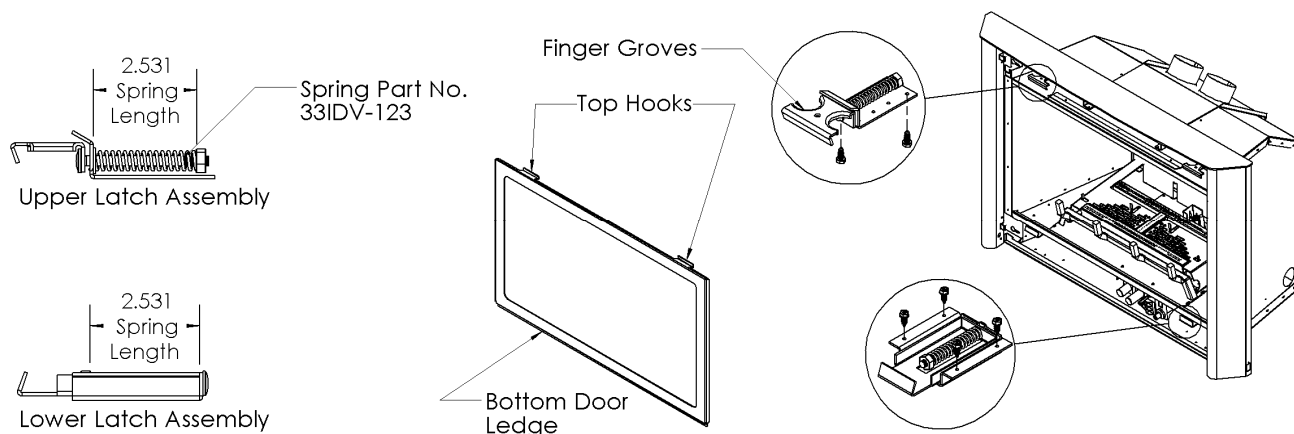

Spring Replacement

Over time the spring may need to be replaced if tension is lost. Replace spring as follows:

1. Remove the top latches by unfastening the two [2] hex screws that secures it in place. They are located in the firebox.
2. Remove the bottom latches by unfastening the four [4] hex screws located in the firebox (beside the burner assembly). Once the screws are all removed, the latches will either fall or slide out.
3. To remove the spring, unfasten the one [1] lock nut holding it in place. **NOTE: When replacing a spring tighten the lock nut so that the total compression length is 2.531". This is critical for proper tension.**



WARNING: No substitute materials may be used other than factory supplied components.

Brick and Porcelain Panel Installation

Instructions for IDV33 & IDV36

Brick

1. Remove the glass door. Refer to the Removal of the Glass Door section on page 19 for information.
2. Install rear brick panel first.
3. Install left and right side panels and secure them with brick clips.
4. Once the brick panels are secured, reinstall the glass door. Refer to Removal of the Glass Door on page 19 for information.

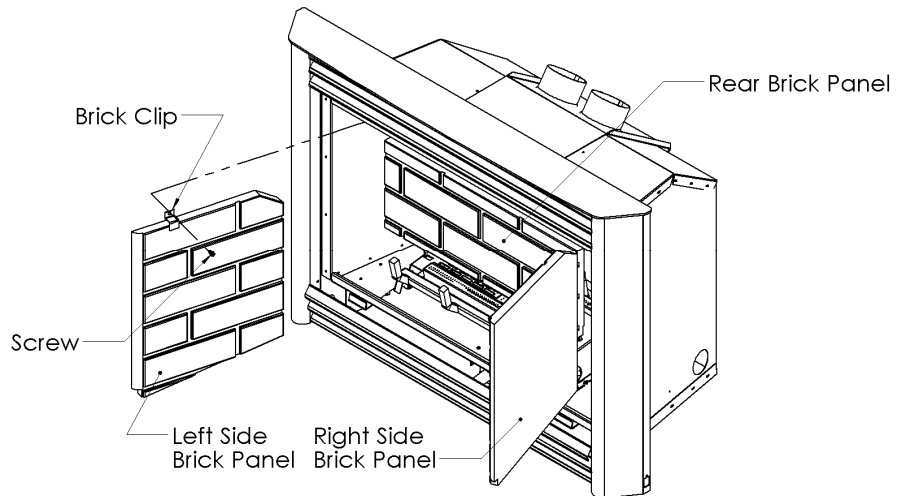

Porcelain

1. Remove the glass door. Refer to the Removal of the Glass Door section on page 19 for information.
2. Lift Log Supports out of fireplace. Remove the Air Shield by removing the four [4] screws that are securing it.
3. Place the Back Porcelain Panel up against the back of the Firebox and reinstall the Air Shield in front of the Back Panel using the same four [4] screws.
4. Remove the two [2] screws on the sides of the Firebox holding the Brick Clips in place.
5. Tilt and slide the side panels into place. Secure these side panels with the two [2] screws that was taken out in the previous step. NOTE: The Brick Clips are no longer required for the Porcelain Panel installation.
6. Once the porcelain panels are secured, reinstall the glass door. Refer to Removal of the Glass Door on page 19 for information.

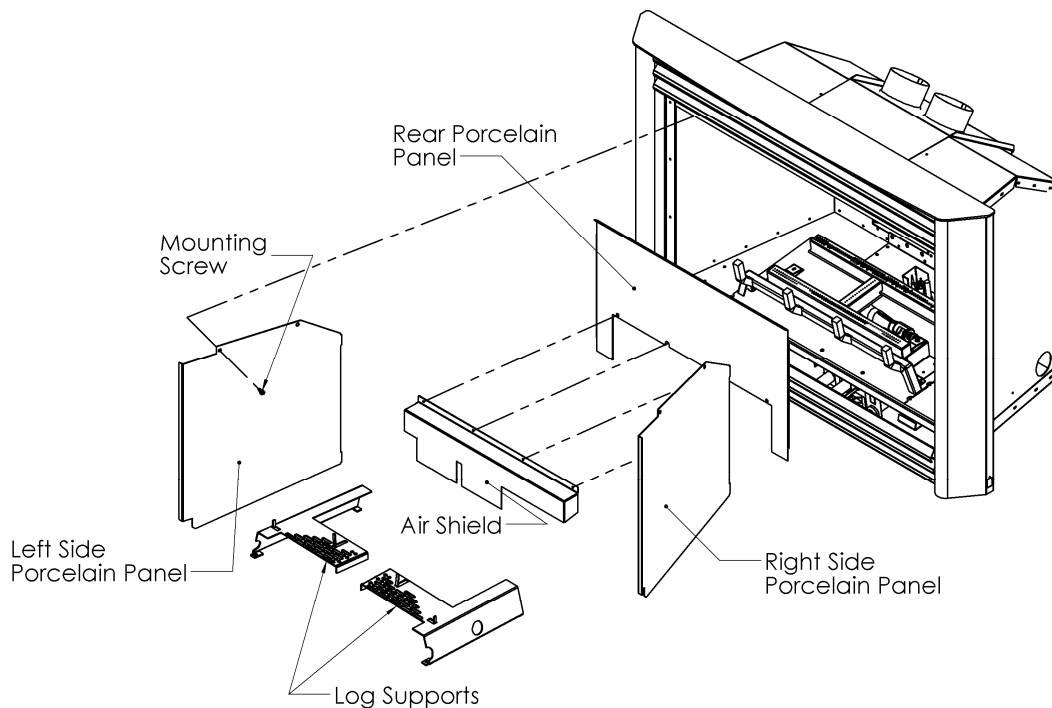

Overlay and Double Door Installation

IDV33 Overlay

This style of Overlay mounts in the square notch cutout as shown in the illustration to the right. Use magnets to secure the overlay to the glass door frame.

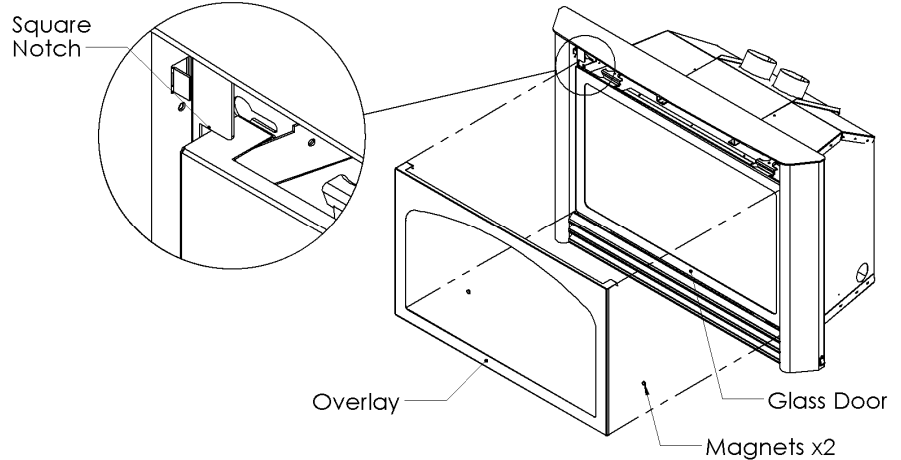

IDV36 Overlay

This style of Overlay mounts to the latching system. It sits on top of the door latch and is secured using a steel pin. The lower portion of the overlay is held to the surface of the door frame with magnets.

1. Place the Overlay over the Glass Door and insert the steel pin through to the Latch Mount Hole.
2. Use magnets to secure the lower part of the Overlay.

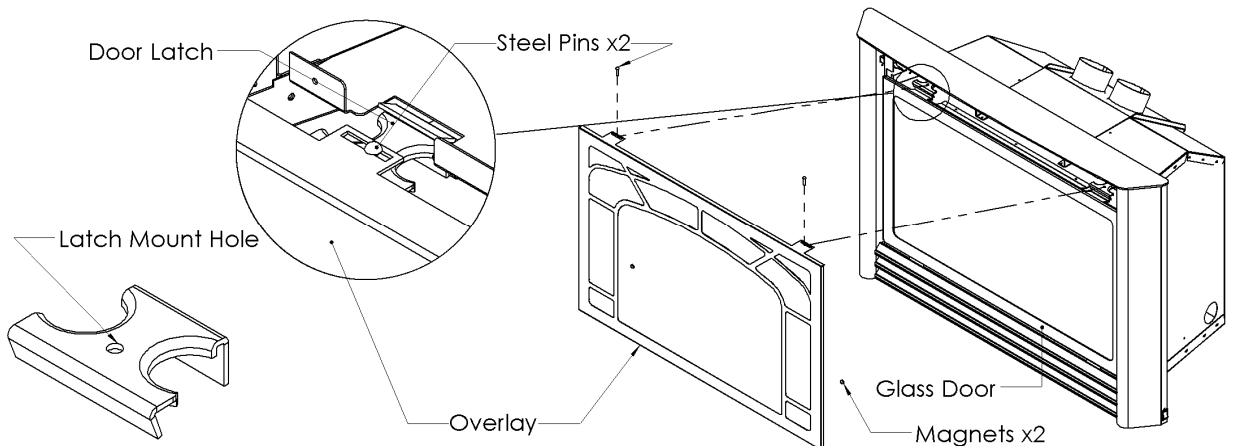

Double Door Installation

The Double Door mounts similarly to the IDV36 Overlay style. The only difference is that, instead of magnets, Retainer Clips are used to secure the lower portion of the Double Door Frame.

1. Place the Double Door Frame over the Glass Door and insert the steel pin through to the Latch Mount Hole.
2. Insert Retainer Clips to secure the lower portion of the Double Door Frame to the Glass Door.

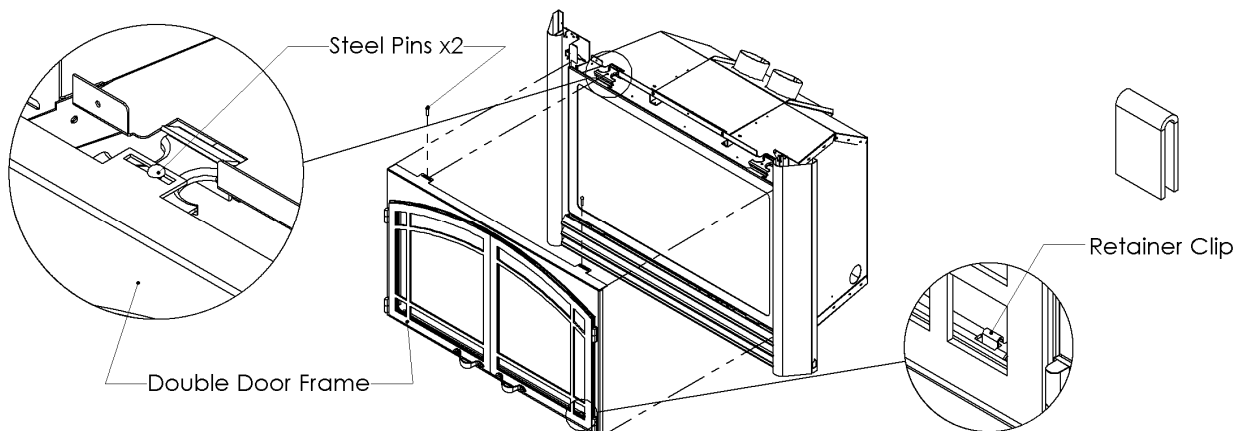

Gas Line Installation

This gas appliance should be installed by a qualified installer in accordance with local building codes and with current CAN/CGA - B149.1 installation codes for Gas Burning appliances and equipment in Canada and the National Fuel Gas Code ANSI Z223 in the U.S.A.

State of Massachusetts

For the state of Massachusetts a T-handle gas shut-off valve must be used on a gas appliance. This T-handle gas shut-off valve must be listed and approved by the state of Massachusetts. This is in reference to the state of Massachusetts state code CMR238.

1. The gas pipeline can be brought in through either the right or left side of the appliance. Knockouts are provided at these locations to allow for the gas pipe installation and testing of any gas connection.
2. The gas control inlet is 3/8" NPT. Typical installation layout for rigid pipe is shown at right.
3. When using copper or flex connector, use only approved fittings. Always provide a union so that gas line can be easily disconnected for burner or fan servicing. See gas specification for pressure details and ratings.
4. When a vertical section of gas pipe is required for the installation, a condensation trap is needed. See CAN/CGA-B149.1 for code details.
5. For natural gas, a minimum of 3/8" iron pipe with gas minimum pressure of 5.5" w.c. must be used for supply from the gas meter. Consult with the local gas utility if any questions arise concerning pipe sizes.
6. Ports are accessible for test gauge connection both on the inlet and outlet of the gas valve.
7. Turn the gas supply ON and check for leaks. **DO NOT USE OPEN FLAME FOR THIS PURPOSE.** Use an approved leak testing solution.
8. The appliance and its individual shutoff valve must be disconnected from the gas supply piping system during any pressure testing of that system at test pressures in excess of 1/2psig [3.5 KPa].
9. The appliance must be isolated from the gas supply piping system by closing its individual shutoff valve during any pressure testing of the gas supply piping system at test pressures equal to or less than 1/2psig [3.5 KPa].

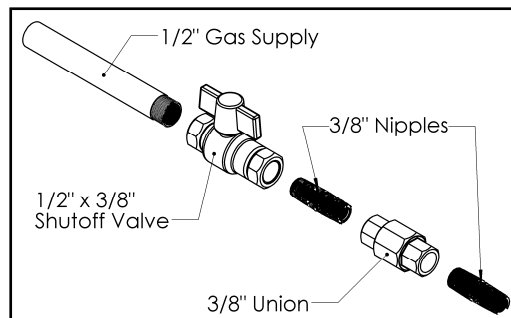

Note: The gas line connection may be made of 1/2" rigid pipe, 1/2" copper pipe or an approved flex connector. Since some municipalities have additional local codes, it is always best to consult your local authorities and the current CAN/CGA - B149.1 installation code in Canada or the National Fuel Gas code ANSI Z223.1 in the U.S.A.

IMPORTANT: Check for gas leaks with a soap and water solution. DO NOT USE OPEN FLAME FOR LEAK TESTING.

Models	IDV33N	IDV33LP	IDV36N	IDV36LP
Fuel	Natural Gas	Propane	Natural Gas	Propane
Gas Control	Millivolt Adjustable			
Maximum Input [BTU]	31,000HI / 20,900LO	28,500HI / 23,100LO	34,250HI / 24,860LO	30,030HI / 22,840LO
Output [BTU]	23,250HI	21,375HI	25,685HI	22,525HI
Orifice Size (0-4500ft)	#35	#51	#32	#50
Air Shutter	3/16"	1/2"	3/16"	1/2"
Gas Inlet Size	S.I.T. 820 Nova, 3/8" NPT			
Gas Supply Pressure	Minimum	Normal	Maximum	
Natural Gas	4.5"	7"	9"	
Liquid Propane	11"	11"	12"	
Manifold Pressure High	3.5" w.c. [0.87KPa] NG		10" w.c. [2.61KPa] LP	
Manifold Pressure Low	1.6" w.c. [0.40KPa]		6.3" w.c. [1.57KPa]	

Burner Installation/Removal

Burner System

1. Remove glass door assembly and logs (if installed). Be careful with logs as they become fragile after being heated.
2. Remove log supports off burner assembly.
3. The burner or burner assembly can now be removed.
 - a. TO REMOVE H-BURNER/ORIFICE CHANGE - Remove the two [2] screws holding the H-Burner in and slide it leftwards off the orifice.
 - b. TO REMOVE BURNER ASSEMBLY - Locate and remove the twelve [12] screws around the outside of the burner pan. This will remove the entire burner assembly.
4. When removing the entire burner assembly, break the seal and lift upwards. Make sure the gas line to the unit has been disconnected.
5. To reinstall the burner assembly ensure the surfaces are cleaned, and old sealant material removed. Use high temp Millpac to seal and secure with the twelve [12] screws.
6. Reconnect the gas line, and reinstall log support, logs, and glass door.

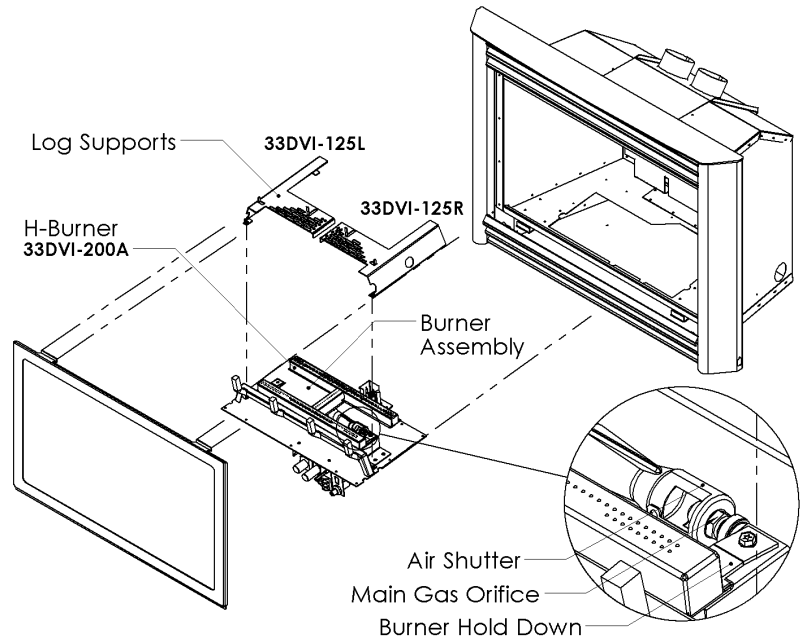

WARNING: Failure to position the parts in accordance with these diagrams or failure to use only parts specifically approved with this appliance may result in property damage or personal injury.

Fan Installation/Removal

Fan System

WARNING

Electrical Grounding Instructions

This appliance is equipped with a three prong (grounding) plug for your protection against shock hazard and should be plugged directly into a properly grounded three-prong receptacle. Do not cut or remove the grounding prong from this.

Before Servicing

1. Ensure all power supply is shut off.
2. Label all wires prior to disconnecting when servicing control. Wiring errors can cause improper and dangerous operation.
3. For fan servicing: Vacuum and clean lint/dirt build-up on the fan blades and motor.
4. When resealing the Fan Access Panel, use High Temp. Silicone or Millpac.

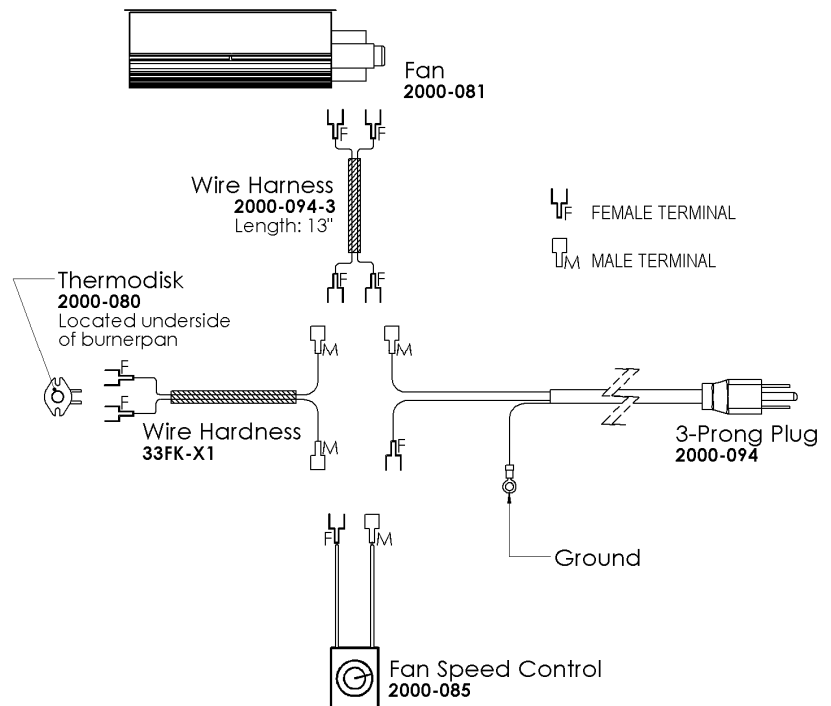

1. Remove glass door assembly and log set if installed. Be sure to handle logs carefully as they become fragile after heated.
2. Remove back air shield by unscrewing (4 screws).
3. Remove fan access panel (15 screws). It is located on the back and bottom right hand corner.
4. Remove the fan from the outer shell (2 screws). The fan needs to be twisted and rotated slightly. The fan's motor end will be lifted out first.
5. Reinstall fan, bracket and all necessary components, as shown below, once completed.
6. Verify proper operation after servicing.

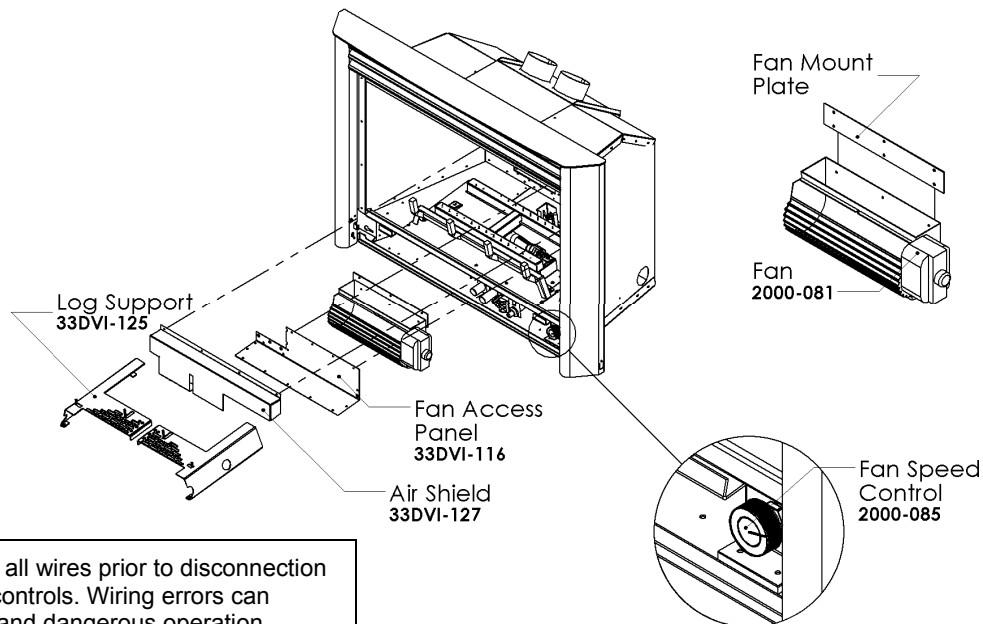



Caution: Label all wires prior to disconnection when servicing controls. Wiring errors can cause improper and dangerous operation. Verify proper operation after servicing.

IDV33/IDV36 Insert Burner Component List

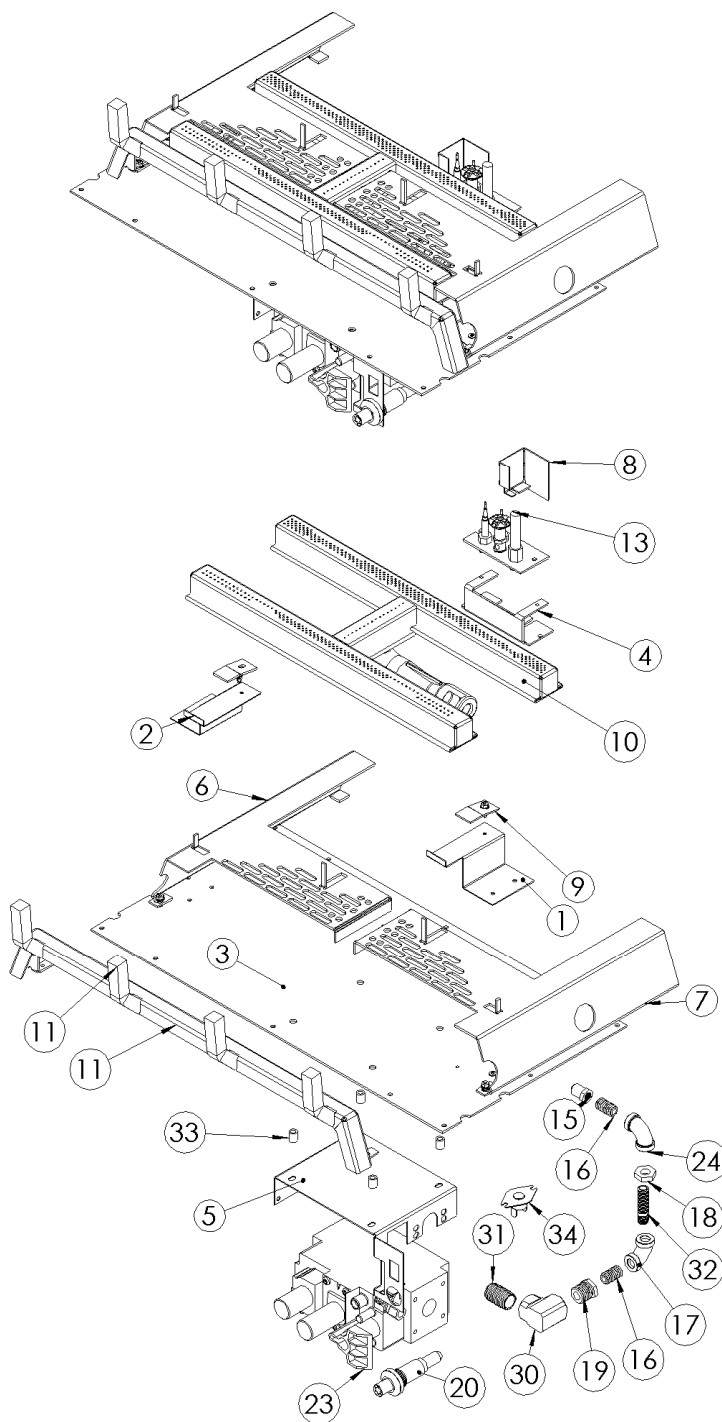
ITEM NO.	PART	DESCRIPTION	Qty.
1	3620-105	Burner Bracket	1
2	3620-105L	Burner Bracket	1
3	DVI33-107	Burner Pan	1
4	3620-111	Pilot Bracket	1
5	6000-112-1	Valve Bracket	1
6	DVI33-125L	Burner Trim Plate	1
7	DVI33-125R	Burner Trim Plate	1
8	DVI33-129	Pilot Shield	1
9	4200-132	Burner Hold Down	2
10	350-210	Front Burner Tube	1
10	350-211	Rear Burner Tube	1
10	5000-213	Burner Crossover Tube	1
10	5000-214	Crossover Bottom	1
10	5000-215	Burner Bottom	2
10	1001-281	Short Mixing Tube	1
11	2000-224	Grate Bar Holder	1
11	38VF-119	Grate Bar	4
13	1001-P713SI (LP)	Pilot Assembly – LP	1
13	1001-P714SI (NG)	Pilot Assembly – NG	1
15	1000-255	1/8 Orifice	1
16	1000-253	1/8 x 3/4 Closed Nipple	2
17	2000-213	1/8 90° Elbow	1
18	1000-P203VE	1/8 Brass Lock Nut	1
19	1000-P202VE	3/8 x 1/8 Bushing	1
20	1000-214	Piezo Igniter	1
21	1000-215	Piezo Pal Nut (18x1.5mm)	1
23	1000-P633SI (LP)	Valve – LP	1
23	1001-P634SI (NG)	Valve – NG	1
24	2000-213	1/8 90° Elbow	1
25	36HB-165	Rock Box Base	1
26	36HB-166	Rock Box Top	1
27	6000-225	Ember Plate	2
28	6000-226	Ember Plate Bridge	1
29	DVI33-167	Back Rock Support	1
30	ELBO90-500	3/8 90° Brass Elbow FPT	1
31	3/8 x 1 C. Nipple	3/8 Brass Nipple	1
32	1/8 x 1-1/2 Nipple	1/8 x 1-1/2 Brass Nipple	1
33	3/8 Spacer	5/16OD x 3/16ID x 3/8 Spacer	4
34	2000-080	Snap Disc	1



IDV 33
#35 BRASS CAP ORFICE - NATURAL

SET PRIMARY AIR .187" (3/16")

IDV 33
#51 BRASS CAP ORFICE - PROPANE

SET PRIMARY AIR .500" (1/2")

IDV 36
#32 BRASS CAP ORFICE - NATURAL

SET PRIMARY AIR .187" (3/16")

IDV 36
#50 BRASS CAP ORFICE - PROPANE

SET PRIMARY AIR .500" (1/2")

Millivolt System, Lighting, and Burner Control

FOR YOUR SAFETY READ BEFORE LIGHTING

WARNING: If you do not follow these instructions exactly, a fire or explosion may result causing property damage, personal injury or loss of life.

BEFORE LIGHTING

- A This appliance has a pilot which must be lighted by hand. When lighting the pilot, follow these instructions exactly.
 - Immediately call your gas supplier from a neighbour's phone. Follow the gas supplier's instructions.
- B Smell all around the appliance area for gas. Be sure to smell next to the floor because some gas is heavier than air and will settle on the floor.
 - If you cannot reach your gas supplier, call the fire department.
- C Use only your hand to push or turn the gas control knob. Never use tools. If the knob will not push in or turn by hand, don't try to repair it. Call a qualified technician. Force or attempted repair may result in a fire or explosion.
- D Do not use the appliance if any part has been under water. Immediately call a qualified service technician to inspect the appliance and to replace any part of the control system which has been under water.

WHAT TO DO IF YOU SMELL GAS

- Do not try to light an appliance.
- Do not touch any electrical switch; do not use any phone in your building.

LIGHTING INSTRUCTIONS

1. Stop! Read the safety information above this label.
2. Set the thermostat to lowest setting.
3. Turn off all electrical power to the appliance.
4. Locate valve under the burner assembly.
5. If the control knob is not already in the off position, i.e. the word "OFF" in the 9 o'clock position, then push in the gas control knob slightly and turn ⤵ clockwise to "OFF". NOTE: Knob cannot be turned from "PILOT" to "OFF" unless knob is pushed in slightly. Do not use force.
6. Wait five [5] minutes to clear out any gas. If you then smell gas. STOP! Follow "B" in the safety information above on this label. If you don't smell gas then go to the next step.
7. Now push in the control knob slightly and turn ⤴ counter-clockwise to the "PILOT" position.
8. Push in the control knob all the way and hold it. With the other hand push in the red ignitor button until you hear a click. Now observe closely the pilot burner located on the rear center-left hand side of the main burner. If a flame has appeared then continue to depress the control knob for 20 seconds. If the flame did not appear then continue to depress the red ignitor button every 5 seconds until a flame is established. NOTE: If after 30 seconds a flame has not yet been established then turn the control knob back to the off position and repeat steps 5, 6 & 7.
9. Once the pilot has been established hold the control knob in the depressed position for approximately 25 seconds before releasing. If the flame goes out then repeat steps 7 and 8.
10. Now turn the control knob to the "ON" position. The burner will not light unless the wall switch thermostat or remote control is turned "ON" or in the case of the thermostat there is a call for heat.
11. Close the access door and turn all electrical power back to the appliance.

TO TURN OFF THE APPLIANCE

1. Set the thermostat to lowest setting.
2. Turn off all electric power to the appliance if service is to be performed.
3. Open the control access door.
4. Push in the gas control knob slightly and turn ⤵ clockwise to the "OFF" position. Do not force.
5. Replace control access panel.

Recommended Maximum Lead Length (Double Wire)
When Using Wall Switch or Thermostat

Wire Size	Max. Length
14ga	100ft [30.4m]
16ga	64ft [19.5m]
18ga	40ft [12.1m]
20ga	25ft [7.6m]
22ga	15ft [4.5m]

CAUTION: DO NOT WIRE 120V POWER TO MILLIVOLT SWITCHES OR THERMOSTAT.

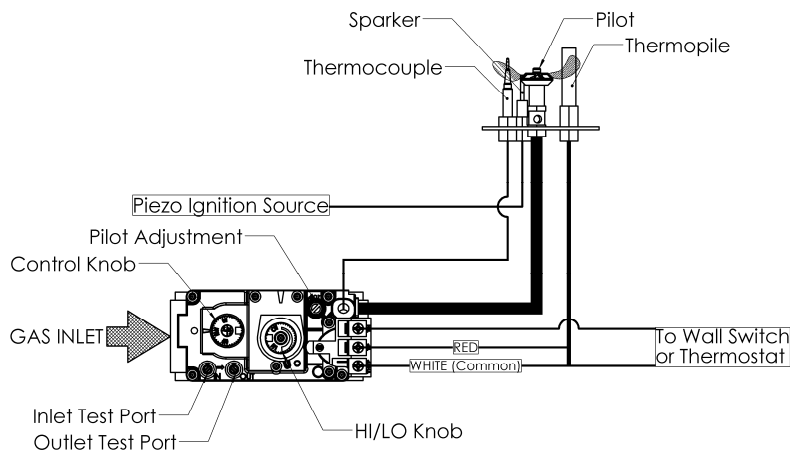

IPI Electronic Ignition System

Overview

The IPI system is an advanced burner controller that provides you with the option of having either a Standing-Pilot, or an intermittent igniting system. This alternating mode is controlled by the CPI/IPI Switch (Continuous Pilot Ignition/Intermittent Pilot Ignition) located on the IPI System Box. The difference between a Standing-Pilot and an Intermittent-Pilot is in whether the pilot stays lit or shuts off:

In Standing-Pilot, the pilot assembly is lit by the IPI Main Module and continues to stay lit until 1) the CPI/IPI Switch is switched to the IPI position; 2) a loss of electrical power (battery and AC source), 3) the flame sensor loses its signal, 4) the fuel supply discontinues, or 5) the IPI Main Module malfunctions.

In the Intermittent-Pilot mode, the pilot shuts off when the appliance is not in use. The advantage of this mode is that fuel is not consumed when the fireplace is not operating.

NOTE: In some jurisdiction, Intermittent-Pilot is required. That means the pilot cannot remain lit when the appliance is not operating.

Components

The core of the IPI system is the Main Module and the IPI Valve. With these two components the system is able to operate a gas fireplace. There are also other components available to complement the IPI system.

IPI System Cover: Is essential in keeping the components at their proper operating temperatures. **DO NOT OPERATE THE APPLIANCE WITHOUT THIS COVER.**

Modulating Servo Motor: Is an add-on valve component that permits HI/LO functionality to be controlled by the remote. Contrary to this feature is a Manual HI/LO Control Knob. The Modulating Servo Motor requires the Remote system to be present.

Backup Battery Pack: This component permits the IPI system to operate without the need for an external AC Adapter power source. The advantage to using the battery backup is that in the case of a power failure, the appliance is still operable.

NOTE: In certain instances the IPI Main Module requires resetting. This can occur if the system is unable to ignite the pilot or the main burner in the allotted time period. The IPI is programmed to lockout all commands. To reset this lockout you must deplete the system of all electrical power. This means to remove the batteries from the Battery Pack, remove the batteries from the Remote Receiver (if applicable), and disconnect the AC Adapter from the system. Leave the power off for approximately 25 seconds to clear its lockout.

Remote Receiver: This component provides the capability of controlling the appliance with a wireless remote transmitter. There are two switches to note on the receiver module:

The first switch on the Remote Receiver module is a 3-position slide switch. This switch is used to either manually turn the main burner ON, activate the receiver to begin communication with the transmitter, or turn the main burner completely OFF. The position of the slide switch designates these functions respectively.

The second is the small round pushbutton [PRG] used for programming the receiver to respond to a designated remote. Therefore to program the system ensure that the transmitter is first turned OFF. Then, ensure that there is sufficient

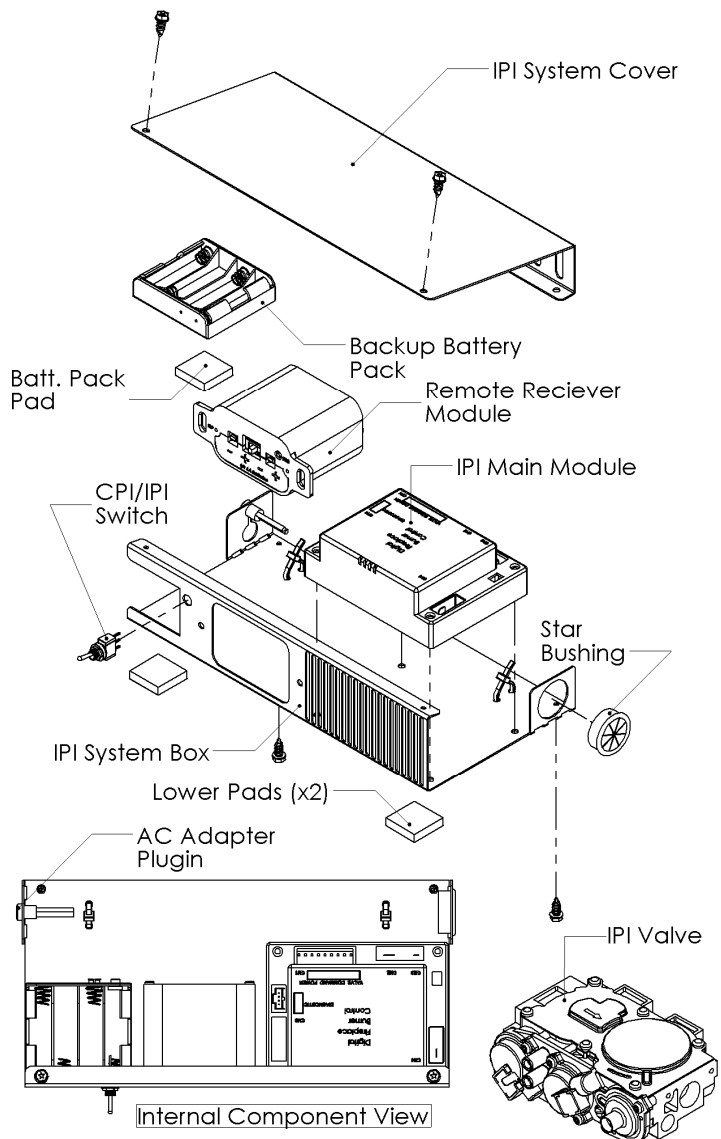

electrical power going to the Receiver module and a fresh set of batteries in the transmitter. Now switch the slide switch to the middle [REMOTE] position and then push the small pushbutton to begin programming. Bring the transmitter close to the receiver and then press the power button [⏻] on the transmitter. An audible beep will sound to indicate the system is programmed and ready to be used.

NOTE: The Remote Receiver module can also be located outside of the appliance to a maximum of 6ft away installed in a certified deep wall switch electrical box (2-3/4" depth). For this configuration an extension wiring harness (P/N: 1001-P904SI) is required.

Electrical Supply in Series: The entire IPI system can be powered by a single power source (i.e. by the AC Adapter). This is advantageous if you do not want to supply extra batteries. To achieve this simply connect the AC Adapter into the Remote Control wiring harness instead of the main IPI harness. From the Remote wiring harness, use its male plug-in connector and connect it to the female plug-in in the main IPI harness. Now the circuit is complete. So the way it works is that electrical power is supplied to the Remote Receiver module and then proceeds to the Main IPI module. Furthermore, note that a Backup Battery Pack is not required in this configuration. Instead, batteries in the Remote Receiver act as the backup supply.

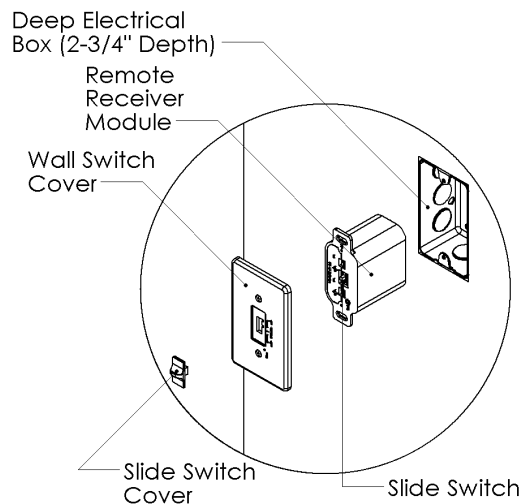

Junction Box Location

The electrical junction box must be located on the outside of the appliance near the bottom as shown in the illustration to the right. Be sure to follow local electrical codes when install the junction box.

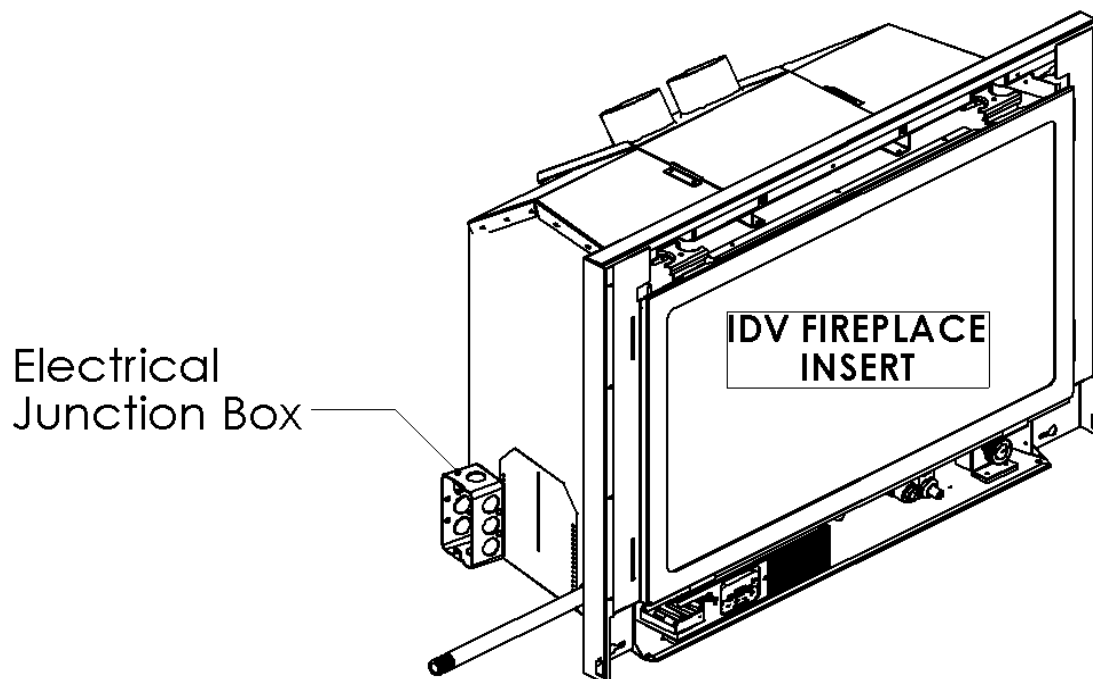

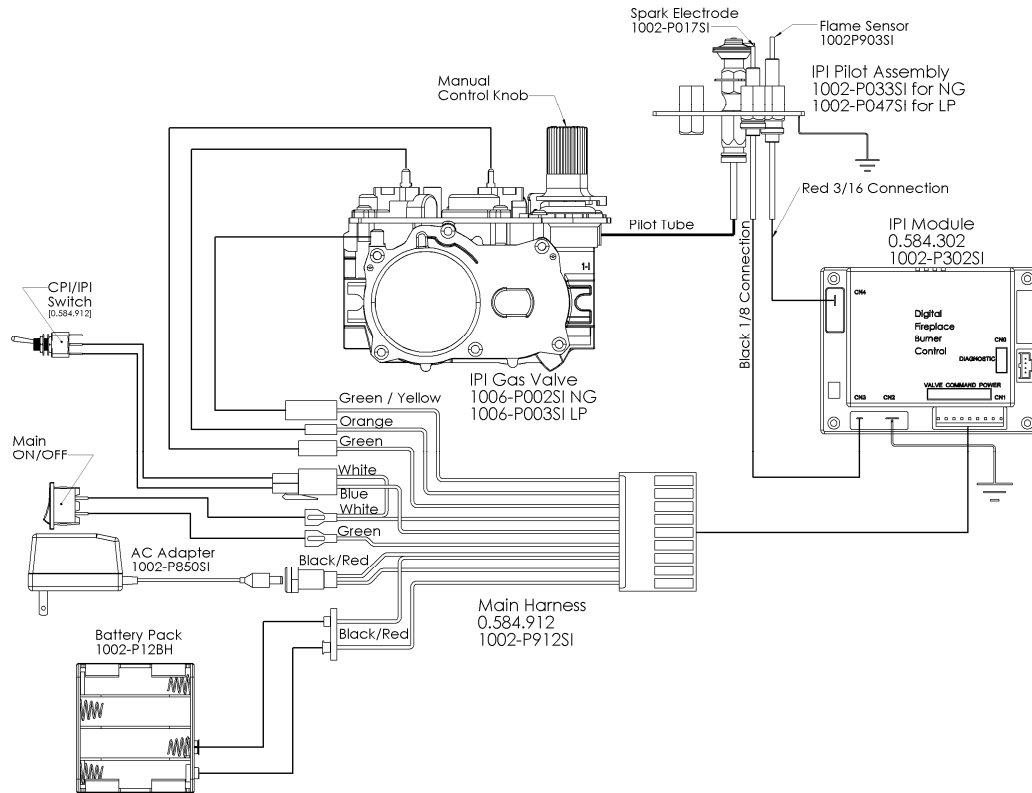

Configuration #1: Basic manual HI/LO and manual ON/OFF capabilities.

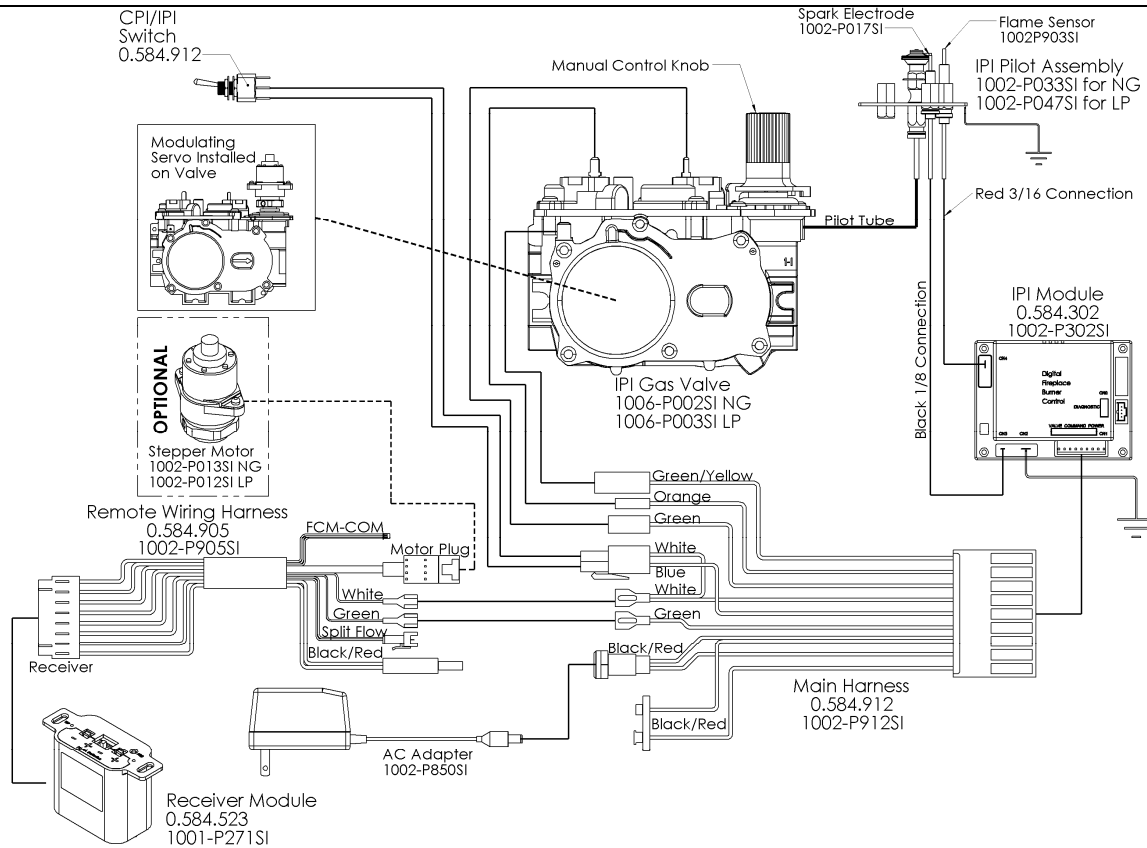

Configuration #2: Remote ON/OFF and manual HI/LO capabilities. OPTIONAL: For units with remote HI/LO capabilities, a modulating servo is required to be installed on the valve. The connectors to this servo must be connected to the Remote Harness as shown in the figure above.

IPI Lighting Instructions



WARNING

1. If you do not follow these instructions exactly, a fire or explosion may result causing property damage, personal injury or loss of life.
2. Always light the pilot whether for the first time or if the gas supply has ran out with the glass door opened or removed.

FOR YOUR SAFETY READ BEFORE LIGHTING

- A. This fireplace is equipped with an ignition device which automatically lights the pilot. Do not try to light by hand.
- B. Before operating smell all around the fireplace area for gas and next to the floor because some gas is heavier than air and will settle on the floor.
- C. Do not use this fireplace if any part has been under water. Immediately call a qualified service technician to inspect the fireplace and replace any part of the control system and any gas control which has been under water.

WHAT TO DO IF YOU SMELL GAS

1. Turn off all gas to the fireplace.
2. Open windows.
3. Do not try to light any appliance.
4. Do not touch any electric switch; do not use any phone in your building.
5. Immediately call your gas supplier from a neighbor's phone. Follow the gas supplier's instructions.
6. If you cannot reach your gas supplier, call the fire department.

LIGHTING INSTRUCTIONS

1. STOP! Read the above safety information on this label.
2. Remove batteries from Receiver and/or Battery Backup Pack.
3. Turn off all electric power to the fireplace.
4. This fireplace is equipped with an ignition device which automatically lights the pilot. Do not try to light the pilot by hand.
5. Open the glass door.
6. Turn manual shutoff valve clockwise ⤵ to OFF position (located behind the access panel).
7. Wait five [5] minutes to clear out any gas. If you smell gas including near the floor, STOP! Follow "B" in the above safety information on this label. If you don't smell gas go to the next step.
8. Turn manual shutoff valve counter-clockwise ⤴ to ON position.
9. Close the glass door.
10. Turn on all electric power to the fireplace, and re-install batteries into the Transmitter/Receiver and/or Battery Backup Pack.
11. Turn ON the switch that operates the Main Burner. If using a Remote Control refer to Remote Control Operation Manual for activation.

TO TURN OFF GAS

1. Turn OFF all electric power to the fireplace if service is to be performed, including removing batteries from the Remote Transmitter/Receiver and/or Battery Backup Pack.
2. Access door inside the firebox must be removed to access the manual shutoff valve.
3. If alternate shut-off valve was installed it can be shutoff instead of going through the fireplace to access the fireplace shut off valve.

Log Placement – LOGF35

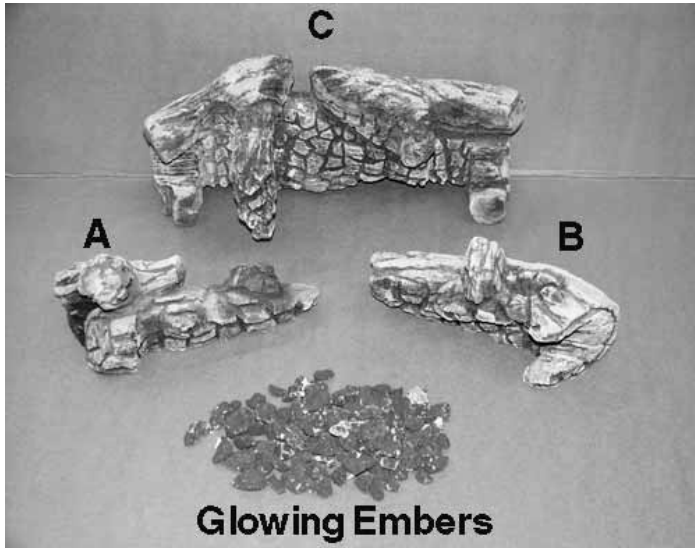

LOGF35 Log Set and Glowing Embers Parts List

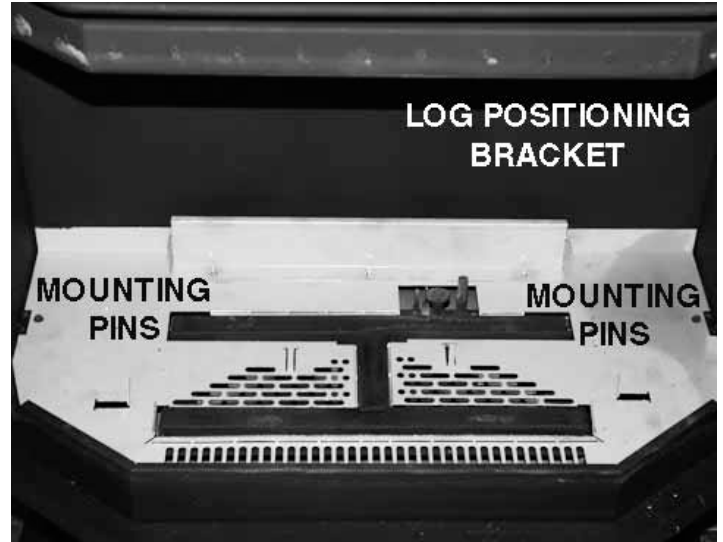

This illustration shows the rear log positioning bracket and 4 pin locating positions.

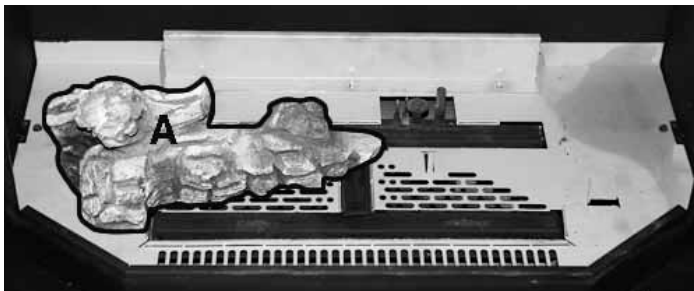

Log A has 2 locating holes. Position those 2 holes over the 2 pins on the left side of the log mounting pan as shown in the picture above.

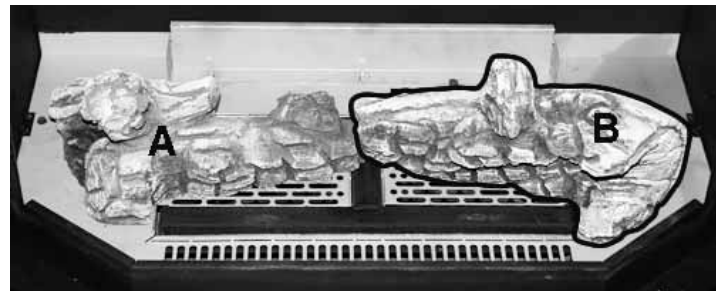

Log B has 2 locating holes. Position those 2 holes over the 2 pins on the right side of the log mounting pan as shown in the picture above.

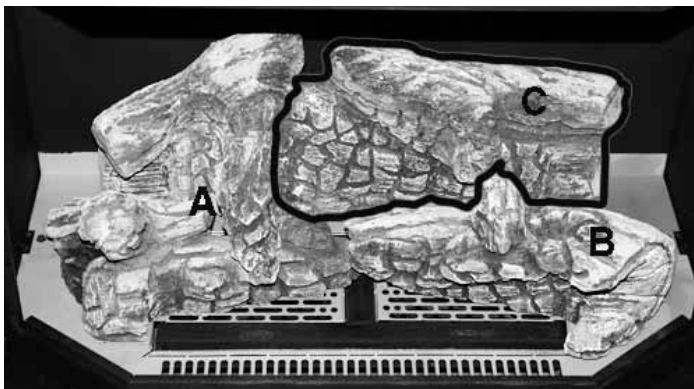

Log C has to be lowered into position just behind Logs A and B. Log C shall be pulled up to Logs A and B as shown in the picture above.

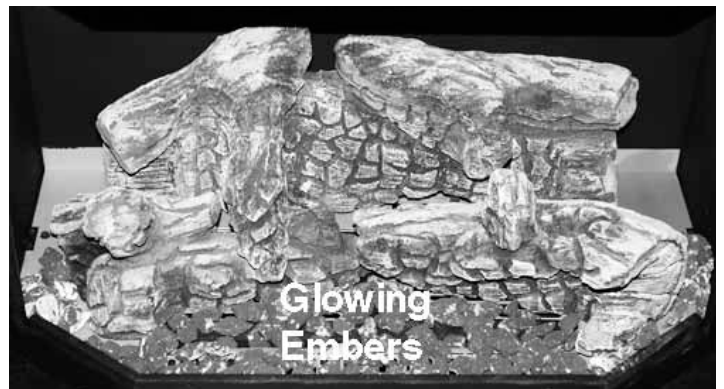

A bag of Ember Chunks is supplied with the Log set. It is very important that these chunks are placed onto the front burner and log mounting pan as shown in the picture. Spread the Ember Chunks out no more than one layer deep. **NOTE: If you do not follow these instructions correctly then sooting problems can occur.**

Log Placement – LOGF36



LOGF36 Log Set includes Glowing Embers, Lava Rock, and Vermiculite.

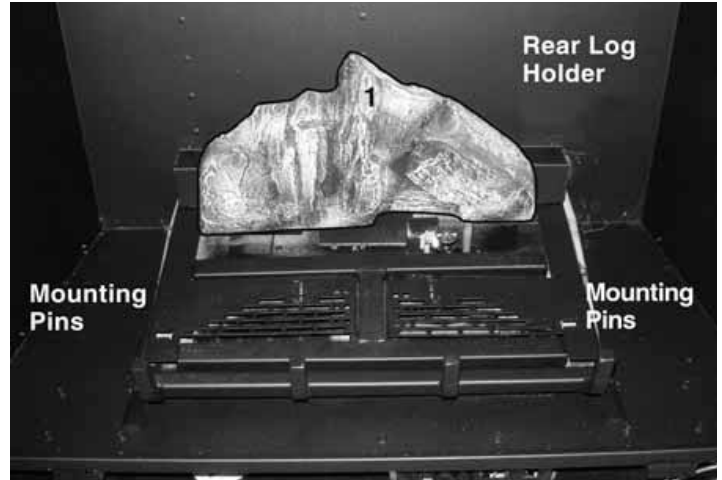

Place Log #1 onto rear log holder and center.



Place Log #2 onto left side of Log #1. Place Log #3 onto right side of Log #1.



Locate 2 holes on bottoms of Logs #4 and #5, and position onto mounting pins.



Locate 1 hole on the bottom of Log #6 and place it onto pin of Log #2. Locate 2 holes on the bottom of Log #7 and place onto the pins of Log #5.

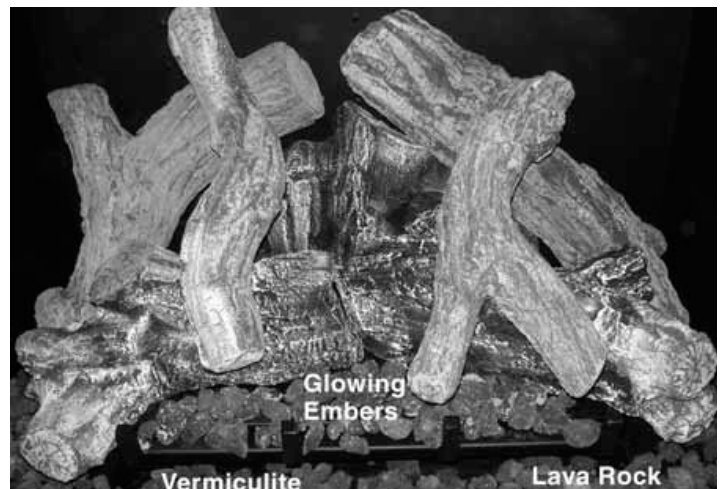

Place Glow Ember Kit onto front burner tube and ember plates. **Lava Rock and Vermiculite are to be placed onto firebox ONLY.**

MQROCK1/MQRSP4 for IDV33/IDV36



MQRSP4 Parts List

1Ea Rock Support

1Ea Ember Plates Assembly

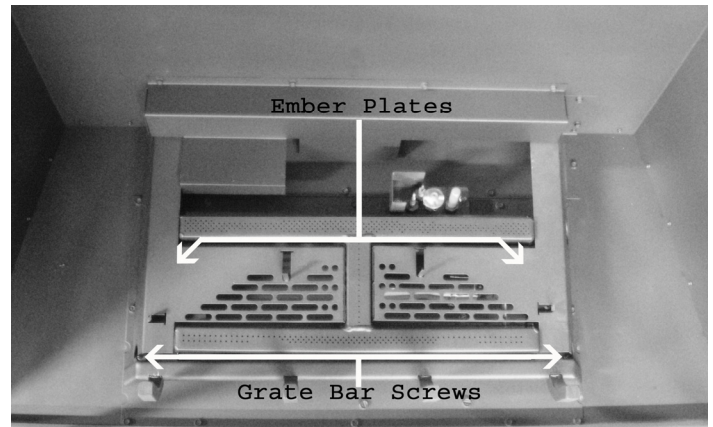

Remove the ember plates and the grate bar by removing the 2 left and right screws on the grate bar.
Reinstall screws after removing parts.



Place the MQRSP4 Rock Platform and ember plates into place as shown in the illustration above.

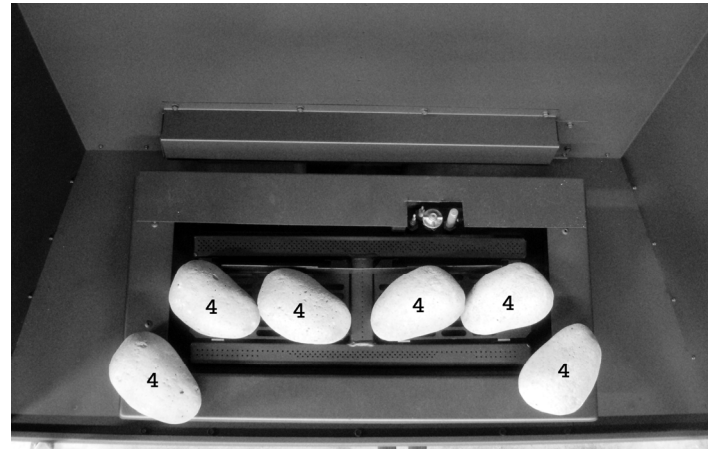

Step 1: Place Rocks #4 into position as shown. **Be sure not to place them directly over top of the burner tube.**

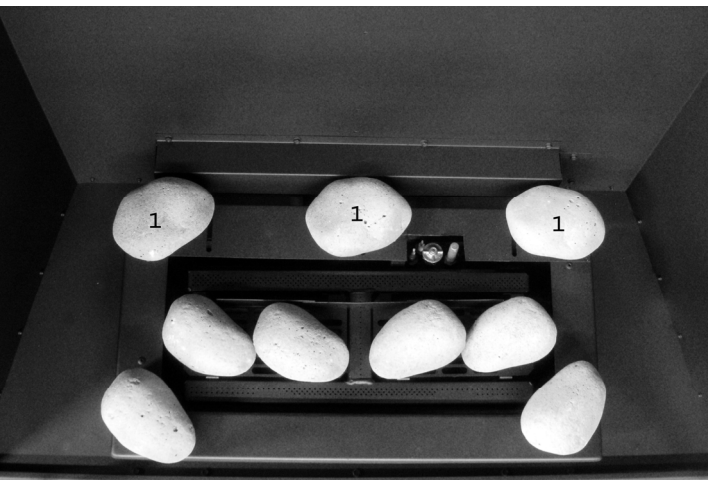

Step 2: Place Rocks #1 into position as shown above.

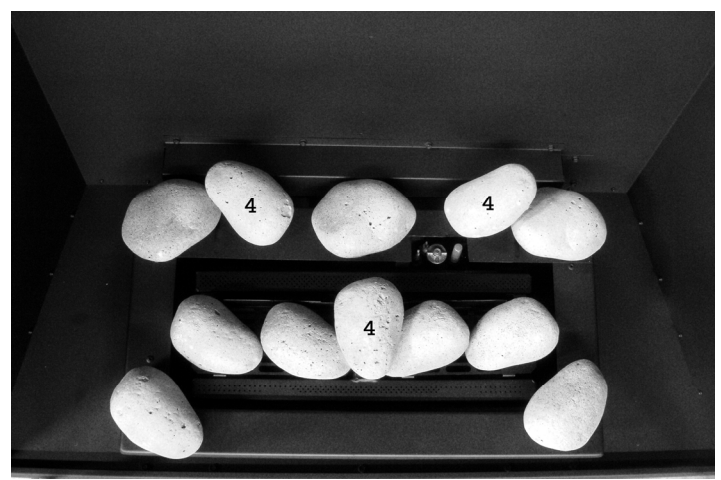

Step 3: Place Rocks #4 into position as shown above.

MQROCK1/MQRSP4 for IDV33/IDV36 (continue)

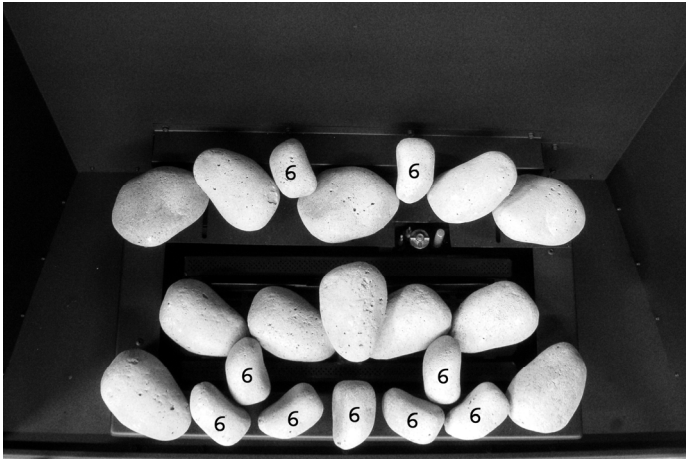

Step 4: Place Rocks #6 into position as shown above.



Step 5: Place Rocks #3 into position as shown above.

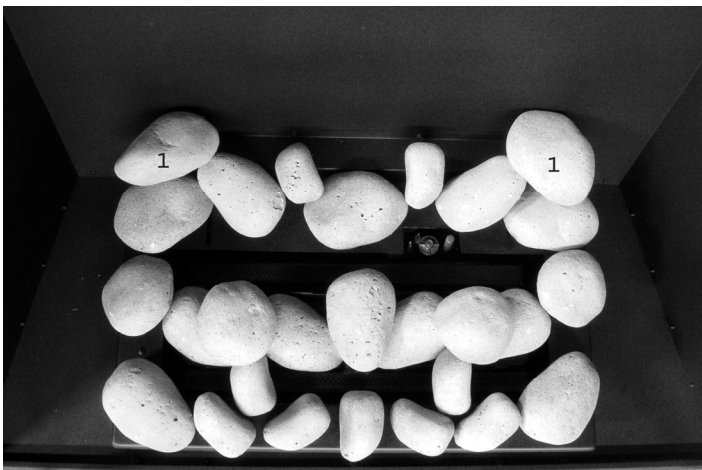

Step 6: Place Rocks #1 into position as shown above.



Step 7: Place Rocks #3 and #4 into position as shown above.



Finished Rock Set and Burn

NOTE: If flame impingement on the rocks causes sooting then you may have to move, or remove, one or more rocks. DO NOT PLACE ROCKS DIRECTLY OVER TOP OF THE BURNER TUBE.

Conversion Kit Instructions – PART A

PLEASE CONFIRM THAT STEP 4 IS UNDERSTOOD BEFORE PROCEEDING WITH CONVERSION.



WARNING: This conversion kit shall be installed by a qualified service agency in accordance with the manufacturer's instructions and all applicable codes and requirements of the authority having jurisdiction. If the information in these instructions is not followed exactly, a fire, explosion or production of carbon monoxide may result causing property damage, personal injury or loss of life. The qualified service agency is responsible for the proper installation of this kit. The installation is not proper and complete until the operation of the converted appliance is checked as specified in the manufacturer's instructions supplied with the kit.

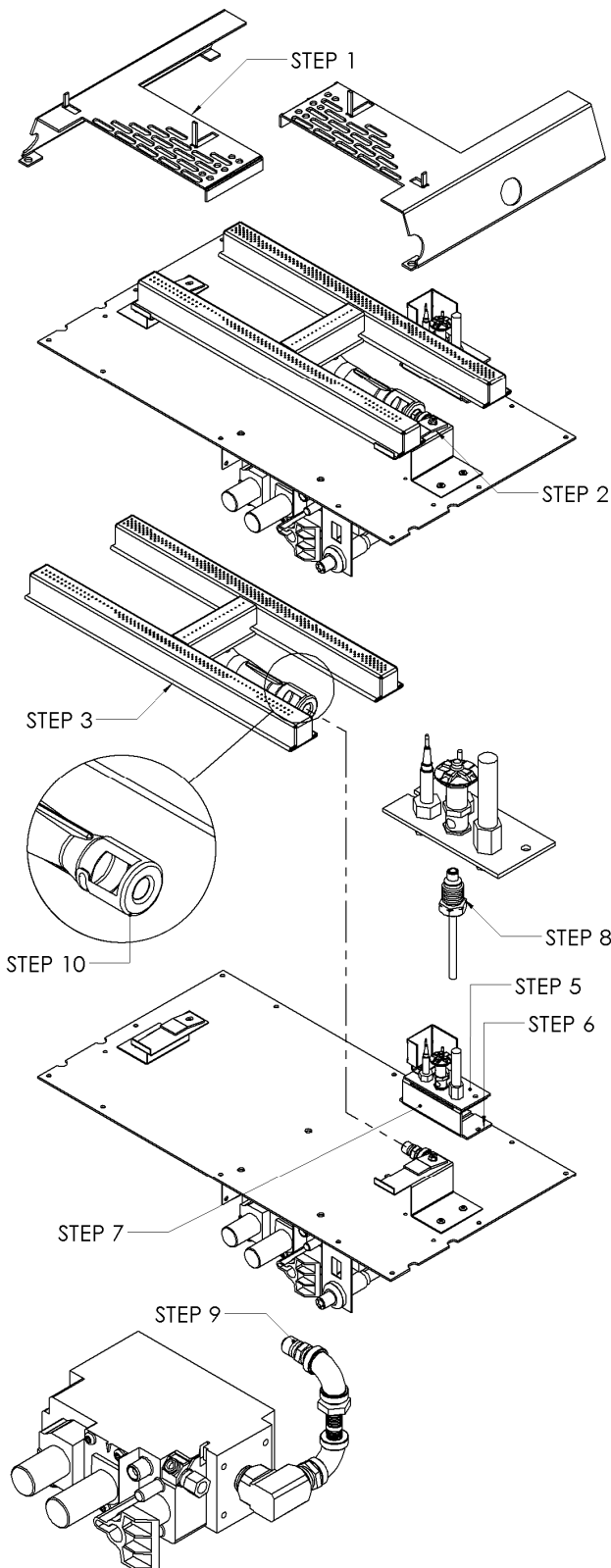

1. Remove the 2 ember plates from the burner. This step may not be required, depending on the type of burner assembly.
2. Loosen the 2 screws holding the burner in place.
3. Slide the burner to the left to expose the orifice.
4. **Before going any further you need to verify which pilot system is in use. If there is a spring clip below the pilot hood then proceed to STEP 5 in PART B on the next page.**
5. Remove the 2 screws that hold the pilot to the bracket.
6. Remove the 2 screws that attach the pilot bracket to the firebox bottom.
7. Remove the pilot bracket to expose the pilot assembly.
8. Remove the pilot tube and nut from the pilot assembly using a 10mm wrench; slide the tube and nut down. You may have to tap the pilot hood lightly to release the pilot orifice. Place new pilot orifice into the pilot assembly and reinstall the pilot tube and nut. Tighten with wrench. Reinstall pilot bracket at this time.
9. Remove main orifice using a 1/2" wrench and replace with new conversion orifice.
10. Adjust the primary air setting to the correct setting as specified in the manual or label plate. To adjust the air setting, loosen the screw on the side of the tube and rotate to the correct opening using a drill bit or tape measure. Retighten screw. Reinstall burner at this time reversing STEPS 3, 2 and 1.
11. Follow instructions supplied with the conversion HI/LO to convert the valve from one type of fuel to the other.
12. Check for gas leaks around the pilot burner tube and face of valve.
13. Attach conversion label to label plate on bottom of unit, writing information as needed.

Gas Conversion for Top Convertible Pilot (Series 019065X) – PART B

Instructions for converting SIT 190 series pilot burner injection from NG to LPG and from NG to LPG only. This information should be considered as supplemental to the Appliance Manufacturer's Instructions.

⚠ WARNING: The installation of this conversion kit must only be undertaken by a qualified and certified gas appliance installer.

1. Shut off the gas supply to the appliance.
2. Allow the pilot burner to cool to room temperature.
WARNING: Touching a hot pilot burner can result in injury.
3. The pilot hood is held in place by spring pressure. Remove the hood by pulling it directly up from the pilot bracket (a).
4. Insert a 5/32" or 4mm Allen wrench into the hexagonal key-way of the injector (b), and rotate it ⤵ counter-clockwise until it is free of the injector journal (c).
5. Verify that the new injector is proper for the application. The injector size is stamped on the side of the injector near the top. LPG injectors have a groove machined around their circumference near the top, while NG injectors do not have a groove (e). Refer to the Appliance Manufacturers instruction sheet for the proper injector size.
6. Insert the Allen wrench into the end of the injector. Then, insert into injector journal, and rotate the injector clockwise until a torque of 9 in-lbs is achieved.
7. Replace the pilot hood by aligning the tab on the base of the hood with the slot in the side of the pilot journal, and push the hood down, directly onto the pilot bracket (d). The hood must sit squarely on the bracket for proper operation. Check to insure that the hood is properly seated onto the pilot bracket.

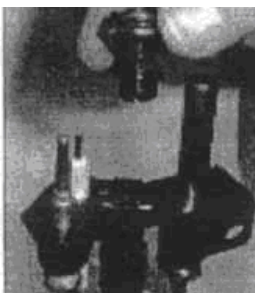

(a)

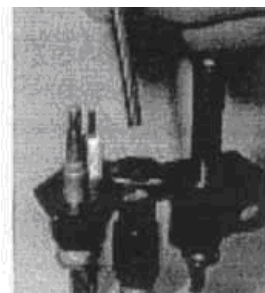

(b)

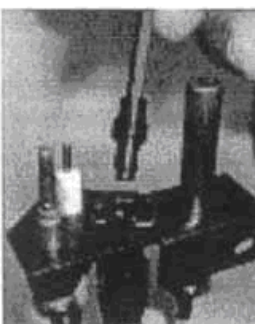

(c)

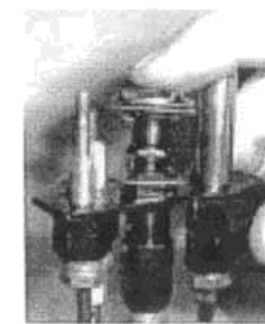

(d)

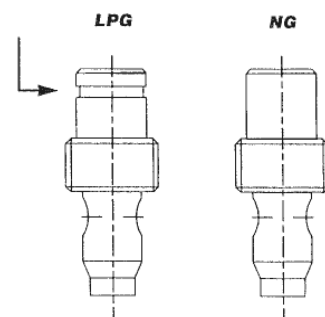

(e)



SIT Group

⚠ WARNING: This conversion kit must only be applied as part of a conversion kit supplied by the appliance Manufacturer for the specific appliance, and type of gas being converted.

INSTALLER NOTICE: These instructions must be left with appliance.

IDV33 Parts List

Part No.	Description
Fireplace Base Unit	
IDV33N [Millivolt]	INSERT DIRECT VENT FIREPLACE
IDV33NE [IPI]	Natural Gas 31,500 BTU
IDV33LP [Millivolt]	INSERT DIRECT VENT FIREPLACE
IDV33LPE [IPI]	Liquid Propane 28,500 BTU

Fireplace Requirements (Required for Each Unit)

Log Sets	
LOGF35	Log Set Fiber Split Oak (350 Series)
MQROCK1	Rock Set
QMRSP4	Rock Platform, Support, Embers, Plates, Bridge

Front Face Attachments

I33CVBL	Clean View Front Style 1 [Black]
I33CVPW	Clean View Front Style 1 [Pewter]
I33CVCV	Clean View Front Style 1 [Copper Vane]
I33LK	Louvered Front [Black]

Fireplace Accessories for I33CV Fronts

I33CV Surround Kits for CleanView

I33SS1BL	Straight Surround Back Extension [Black]
I33SS1PW	Straight Surround Back Extension [Pewter]
I33SS1CV	Straight Surround Back Extension [Copper Vane]
I33SA1BL	Arch Surround Back Extension [Black]
I33SA1PW	Arch Surround Back Extension [Pewter]
I33SA1CV	Arch Surround Back Extension [Copper Vane]
I33SPF1BL	Picture Frame Surround Extension [Black]

Fireplace Accessories for I33LK Fronts

I33LK Surround Kits for Louvered Front

I33S3426B	Top Piece Only
I33S4028B	Top and Sides
I33S4430B	Top and Sides
I33S4535B	Universal (for custom applications)

I33LK Grills for Louvered Front

Z6GBA	Grill Kit – Classic Builder Antique Brass
Z6GBC	Grill Kit – Classic Builder Chrome
Z6GBP	Grill Kit – Classic Builder Polish Brass
VI30GBL	Grill Kit – Black
VI30PBL	Panel Grill Kit – Black

Fireplace Accessories for IDV33 (Both Front Kits)

Door Frames Overlays

Z33ADDX	Arch Door Frame – Deluxe Black (352)
Z33ADTH	Arch Door Frame – Top Half Black (353T)
Z33ADDA	Arch Door Frame – Double Arch Black (354)
Z33ADDD	Arch Door Frame – Double Door Arch Black (355)

Designer Doors for IDV33

Z33DDA1BL	Designer Door Arch – Series 1 – Black
Z33DDTA1A	Trim – Antique for Designer Arch – Series 1
Z33DDTA1C	Trim – Chrome for Designer Arch – Series 1
Z33DDTA1P	Trim – Polish Brass for Designer Arch – Series 1
Z33DDS1BL	Designer Door Straight – Series 1 – Black
Z33DDTS1A	Trim – Antique for Designer Straight – Series 1
Z33DDTS1C	Trim – Chrome for Designer Straight – Series 1
Z33DDTS1P	Trim – Polish Brass for Designer Straight – Series 1

Brick and Porcelain Liners

IDV33RL	Brick Liner
IDV33PL	Porcelain Liner

Conversion Kits for IDV33

IDV33 Conversion Kits

33IDV-CKNG	Conversion Kit Natural Gas (IDV33N) [Millivolt]
33IDV-CKLP	Conversion Kit - Liquid Propane (IDV33LP) [Millivolt]
33IDV-CKNGI	Conversion Kit Natural Gas (IDV33NE) [IPI]
33IDV-CKLPI	Conversion Kit - Liquid Propane (IDV33LPE) [IPI]

IDV36 Parts List

Part No.	Description
Fireplace Base Unit	
IDV36N [Millivolt]	INSERT DIRECT VENT FIREPLACE
IDV36NE [IPI]	Natural Gas 34,250 BTU
IDV36LP [Millivolt]	INSERT DIRECT VENT FIREPLACE
IDV36LPE [IPI]	Liquid Propane 30,030 BTU

Fireplace Requirements (Required for Each Unit)

Log Sets	
LOGF36	Log Set Fiber Split Oak
MQROCK1	Rock Set
QMRSP4	Rock Platform, Support, Embers, Plates, Bridge

Front Face Attachments

I36CVBL	Clean View Front Style 1 [Black]
I36CVPW	Clean View Front Style 1 [Pewter]
I36CVCV	Clean View Front Style 1 [Copper Vane]
I36LK	Louvered Front [Black]

Fireplace Accessories for I36CV Fronts

I36CV Surround Kits for CleanView

I36SS1BL	Straight Surround Back Extension [Black]
I36SS1PW	Straight Surround Back Extension [Pewter]
I36SS1CV	Straight Surround Back Extension [Copper Vane]
I36SA1BL	Arch Surround Back Extension [Black]
I36SA1PW	Arch Surround Back Extension [Pewter]
I36SA1CV	Arch Surround Back Extension [Copper Vane]
I36SPF1BL	Picture Frame Surround Extension [Black]

Fireplace Accessories for I36LK Fronts

I36LK Surround Kits for Louvered Front

I36S3931B	Top Piece Only
I36S4432B	Top and Sides
I36S4736B	Universal (for custom applications)

I36LK Grills for Louvered Front

IDV36GBA	Grill Kit – Classic Builder Antique Brass
IDV36GBC	Grill Kit – Classic Builder Chrome
IDV36GBP	Grill Kit – Classic Builder Polish Brass
IDV36GBL	Grill Kit – Black
IDV36PBL	Panel Grill Kit – Black

Fireplace Accessories for IDV36 (Both Front Kits)

Door Frames Overlays

HB36ADTH	Arch Door Top Half Black
HB36ADDX	Arch Door Frame – Deluxe Black
HB36ADDA	Arch Door Frame – Double Arch Black
HB36ADDD	Arch Door Frame – Double Door Arch Black
HB36CSS	Child Safety Screen – 36" DV Fireplaces

Designer Doors for IDV36

HB36DDA1BL	Designer Door Arch – Series 1 – Black
HB36DDTA1A	Trim – Antique for Designer Arch – Series 1
HB36DDTA1C	Trim – Chrome for Designer Arch – Series 1
HB36DDTA1P	Trim – Polish Brass for Designer Arch – Series 1
HB36DDS1BL	Designer Door Straight – Series 1 – Black
HB36DDTS1A	Trim – Antique for Designer Straight – Series 1
HB36DDTS1C	Trim – Chrome for Designer Straight – Series 1
HB36DDTS1P	Trim – Polish Brass for Designer Straight – Series 1

Brick and Porcelain Liners

IDV36RLT	Traditional Brick Liner
IDV36RLH	Herringbone Brick Liner

Conversion Kits for IDV36

IDV36 Conversion Kits

36IDV-CKNG	Conversion Kit Natural Gas (IDV36N) [Millivolt]
36IDV-CKLP	Conversion Kit - Liquid Propane (IDV36LP) [Millivolt]
36IDV-CKNGI	Conversion Kit Natural Gas (IDV36NE) [IPI]
36IDV-CKLPI	Conversion Kit - Liquid Propane (IDV36LPE) [IPI]

Parts for IDV33 and IDV36

Part No.	Description
Riser Kits	
I33R40	2-1/2" Riser for use with I33S4028B and I36S3931B
I33R44	2-1/2" Riser for use with I33S4430B and I36S4432B
Other Accessories	
Z1MT	Thermostat Millivolt Wall Mount
Z80PT	Thermostat Programmable Digital Millivolt Wall Mount (1F80-40)
Z1RC	Remote Control Millivolt (ON/OFF with LED) [Model I]
ZART	Remote Control Thermostat Millivolt [Model K]
RMCBN	Remote Control – Basic – Natural Gas (ON/OFF, HI/LO Flame Adjustment, Millivolt Only)
RMCBP	Remote Control – Basic – Liquid Propane (ON/OFF, HI/LO Flame Adjustment, Millivolt Only)
DCHS	Remote Control Heat Shield
GFRC	Remote Control Millivolt/IPI (ON/OFF)
GTRC	Remote Control Millivolt (Thermostat)
GTMRCN	Remote Control Millivolt (Thermostat/Modulating – NG)
GTMRCP	Remote Control Millivolt (Thermostat/Modulating – LP)
EGTRC	Remote Control IPI (Thermostat)
EGTMRCN	Remote Control IPI (Thermostat/Modulating – NG)
EGTMRCP	Remote Control IPI (Thermostat/Modulating – LP)
Millivolt Replacement Burner Assembly / Burner	
33IDV-BNGSI	Millivolt Burner Assembly [NG] – c/w Valve System (For use on IDV33N only)
33IDV-BLPSI	Millivolt Burner Assembly [LP] – c/w Valve System (For use on IDV33LP and IDV36LP)
36IDV-BNGSI	Millivolt Burner Assembly [NG] – c/w Valve System (For use on IDV36N only)
33IDV-200A	H-Burner (For use on IDV33/IDV36 only)
IPI Electronic Ignition Parts	
1006-P002SI	IPI Valve System HI/LO [NG]
1006-P003SI	IPI Valve System HI/LO [LP]
1002-P047SI	Pilot Assembly [LP]
1002-P033SI	Pilot Assembly [NG]
1002-P017SI	Spark Electrode with Wire
1002-P903SI	Electrode Flame Sensor
1002-P302SI	IPI Main Module Board
1002-P850SI	AC Wall Adapter
1002-P12BH	Battery Pack
1002-P912SI	Wiring Harness
1001-P166SI	IPI Pilot Orifice #62 [NG]
1001-P168SI	IPI Pilot Orifice #35 [LP]
1002-P013SI	Modulating Servo Motor [NG]
1002-P012SI	Modulating Servo Motor [LP]
1002-P016SI	Manual HI/LO Regulator [NG]
1002-P014SI	Manual HI/LO Regulator [LP]

Miscellaneous Parts

1000-150 GE	#Silicone GE Red IS806 #736
1000-150 MP	#Hi-Temp Millpac Sealant 840099
1000-214	#Piezo-Igniter 1244-17 MARK 21
1000-215	#PAL Nut (18mm x 1.5mm) Blk (1364.03)
1000-255	#Orifice Brass - #37 Natural Gas
1000-255	#Orifice Brass - #51 Liquid Propane
350-EMBER	#Embers
2000-P5637	#Spring Extension for Grills
6000-150	#Ceramic Robax Glass (For IDV33 – 27-1/2" x 16")
36HB-310	#Ceramic Robax Glass (For IDV36 – 31-11/16" x 20-7/16")
36IDV-MAN	#Manual – IDV33/IDV36
2000-080	#Thermodisc 2450 (For Blower)
2000-081	#Blower Motor QLN65/2400
2000-085	#Control Variable Speed KBWC-13BV
33IDV-123	#Replacement Spring for Door Latch
33IDV-106A	#Adapter Plate Complete
DVI33-301-1	Door Frame IDV33
DVI36-301	Door Frame IDV36
33IDV-120A	Springs for Latch Assembly

Parts for IDV33/IDV36 Venting

Part No.	Description
Venting	
IDVVT	Vertical Termination – Collinear 3"/3"
IDVFK25	3" Diameter [2Ea] Unexpanded 25ft Flex Pipe, Screws/Washers, Millpac
IDVLCP	Lower Chase Sealant Plate
ZDV3FC	Flex Connectors 3" Diameter

Troubleshooting the Gas Control System

WARNING: BEFORE DOING ANY GAS CONTROL SERVICE WORK, REMOVE THE GLASS FRONT. Before troubleshooting the gas control system, be sure external gas shut off is in the "On" position.

Problem	Possible Causes	Corrective Action
Spark igniter will not light.	Defective or misaligned electrode at pilot.	Check for spark at electrode and pilot: if no spark and electrode wire is properly connected, replace igniter.
	Defective igniter (push-button).	Using a match, light pilot. If pilot lights, turn off pilot and push the red button again. If pilot will not light - check gap at electrode and pilot should be 1/8" to 1/4" to have a strong spark.
Pilot will not stay lit after carefully following lighting instructions.	Defective thermocouple (flame switch where applicable).	Check pilot flame. Must impinge on generator and thermocouple. Clean and/or adjust pilot for maximum flame impingement on generator and thermocouple. Replace thermocouple if pilot will not hold. (Hand tight 1/8 turn on replacement)
	Defective valve magnet.	Replace valve, if pilot won't hold after the thermocouple is replaced.
Pilot burning, no gas to burner, valve knob "ON", and wall switch "ON".	Wall switch or wires defective.	Check wall switch and wires for proper connections. Jumper wire across terminals at wall switch. If burner comes on, replace defective wall switch. If okay, jumper wires, across wall switch wires at valve. If burner comes on, wires are faulty or connections are bad.
	Generator may not be generating sufficient voltage.	Check generator with millivolt meter. Take reading at generator terminals of gas valve. Should read 325 millivolts minimum while holding valve knob depressed in pilot position and wall switch "off" Replace faulty generator if reading is below specified minimum.
	Plugged burner orifice.	Check burner orifice for stoppage and remove.
	Defective automatic valve operator.	Remove wall switch wires from gas valve. Install jumper wires from top bottom terminals of gas valve. Turn valve on "ON". If main burner does not light, replace valve.
Frequent pilot outage problem.	Pilot flame may be too low or blowing (high) causing the pilot safety to drop out.	Clean and/or adjust pilot flame for maximum flame impingement on generator and thermocouple.
Flame lifts off burner and goes out in less than 30 seconds.	Inner 4" liner has come off flue or termination, flame is starving for oxygen.	Attach 4" liner to flue or termination using screws, silicone and clamps as stated in manual.
Flame lifts off burner on one side while the rest of the flame remains lit.	Improper installation of firebrick. Firebrick is likely leaning.	Be sure to position firebrick against firebox walls and be sure to use brick clips attached to the inner side of firebox.



LIMITED LIFETIME WARRANTY

This Limited Lifetime Warranty applies only while the unit remains at the site of the original installation and only if the unit is installed inside the continental United States, Alaska, Hawaii, and Canada. The warranty applies only if the unit is installed and operated in accordance with the printed instructions and in compliance with applicable installation and building codes and good trade practices.

BASIC ONE YEAR WARRANTY

During the first year after installation, we will provide a replacement for any component part of your unit found to be defective in materials or workmanship, including labour costs. Repair work requires prior approval by Kingsman, labour costs are based on a predetermined rate schedule and any repair work must be done through an authorized Kingsman dealer.

LIMITED LIFETIME WARRANTY

The heat exchanger, combustion chamber and burner of every Kingsman product excluding the Outdoor Firepit are warranted against materials or workmanship during the period the product is owned by the original owner. The part to be replaced must be returned to our distributor in exchange for the replacement part. Any labor, material, freight and/or handling charges associated with any repair or replacement pursuant to this Limited Lifetime Warranty will not be covered by this warranty.

GENERAL TERMS

In lieu of providing a replacement part, we may, at our option, provide the distributor's component purchase price from us or a credit equal to the distributors component purchase price from us toward the purchase of any new unit which we distribute. If a credit is given in lieu of a replacement part, the rating plate from the unit being replaced must be submitted on a warranty claim, and the unit being replaced must be made available to our distributor for disposition.

In establishing the date of installation for any purpose, including determination of the starting date for the term of this Limited Lifetime Warranty, reasonable proof of the original installation date must be presented*, otherwise the effective date will be based upon the date of manufacture plus thirty (30) days.

We will not be responsible for and you, the user, will pay for: (a) damages caused by accident, abuse, negligence, misuse, riot, fire, flood, or Acts of God (b) damages caused by operating the unit where there is a corrosive atmosphere containing chlorine, fluorine, or any other damaging chemicals (other than in a normal residential environment) (c) damages caused by any unauthorized alteration or repair of the unit affecting its stability or performance (d) damages caused by improper matching or application of the unit or the unit's components (e) damages caused by failing to provide proper maintenance and service to the unit (f) any expenses incurred for erecting, disconnecting or dismantling the unit (g) parts or supplies used in connection with service or maintenance (h) damage repairs, inoperation or inefficiency resulting from faulty installation or application (i) electricity or fuel costs or any increase in electricity or fuel cost whatsoever including additional or unusual use of supplemental electric heat.

We shall not be liable for any incidental, consequential, or special damages or expenses in connection with any use or failure of this unit. We have not made and do not make any representation or warranty of fitness for a particular use or purpose, and there is no implied condition of fitness for a particular use or purpose. We make no express warranties except as stated in this Limited Lifetime Warranty. No one is authorized to change this Limited Lifetime Warranty or to create for us any other obligation or liability in connections with this unit. Any implied warranties shall last for one year after the original installation. Some states and provinces do not allow the exclusion or limitation of incidental or consequential damages or do not allow limitations on how long an implied warranty or condition lasts, so the above limitations or exclusions may not apply to you. The provisions of this limited warranty are in additions to and not a modification of or subtraction from any statutory warranties and other rights and remedies provided by law.

Save this certificate. It gives you specific legal rights, and you may also have other rights which may vary from state to state and province to province.

In the event your unit needs servicing, contact your dealer or contractor who installed or serviced your unit. When requesting service, please have the model and serial number from each unit readily available. If your dealer needs assistance, the distributor is available for support and we, in turn support the distributor's efforts.

Fill in the installation date and model and serial numbers of the unit in the space provided below and retain this limited warranty for your files.

Model No. _____ Serial No. _____ Date installed _____

Dealer or Contractor Name: _____

*To receive advantage of your warranty, you must retain the original records that can establish the installation date of your unit.

The Ultimate in Design, Engineering & Quality