

# Installation Instructions

## Model Numbers ZV3600, ZV4200

### Zero Clearance Vented Gas Fireplace

Stock #'s: ZV3600N, ZV3600LP, ZV4200N, ZV4200LP are  
Certified to: ANSI Z21.50b-2000, CSA 2.22b-2009

**INSTALLER:** Leave this manual with the appliance.  
**CONSUMER:** Retain this manual for future reference.



**Read this complete manual before beginning installation.  
These instructions must be kept with the unit for future reference.**

## FOR YOUR SAFETY



**WARNING:** If the information in these instructions is not followed exactly, a fire or explosion may result causing property damage, personal injury or loss of life.



**WARNING:** Improper installation, adjustment, alteration, service or maintenance can cause property damage, personal injury or loss of life. Refer to this manual. Installation and service must be performed by a qualified installer, service agency or the gas supplier.

Do not store or use gasoline or other flammable vapors and liquids in the vicinity of this or any other appliance.

#### What to Do If You Smell Gas

Do not try to light any appliance.

Extinguish any open flame.

Do not touch any electrical switch.

Do not use any phone in your building.

Immediately call your gas supplier from a neighbour's phone.

If you can not reach your gas supplier, call the fire department.

**For Propane Horizontal installations the venting must be a minimum of one foot vertical off the flue before going horizontal.**



A Division of R-Co. Inc.  
2340 Logan Avenue  
Winnipeg, Manitoba, Canada R2R 2V3  
Ph: (204) 632-1962

## PRE-INSTALLATION QUESTIONS and ANSWERS

### Why does my fireplace or stove give off odour?

It is normal for your fireplace to give off some odour. This is due to the curing of the paint, adhesives, silicones and any undetected oil from the manufacturing process as well as the finishing materials used with the installations (e.g. marble, tile and the adhesives used to adhere this product to the walls can react with heat and cause odours).

It is recommended that you burn your gas fireplace or stove for a minimum of four hours at a time with the fan off after the curing of the paint has been completed. These odours can last upward to 40 hours of burn time, keep burning at a minimum of four hours per use until odours dissipate.

### About curing of the paint

Your stove or fireplace has been painted with the highest quality silicone stove paint. This paint dries quickly in 15-20 minutes when first applied at the factory. However, due to the high temperature silicone components, the paint will cure when heat is applied to the appliance as it is first used.

The following information **applies to the curing process** to get the paint fully hard and durable.

Fire the appliance four successive times for 10 minutes each firing and a 5 minute cool down between each. Be aware during log and firebox paint curing that a white deposit may be developing on the inside of the glass doors. It is important to remove this white deposit from the glass doors with an appropriate cleaner to prevent build-up (such as Windex or a commercial fireplace glass cleaner).

- Babies, small children, pregnant women and pets should leave the area during the cure phase.
- Ventilate well, open doors and windows.
- Do not touch during curing.

### Noise coming from the fireplace?

- Noise caused by metal expanding and contracting as it heats up and cools down, similar to the sound produced by a furnace or heating duct. This noise does not affect the operation or longevity of your fireplace.
- Different types and thicknesses of steel will expand and contract at different rates resulting in “cracking” and “ticking” sounds throughout the heating and cooling periods.
- You should also be aware that as temperatures change within the unit these sounds will likely re-occur. Again this is normal for steel fireboxes, and is not a defect.

### Cleaning the Glass

During the first few fires, a white film may develop on the glass front, as part of the curing process. The glass should be cleaned after the unit has cooled down or the film can bake on and become very difficult to remove. Use a non-abrasive cleaner and do not attempt to clean the glass while it is hot.

## Table of Contents

Warnings, Installations and Operations .....	4
Operations and Maintenance Instructions .....	5
Installation Requirements for the Commonwealth of Massachusetts ....	5
Locating your appliance.....	6
Framing your gas fireplace .....	6-8
Installation of optional fan kit .....	9
Installation of brick panels .....	10
Gas line installation .....	11
Operating and maintenance instructions .....	11
General glass information.....	12
Confirming proper venting of appliance.....	12
Log assembly and fan kit .....	13
Log Placement .....	14-20
Millivolt system, lighting, & burner control .....	21
Vent Installation .....	23
Repair parts list .....	24
Kingsman Fireplace part numbers & specifications Options .....	24
Kingsman Fireplace accessories.....	24
Kingsman Fireplace options .....	24
Valve System Parts.....	25
Trouble shooting the gas control system .....	26
Kingsman Industries Gas Fireplace – Limited Warranty.....	27

## Warnings, Installations, and Operations

### Installation Regulations

This gas appliance must be installed by a qualified installer in accordance with local building codes, or in the absence of local codes, with the current CAN/CGA-B149.1 Installation Code (in Canada) or the current National Fuel Gas Code Z223.1 when installed in the United States.

This appliance, when installed, must be electrically connected and grounded in accordance with local codes, or in the absence of local codes, with the current CSA C22.1 Canadian Electrical Code or with the national Electrical Code; ANSI/NFPA 70-1987 when installed in the United States.



### Warning

**FOR SAFE INSTALLATION AND OPERATION OF YOUR GAS FIREPLACE PLEASE NOTE THE FOLLOWING:**

1. Do not clean when the glass is hot.
2. Do not use abrasive cleaners.
3. Using a substitute glass will void all product warranties.
4. For safe operation, glass doors must be closed.
5. When purging the gas line, the glass front must be removed.
6. Do not strike or abuse glass. Take care to avoid breakage.
7. Do not alter gas orifice.
8. No substitute materials may be used other than factory supplied components.
9. This appliance gives off high temperatures and should be located out of heavy traffic areas and away from furniture and draperies.
10. Children and adults should be alerted to the hazards of the high surface temperatures of this appliance and should stay away to avoid burns or ignition of clothing.
11. Young children should be carefully supervised when they are in the same room as the appliance. Toddlers, young children and others may be susceptible to accidental contact burns. A physical barrier is recommended if there are at risk individuals in the house. To restrict access to a fireplace or stove, install an adjustable safety gate to keep toddlers, young children and other at risk individuals out of the room and away from hot surfaces.
12. Under no circumstances should any solid fuels (wood, paper) be used in this appliance.
13. Under no circumstances should this appliance be modified. Any parts that have to be removed for servicing should be replaced prior to operating this appliance.
14. Installation and repair should be done by a qualified service person. The appliance should be inspected before use and at least annually by a professional service person. More frequent cleaning may be required due to excessive lint from carpeting, bedding material, et cetera. It is imperative that control compartments, burners and circulating air passageways of the appliance be kept clean. Make sure that the gas valve and pilot light are turned off before you attempt to clean this unit.
15. Clothing or other flammable material should not be placed on or near the appliance. This appliance should not be used as a drying rack for clothing nor should Christmas stockings or decorations be hung from it.
16. Do not use this heater if any part has been under water. Immediately call a qualified service technician to inspect the heater and to replace any part of the control system and any gas control which has been under water.
17. Do not operate appliance unless completely installed as per installation instructions.
18. Failure to position the parts in accordance with these diagrams or failure to use only parts specifically approved with this appliance may result in property damage or personal injury.
19. Do not operate appliance with the glass front removed, cracked or broken. Replacement of the glass should be done by a licensed or qualified service person.
20. The front of the fireplace gives off high temperatures that could ignite combustible material which is kept close to the front of the unit.
21. Ensure that power to the Fireplace is turned off before servicing.
22. Do not operate this Fireplace without the glass front or with a broken glass.
23. Improper installation, adjustment, alteration, service or maintenance can cause injury or property damage. Refer to the owner's information manual provided with this appliance. For assistance or additional information consult a qualified installer, service agency, or the gas supplier.
24. Operation of this appliance when not connected to a properly installed and maintained venting system or tampering with the blocked vent shutoff system can result in carbon monoxide (CO) poisoning and possible death.



### WARNING



**HOT GLASS WILL  
CAUSE BURNS.**

**DO NOT TOUCH GLASS  
UNTIL COOLED.**

**NEVER ALLOW CHILDREN  
TO TOUCH GLASS.**

- Gas fired appliances may be used only for supplemental heat and/or decorative purposes and under no circumstances shall they provide a primary heat source.
- This appliance must not be connected to a chimney flue serving a separate solid-fuel burning appliance.

NOTE: It is recommended that a Carbon Monoxide (CO) Detector be installed in or near bedrooms and on all levels of your home. Place a detector about 15ft [4.5m] outside the room that houses your gas appliance.  
Certified for installation in a bedroom or bed/sitting room. In Canada must be installed with listed millivolt thermostat. In USA see local codes.

## Operations and Maintenance Instructions

For safe installation and operation note the following:

- The Burner/Log Assembly has been engineered and permanently adjusted for proper flame control.
- Periodically remove the logs from the grate assembly and vacuum any loose particles from the grate and burner areas. See Log Placement page to remove logs. Vacuum burner parts and replace logs.
- Label all wires prior to disconnection when servicing controls. Wiring errors can cause improper and dangerous operation.

## Installation Requirements for the Commonwealth of Massachusetts

Verify proper operation after servicing.

In the Commonwealth of Massachusetts, the installer or service agent shall be a plumber or gas fitter licensed by the Commonwealth.

When installed in the Commonwealth of Massachusetts or where applicable codes; the unit shall be installed with a CO detector per the requirements listed below.

1. For direct-vent appliances, mechanical-vent heating appliances or domestic hot water equipment, where the bottom of the vent terminal and the air intake is installed below four feet above grade the following requirements must be satisfied:
  - A. If there is not one already present, on each floor level where there are bedroom(s), a carbon monoxide detector and alarm shall be placed in the living area outside the bedroom(s). The carbon monoxide detector shall comply with NFPA 720 (2005 Edition).
  - B. A carbon monoxide detector shall be located in the room that houses the appliance or equipment and shall:
    - Be powered by the same electrical circuit as the appliance or equipment such that only one service switch services both the appliance and the carbon monoxide detector;
    - Have battery back-up power;
    - Meet ANSI./UL 2034 Standards and comply with NFPA 720 (2005 Edition); and
    - Have been approved and listed by a Nationally Recognized Testing Laboratory as recognized under 527 CMR.
  - C. A Product-approved vent terminal must be used, and if applicable, a Product-approved air intake must be used. Installation shall be in strict compliance with the manufacturer's instructions. A copy of the installation instructions shall remain with the appliance or equipment at the completion of the installation.
  - D. A metal or plastic identification plate shall be mounted at the exterior of the building, four feet directly above the location of vent terminal. The plate shall be of sufficient size to be easily read from a distance of eight feet away, and read "Gas Vent Directly Below".
2. For direct-vent appliances, mechanical-vent heating appliances or domestic hot water equipment where the bottom of the vent terminal and the air intake is installed above four feet above grade the following requirements must be satisfied:
  - A. If there is not one already present, on each floor level where there are bedroom(s), a carbon monoxide detector and alarm shall be placed in the living area outside the bedroom(s). The carbon monoxide detector shall comply with NFPA 720 (2005 Edition).
  - B. A carbon monoxide detector shall:
    - Be located in the room that houses the appliance or equipment;
    - Be either hard-wired or battery powered or both; and
    - Shall comply with NFPA 720 (2005 Edition).

A Product-approved vent terminal must be used, and if applicable, a Product-approved air intake must be used. Installation shall be in strict compliance with the manufacturer instructions. A copy of the installation instructions shall remain with the appliance or equipment at the completion of the installation.

For the state of Massachusetts a **T-handle gas shut-off valve** must be used on a gas appliance. This T-handle gas shut-off valve must be listed and approved by the state of Massachusetts. This is in reference to the state of Massachusetts state code CMR238.

## Locating your Appliance

(above or below grade)

### Installing with Top Vent

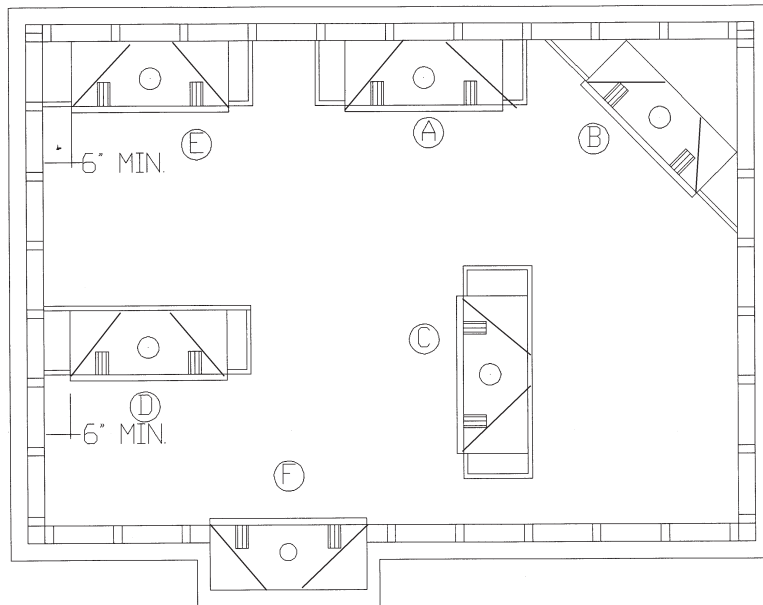

When you install your fireplace as in position 'B', 'D' or 'E', a minimum of 6 inches (153mm) clearance must be maintained from the perpendicular wall and the front of the appliance.

A - Flat on a wall  
B - Across the corner  
C - As an island

D - As a room divider  
E - Flat on wall corner  
F - Exterior wall

## Framing for your Gas Fireplace

### Framing Specifications

1. Cold climate installation recommendation: when installing this fireplace against non-insulated exterior wall or chase, it is recommended that the outer walls be insulated to conform to applicable insulation codes. Drywall should be installed over insulation to prevent contact of insulation and unit.
2. Choose fireplace location and frame in accordance with the fireplace dimensions specified (See framing diagrams). Bend nailing tabs forward on left and right of unit and place fireplace into framed enclosure. This allows for 1/2" in front of framing tabs for finishing materials.
3. Drywall or other material can extend flush with the appliance on the bottom and sides of the fireplace.
4. Non-combustible materials such as brick and tile can be extended across the face of the fireplace. If wide brass trim kit is going to be installed, brick and tile will have to be installed flush with the front of this appliance. If slim line brass trim kit is used, brick or tile may extend past the front of unit.

## Framing for your Gas Fireplace (cont.)

### FRAMING FOR ZV3600

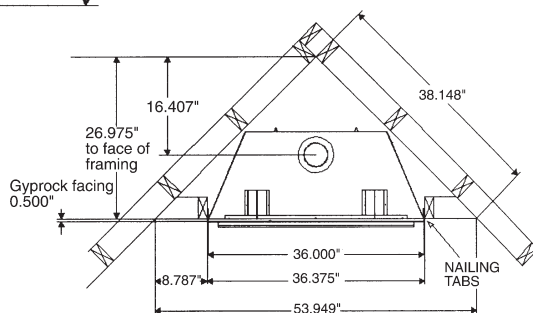
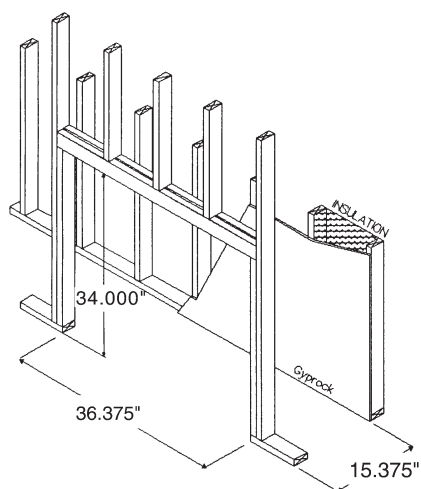
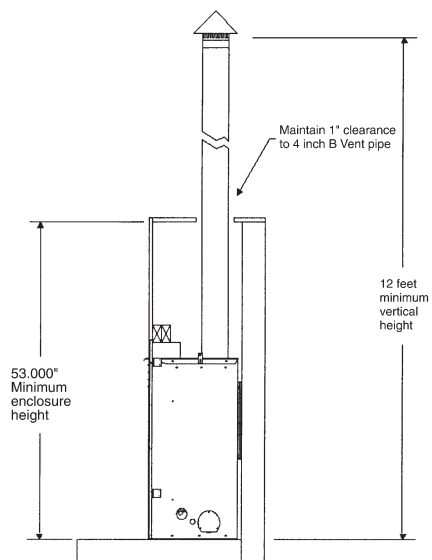

4" B-Vent

### FRAMING FOR ZV4200

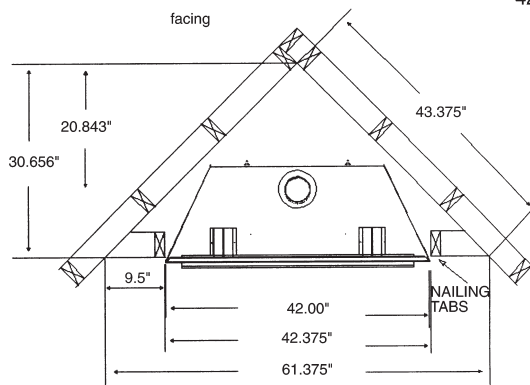
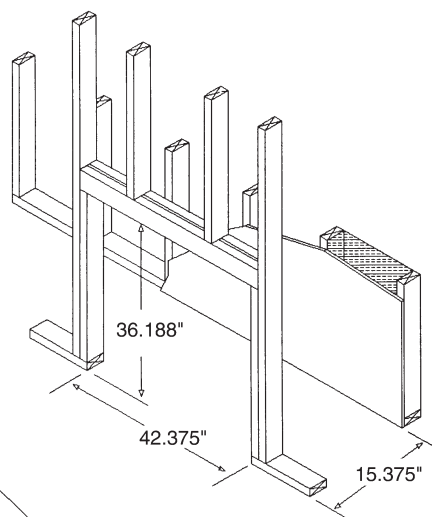
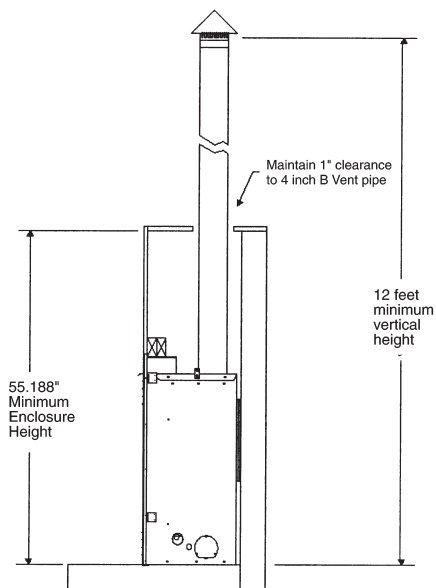

4" B-Vent

## Hearth

A hearth is not mandatory but is recommended for aesthetic purposes. We recommend a non-combustible hearth projecting out 12" (305mm) or more in front of the fireplace.

## Clearance to Combustibles

Back (from Standoffs)	0 inches/0 mm
Side (from standoffs)	0 inches/0 mm
Floor	0 inches/0 mm
Top (from standoffs)	0 inches/0 mm
Top (from front of unit)	0 inches/0 mm

**Note:** See Mantel Chart

## Mantels

Depending on the width of the fireplace mantel, it may be installed higher or lower from the top of the fireplace opening. See drawings for proper installation height of your combustible mantel. Non-combustible mantels may be installed at any height above the fireplace opening.

Non combustible materials such as brick, tile, etc. can extend up to or over the front face of the fireplace (NO PORTION OF GRILL AREA OR DOOR AREAS CAN BE COVERED).

Combustible material can extend flush to unit up to the top, bottom and sides of fireplace to stand-offs.

If slim line brass surround is used, brick, tiles or other NON-COMBUSTIBLE materials may extend past the front of unit giving a recessed appearance. For COMBUSTIBLE materials extending in front of fireplace consult "Mantel and Mantel Leg Drawings".

If wide brass surround is used finish materials must be flush with front of unit.

**Note:** When using paint or lacquer to finish the mantel, such paint or lacquer must be heat resistant (250°F) to prevent discoloration.

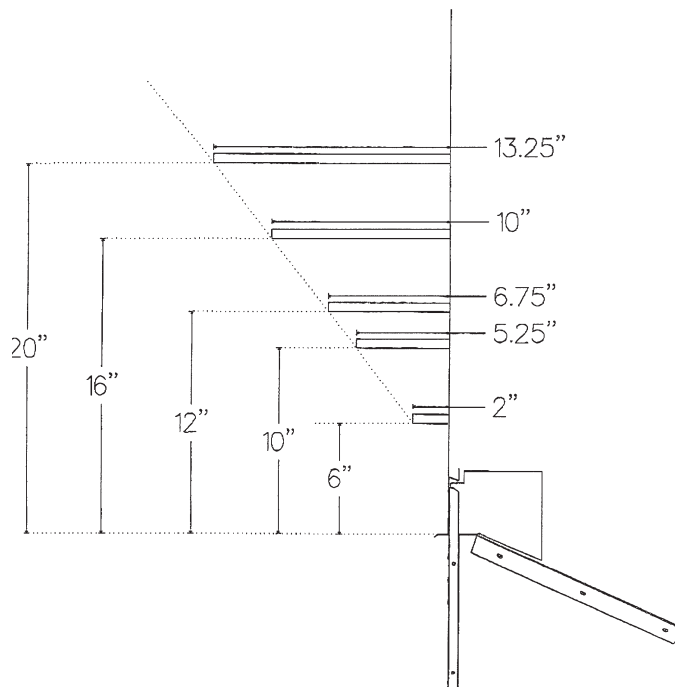

**Warning:** Combustible objects must not be placed on a non-combustible mantel unless the non-combustible mantel meets the minimum height and width requirements for a combustible mantel.

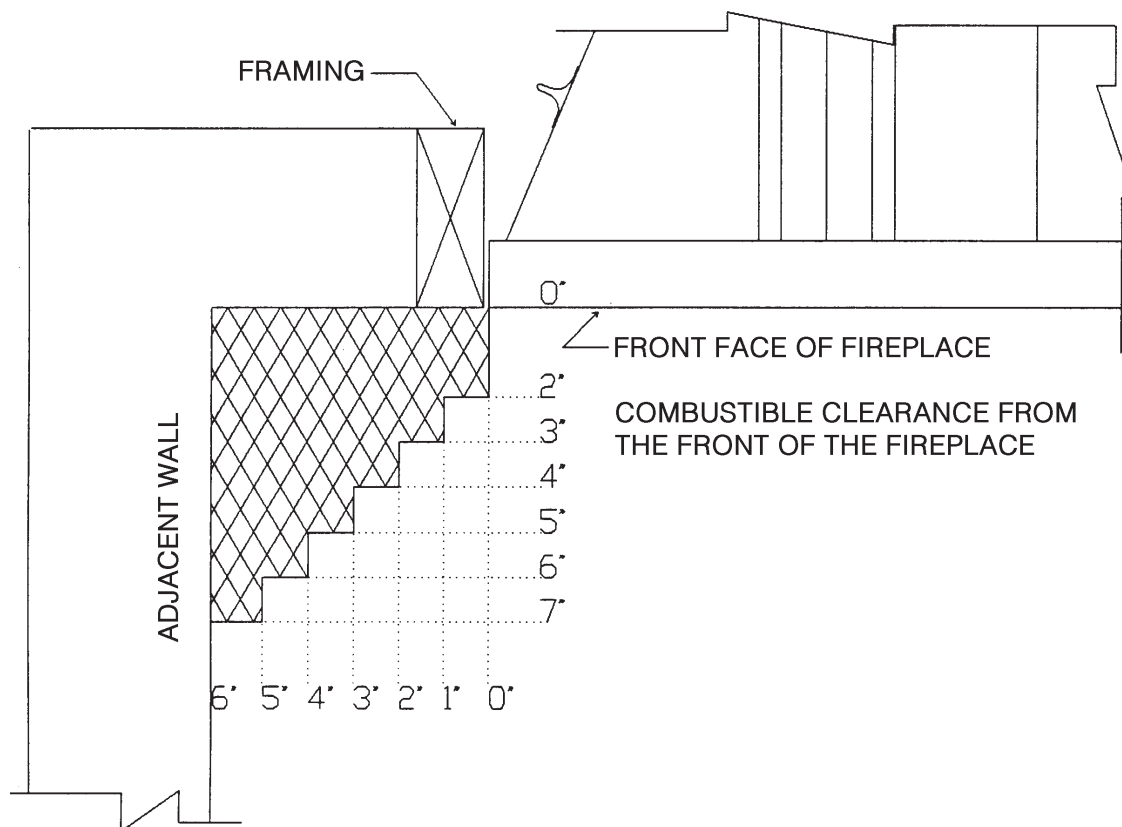



## Installation of optional Fan Kit

### Electrical Services

All optional fan kits are equipped with a 120V, 60 Hz blower.

Note: All electrical connections are to be made in accordance with CSA Standard C22.1 - Canadian Electrical Code part I or with the National Electrical Code, ANSI/NFPA 70 (latest edition) and/or in accordance with local codes.



**WARNING: Electrical Grounding Instructions.**  
This appliance is equipped with a three-pronged (grounding) plug for your protection against shock hazard and should be plugged directly into a properly grounded three-prong receptacle. Do not cut or remove the grounding prong from this plug.



**WARNING: Label all wires prior to disconnection when servicing controls. Wiring errors can cause improper and dangerous operation. Verify proper operation after servicing.**



**WARNING:**A qualified electrician must connect electrical wiring to junction outlet for built-in installation

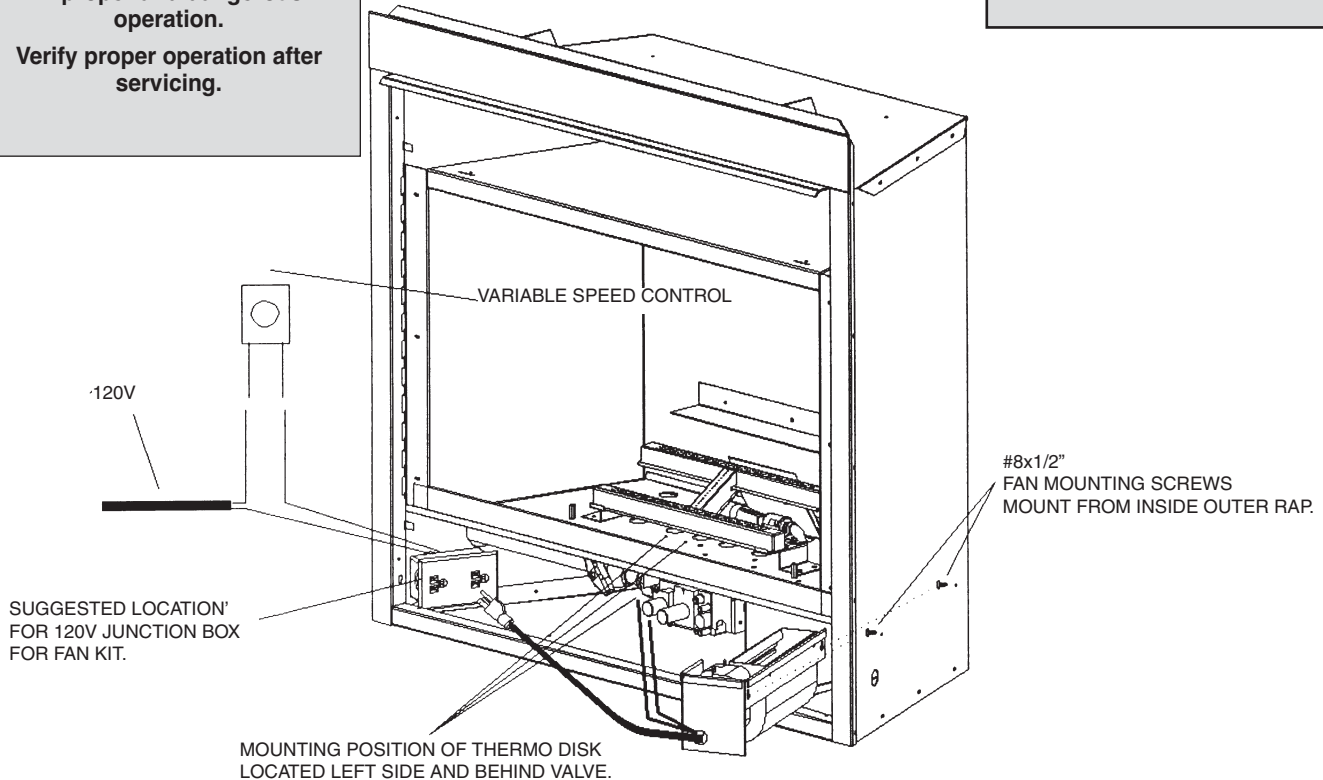

### Fan Mounting Instructions: Z33FK-FAN ASSEMBLY

1. Attach thermodisk securely to bottom of firebox. Screws are factory installed.
2. Screw #8 x 1/2" screws into outer rap wall from the inside (right side only). Fan housing can now be positioned by placing teardrop holes over the 2 screws mounted in the outer rap wall.
3. Junction box should be mounted to opposite side and wired to variable speed control and 120V power.
4. Plug fan into junction box and attach the 2 leads exiting the fan housing into the thermodisk.

## Installing Brick Panels

1. Place rear brick panel up against the back of the firebox.
2. Loosen screw holding brick clip in position, swing clip up out of the way and place side brick up to rear brick and flush against side wall of firebox. Position clip over brick and tighten screw.
3. Repeat same procedure for opposite side brick panel.

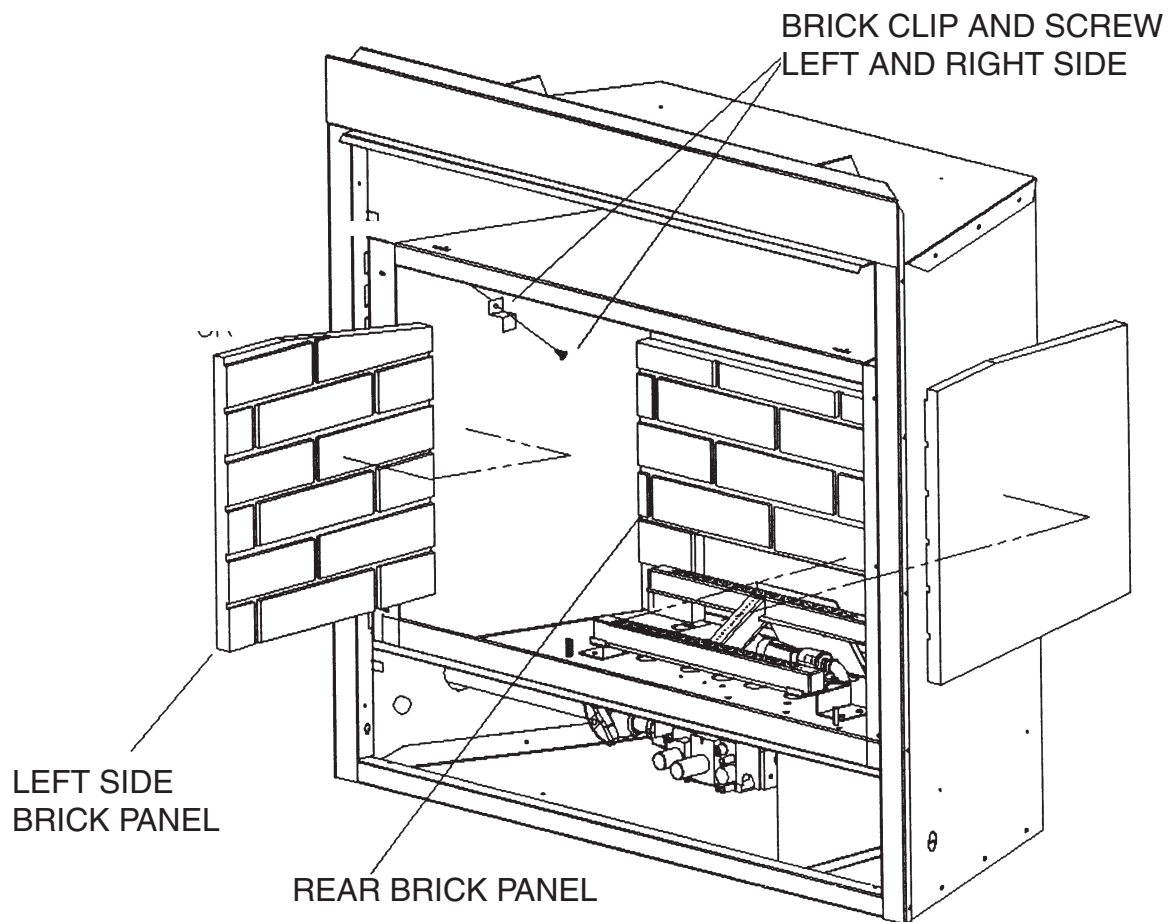

## Gas Line Installation

This gas appliance should be installed by a qualified installer in accordance with local building codes and with current CAN/CGA - B149.1 or .2 installation codes for Gas Burning appliances and equipment in Canada and the National Fuel Gas Code ANSI Z223 in the U.S.A.

1. The gas pipeline can be brought in through either the right or the left side of the appliance. A knockout is provided at either location to allow for the gas pipe installation and testing of any gas connection.
2. The gas control inlet is 1/2" NPT. Typical installation layout for rigid pipe is shown at right.
3. When using **copper** or **flex connector**, use only approved fittings. Always provide a union so that gas line can be easily disconnected for burner or fan servicing. See gas specification for pressure details and ratings.
4. When a vertical section of gas pipe is required for the installation, a condensation trap is needed. See CAN/CGA-B149.1 or .2 for code details.
5. For natural gas, a minimum of 3/8" iron pipe with gas minimum pressure of 4.5 w.c. must be used for supply from the gas meter. Consult with the local gas utility if any questions arise concerning pipe sizes.
6. 1/8" NPT plugged tappings are accessible for test gauge connection both on the inlet and outlet of the gas valve.
7. Turn the gas supply ON and check for leaks. **DO NOT USE OPEN FLAME FOR THIS PURPOSE.** Use an approved leak testing solution.
8. The appliance and its individual shutoff valve must be disconnected from the gas supply piping system during any pressure testing of that system at test pressures in excess of 1/2 PSIG (3.5 KPa).
9. The appliance must be isolated from the gas supply piping system by closing its individual shutoff valve during any pressure testing of the gas supply piping system at test pressures equal to or less than 1/2 PSIG (3.5 KPa).

**Note:** The gas line connection may be made of 1/2" rigid pipe or an approved flex connector. Since some municipalities have additional local codes, it is always best to consult your local authorities and the current CAN/CGA - B149.1 or .2 installation code in Canada or the National Fuel Gas code ANSI Z223.1 in the U.S.A.

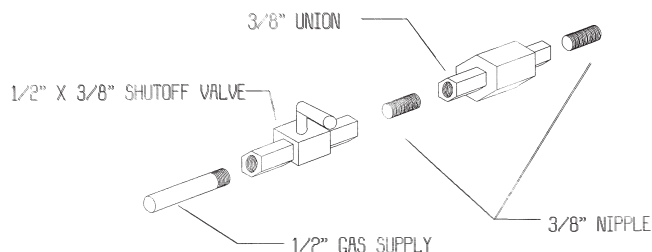

**Important:** Always check for gas leaks with a soap and water solution. Do not use open flame for leak testing.

### Gas Specifications

Model	Fuel	Gas Control	Maximum Input
ZV3600N	Natural	Millivolt	21,000 - 14,000 BTU
ZV4200N			
ZV3600LP	Propane	Millivolt	20,000 - 17,000 BTU
ZV4200LP			

Gas Inlet		3/8" NPT	
Gas Supply Pressure	Minimum	Normal (inches water column)	Maximum
Natural Gas	5.5	7.0	9.0
Propane Gas	11	11.0	12.0
Manifold Pressure	Natural Gas	3.5 inches water column	
	Propane Gas	10 inches water column	
Orifice Size	Natural Gas (0-4500 ft)	#44	Airshutter 1/16"
	Propane Gas (0-4500 ft)	#54	Airshutter 3/16"

For the state of Massachusetts a **T-handle gas shut-off valve** must be used on a gas appliance. This T-handle gas shut-off valve must be listed and approved by the state of Massachusetts. This is in reference to the state of Massachusetts state code CMR238.

## Operating and Maintenance Instructions

This gas appliance should be installed by a qualified installer in accordance with local building codes and with current CAN/CGA - B149 (.1 or .2) installation codes for Gas Burning Appliances and Equipment.



**Warning:** When purging the gas line, the glass front must be removed.

### For safe installation and operation note the following:

This appliance gives off high temperatures and should be located out of heavy traffic areas and away from furniture and draperies. Children and adults should be alerted to the hazards of high surface temperatures of this appliance and should stay away to avoid burns or ignition of clothing.

Under no circumstances should this appliance be modified. Parts that have to be removed for servicing should be replaced prior to operating this appliance again.

Installation and any repairs to this appliance should be done by a qualified service person. A professional service person should be called to inspect this appliance annually. Make it a practice to have all of your gas appliances checked annually.

Never use your gas fireplace as a cooking device.

The Burner/Log Assembly has been engineered and permanently adjusted for proper flame control.

### Do not alter gas orifice.

Periodically remove the logs from the grate assembly and vacuum any loose particles from the grate and burner areas.

Control compartments, burners and air passages in this appliance should be kept clean and free of dust and lint. Make sure that the gas valve and pilot light are turned off before you attempt to clean this unit.

The venting system (chimney) of this appliance should be inspected at least once a year and if needed, your venting system should be cleaned.

Keep the area around your appliance clear of combustible materials, gasoline and other flammable vapors and liquids.

This appliance should not be used as drying rack for clothing, nor should Christmas stockings or decorations be hung near it.

Under no circumstances should any solid fuels (wood, paper, cardboard, coal) be used in this appliance.

**Note:** It is normal for your gas fireplace to give off some odor the first time it is burned. This is due to the curing of the paint and any undetected oil from the manufacturing process.

Please ensure that your room is well ventilated - open all windows.

## General Glass Information

### Glass Cleaning

It will be necessary to clean the glass periodically. During start-up, condensation, which is normal, forms on the inside of the glass and causes dust, lint etc. to cling to the glass surface. Also, initial paint curing can deposit a slight film on the glass. It is therefore recommended that initially the glass be cleaned two or three times with non-abrasive common household glass cleansers and warm water. After that, the glass should be cleaned two or three times a season depending on the circumstances.



#### Warning and Cautions.

- Do not clean when the glass is hot.
- Do not use abrasive cleaners.
- Using a substitute glass will void all product warranties.
- Do not strike or abuse glass. Care must be taken to avoid breakage of the glass.
- Do not operate this fireplace without the glass front or with a broken glass.

### Glass Replacement

#### REPLACEMENT GLASS FOR BOTH VENTED UNITS

Model Series ZV3600 or ZV4200 can use either tempered glass or Robax ceramic or coated Neoceram glass. Must be 5mm thick.

To replace glass, clean all materials from door frame. Scrape off old silicone down to metal. Using a high heat silicone (temperature-resistant to 500°F (260°C)) apply a continuous bead of approximately 1/32" to all four sides of frame and insert glass with new gasket. Frame should be on flat surface, with a small amount of weight pressing glass into silicone. Let dry approximately 15 to 20 minutes. The door can be re-installed by reversing Steps 1 & 2. Use caution when removing broken glass, wear gloves.

### Removal of the Glass Door

1. Remove the two screws located behind upper grill or unfasten latches if so equipped.
2. To remove, pull frame forward and lift from bottom door retainer channel.

## Confirming Proper Venting of Appliance

To check for proper drafting, use this procedure.

1. Place unit in operation and let run for approx. 1 minute to establish up a draft.
2. Open top grill area to expose the draft hood.
3. Using a match or something that will produce smoke, place it up to the opening of the draft hood and verify that the flame or smoke is being drawn into the draft hood. If the flame or smoke is blown away from the draft hood opening, you may have to re-check the venting and verify that there is a minimum of 12 foot of venting or check the house for negative pressure. If there is negative pressure, you will have to bring fresh air to the unit.

A Fresh Air Kit may be required by some building codes, remove cover plate on the bottom side of unit and insert three inch flex duct into the side of fireplace by screwing it into the hole provided, attach the other end to the plastic wall vent. When possible place the plastic vent below the bottom of the fireplace

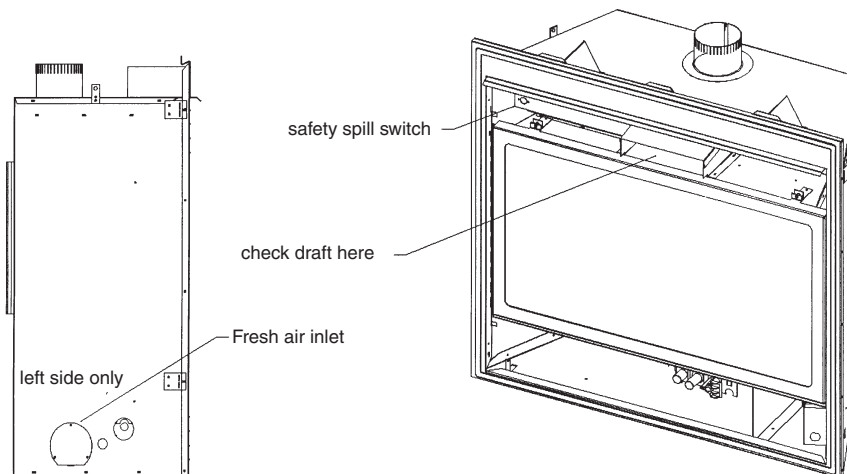

## Log Assembly for Models ZV3600 and ZV4200



**WARNING:** Failure to position the parts in accordance with these diagrams or failure to use only parts specifically approved with this appliance may result in property damage or personal injury.

### Log Assembly (LOGC42)

1. Remove glass door by removing two (2) screws behind upper grills or unfasten latches and lifting door off bottom door retainer channel.
2. Remove logs from carton (4 pcs) and inspect. (Part #LOGC42)
3. Verify to see that ember plates (2 pcs) are between front and back burner, air opening to top (as per diagram). The ember plates are used to hold the glowing ember, thus simulating a glowing bed of embers.
4. Place glowing embers (insulation) on surface of front burner and surface of ember plates.  
Height on front burner 1/2" - 3/4"  
Height on ember plates 3/4" - 1"  
Do not cover back air opening on ember plates.
5. Place rear log on log shelf 1/2" away from back of fireplace.
6. Place front log over front burner, and resting against decorative grate.
7. Place right and left logs across front and back log. Bark should be to the outside, and right log has a knot.
8. Adjust right and left log so that black charred area sits between front and rear log.
9. **Make sure that a space of at least 3/4" is maintained between glowing ember and underside of front log ember bed area.**
10. Front log should be centered on the log supports between the front and rear burners. Pull log against the front of the supports.
11. Top logs can then be placed across the front and back logs in the slots provided.
12. Place decorative moon rock on bottom of fireplace to simulate ash and then sprinkle vermiculite over rock.
13. Purge lines and test pilot operation.
14. Replace glass door. The door must be installed before operating the fireplace.

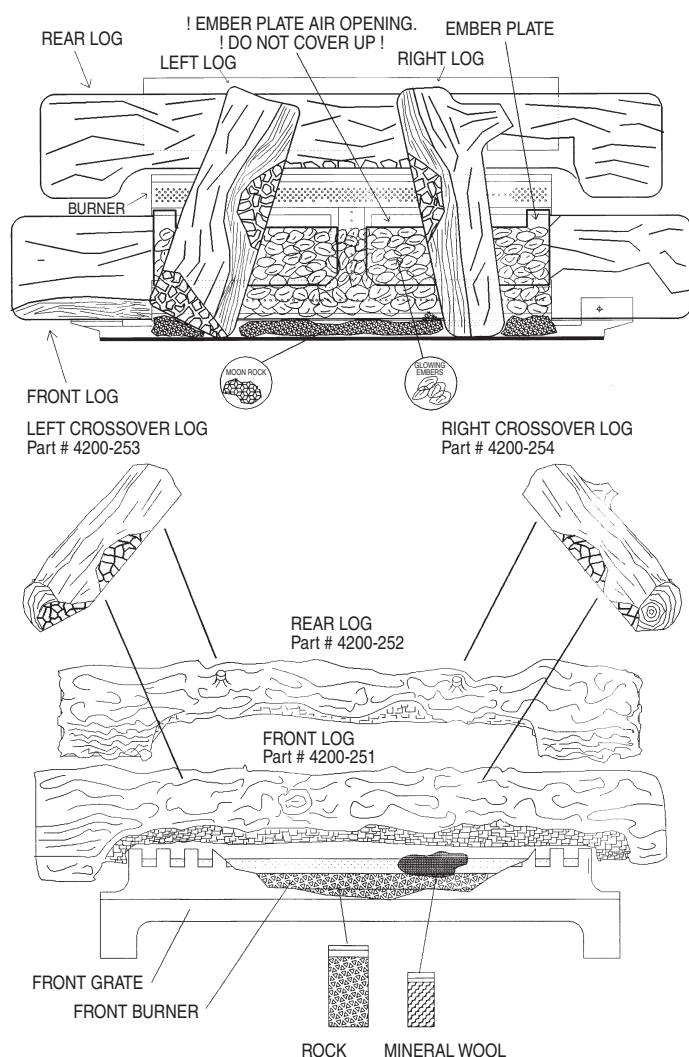

LOG SET 4200-250

**DO NOT PLACE DECORATIVE ROCK ON BURNERS**

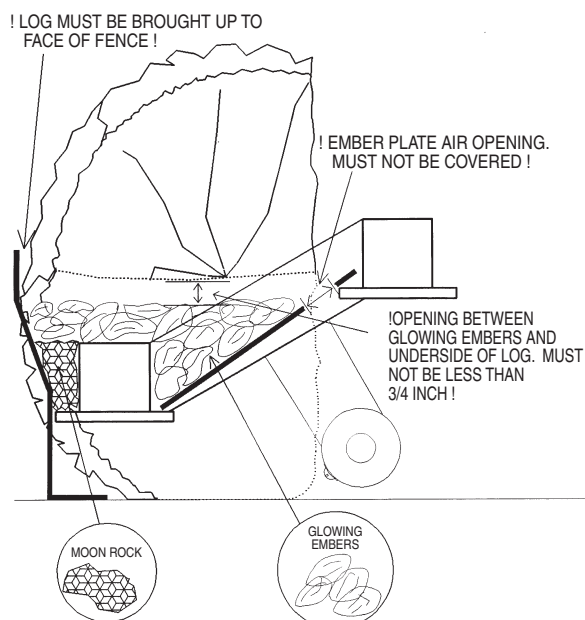



# LOGC42 PLACEMENT GUIDELINES

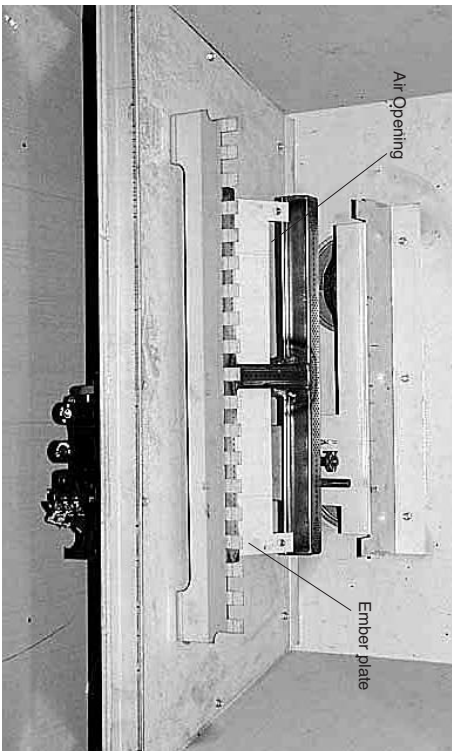

**Step (1)** Units are equipped with screws or latches. To remove glass door, either remove screws or unfasten latches and lift door off bottom door retainer

**Step (2)** Remove logs from carton and inspect each log.

**Step (3)** Verify to see that the ember plates (2 pcs.) are between front and back burner.

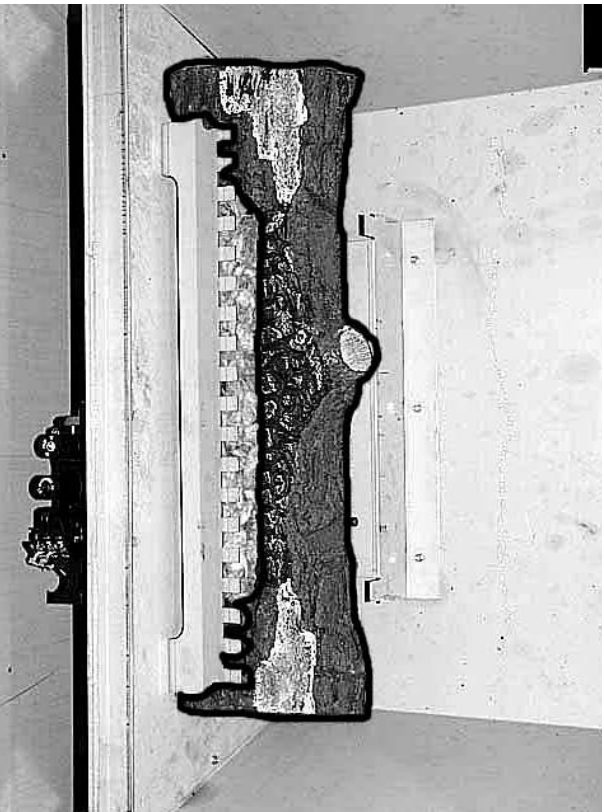

**Step (5)** Place front log over front burner, against decorative grate. Be sure that front log is tight up against the decorative grate.

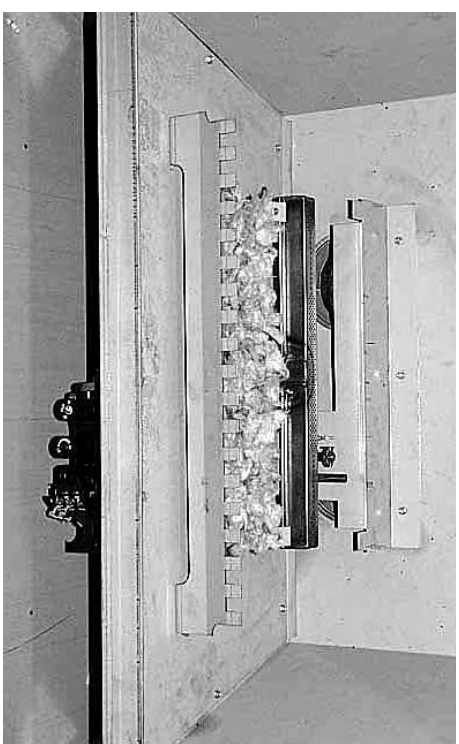

**Step (4)** Break glowing embers into thumbnail size. Place glowing embers on to the surface of the front burner, to the surface of the ember plates and over crossover to the same height as ember plates.

Height on front burner 1/2" to 3/4"

Height on ember plates 3/4" to 1"

Do not cover back air openings on ember plates.

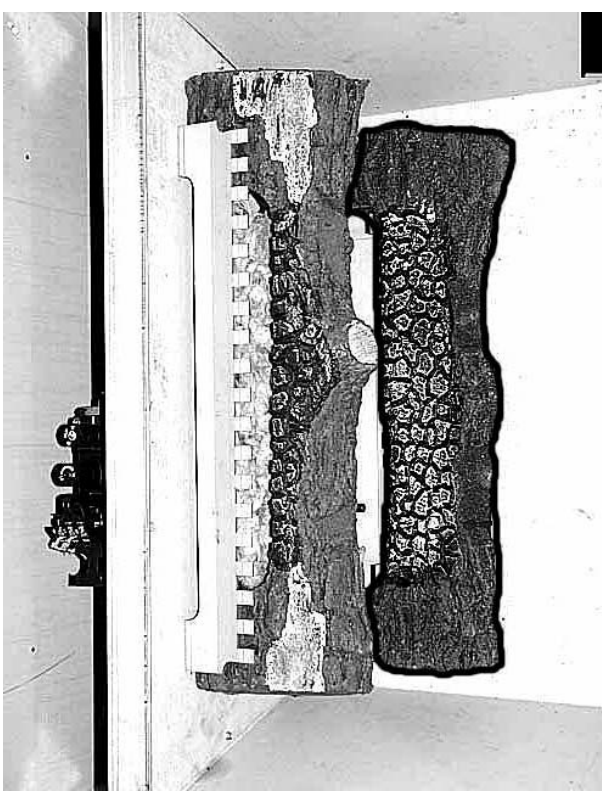

**Step (6)** Place rear log on to the log retainer 1/2" away from back of fire-place. (If refractory liner is used, make sure refractory liner is installed first then back log is to be pushed up against it as tight as possible.)

# LOGC42 PLACEMENT GUIDELINES (continued)

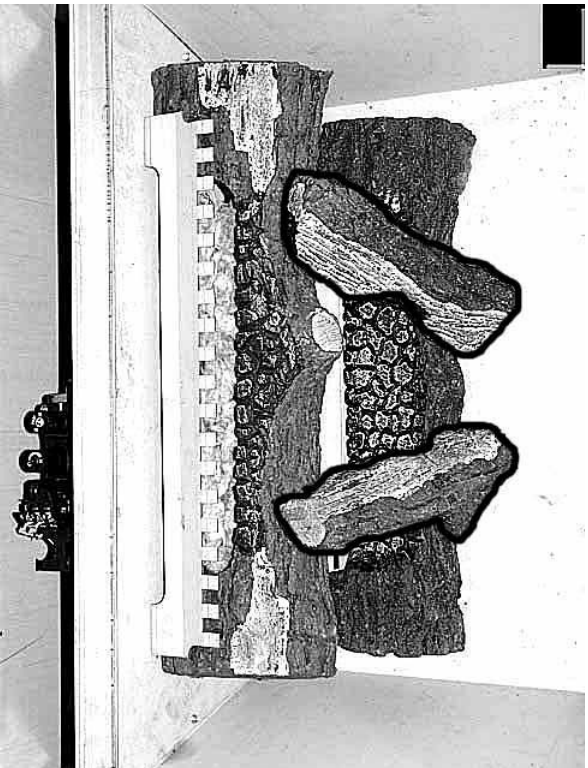

**Step (8)** Place left crossover log across front and back logs using the log placement pin as a guide. Bark should be to the outside.

**Step (9)** Adjust right and left crossover log so that the black charred area sits between front and rear log.

**Step (10)** Make sure that a space of at least 3/4" is maintained between glowing ember and underside of front log ember bed area.

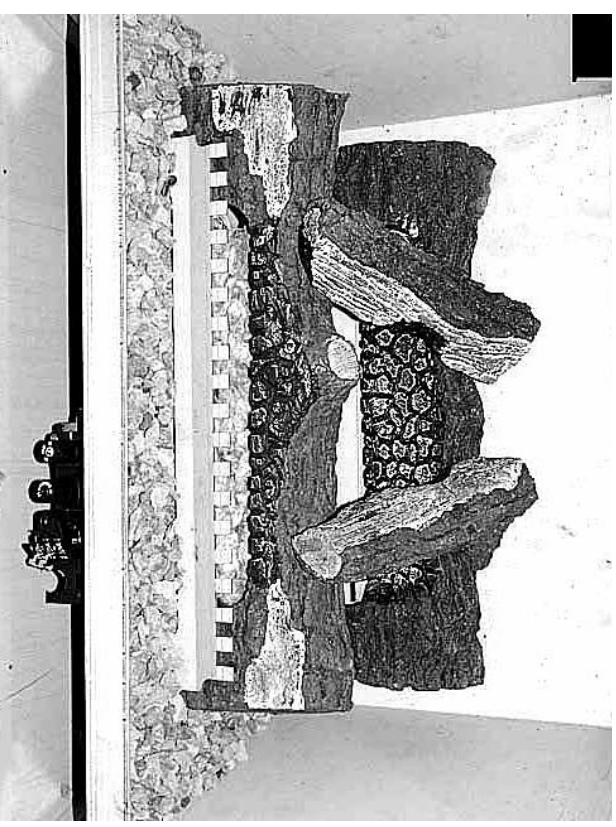

**Step (11)** Place decorative moon rock on bottom of fireplace to simulate ash.

**DO NOT PUT ANY ROCK ON BURNERS!**

**Step (12)** Purge lines and test pilot operation.

**Step (13)** Replace glass door.



# LOGC43 LOG PLACEMENT GUIDELINES



**FIGURE A** - Log set Ember kit and Crushed rock

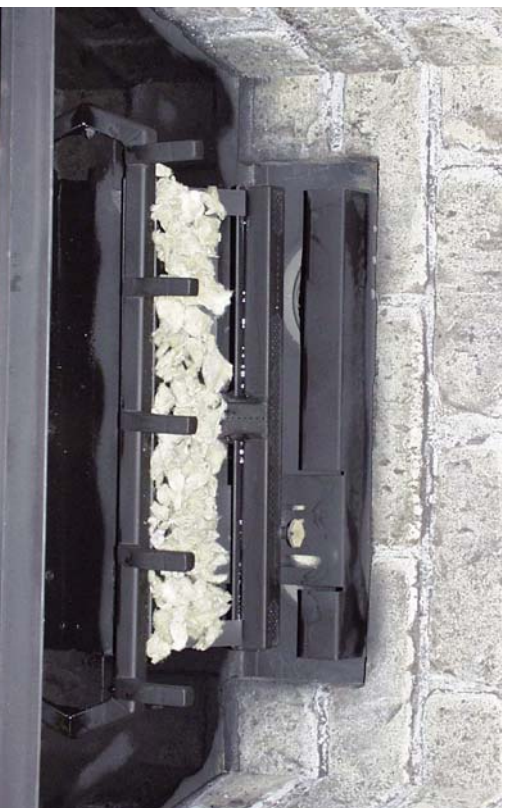

**Step (4)** Break glowing embers into thumbnail size. Place glowing embers on to the surface of the front burner, to the surface of the ember plates and over crossover to the same height as ember plates. Height on front burner 1/2" to 3/4". Height on ember plates 3/4" to 1". Do not cover back air openings on ember plates.



**FIGURE B** - Rear log holder.

**Step (1)** Units are equipped with screws or latches. To remove glass door, either remove screws or unfasten latches and lift door off bottom door retainer.

**Step (2)** Remove logs from carton and inspect each log.

**Step (3)** Verify to see that the ember plates (2 pcs) are between front and back burner.



**Step (5)** Place front log over burner, against decorative grate. Be sure that front log is tight up against the decorative grate.



## LOGC43 LOG PLACEMENT GUIDELINES (continued)



**Step (6)** Place rear log on to the log retainer 1/2" away from back of fire-place. (If refractory liner is used, make sure refractory liner is installed first then back log is to be pushed up against it as tight as possible.)



**Step (8)** Place left crossover log across front and back logs using the log placement pin as a guide.

**Step (9)** Place decorative moon rock on bottom of fireplace to simulate ash.

**DO NOT PUT ANY ROCK ON BURNERS!**



**Step (7)** Place right crossover log across front and back logs using the log placement pin as a guide.



**Step (10)** Purge lines and test pilot operation.

**Step (11)** Replace glass door.

# LOGC44 LOG PLACEMENT GUIDELINES

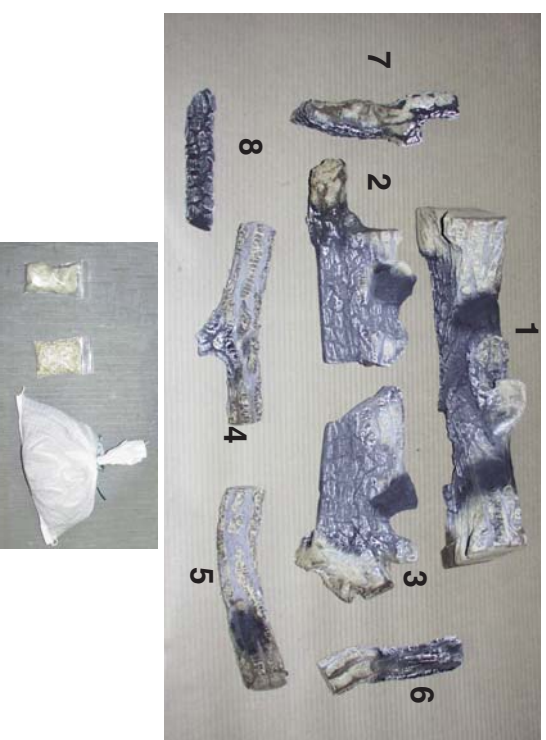

**FIGURE A** - Log set Ember kit and Crushed rock



**Step (1)** Position rear log over rear log holder and lower into position. Be sure that the log does not sit on rear burner, but behind and lower than burner.



**Step (2)** Locate flat surface on Log (2) and place directly onto left ember plate, push log fully to the right until it touches the crossing tube.



# LOGC44 LOG PLACEMENT GUIDELINES (continued)



**Step (3)** Locate flat surface on Log (3) and place directly on to right Ember plate, push log fully to the left until it touches Log (2)



**Step (5)** Position Log (4) into grooved areas of Logs (1) and (2).

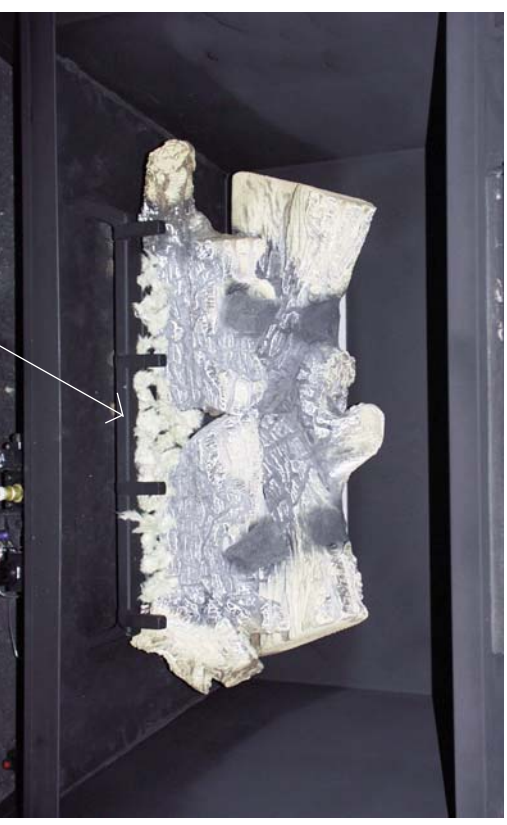

**Step (4)** Remove Ember material from plastic bag, tear off dime and nickel sized pieces and place directly onto front burner tube and crossover tube. (NOTE: Do not place embers onto rear burner tube)



**Step (6)** Position Log (5) into grooved area of Logs (1) and (3).

# LOGC44 LOG PLACEMENT GUIDELINES (continued)



**Step (7)** Position Log (6) up against the 2nd grate post from the right, and position upper section of Log (6) into grooved area of Log (5).



**Step (8)** Slide Log (7) between Log (1) and Log (2)



**Step (9)** Position Log (8) up against the 3rd grate post from the right, and position upper section of Log (8) against Logs (2) and (7).



**Step (10)** Place crushed rocks onto firebox bottom.  
(NOTE: Do not place crushed rock onto burner tubes)



# Millivolt System, Lighting, & Burner Control

## FOR YOUR SAFETY READ BEFORE LIGHTING

**WARNING:** If you do not follow these instructions exactly, a fire or explosion may result causing property damage, personal injury or loss of life.

### BEFORE LIGHTING

- A** This appliance has a pilot which must be lighted by hand. When lighting the pilot, follow these instructions exactly.
- B** Smell all around the appliance area for gas. Be sure to smell next to the floor because some gas is heavier than air and will settle on the floor.

#### WHAT TO DO IF YOU SMELL GAS

- Do not try to light an appliance.
- Do not touch any electrical switch; do not use any phone in your building.
- Immediately call your gas supplier from a neighbour's phone. Follow the gas supplier's instructions.

- If you cannot reach your gas supplier, call the fire department.
- C** Use only your hand to push or turn the gas control knob. Never use tools. If the knob will not push in or turn by hand, don't try to repair it, call a qualified technician. Force or attempted repair may result in a fire or explosion.
- D** Do not use this appliance if any part has been under water. Immediately call a qualified service technician to inspect the appliance and to replace any part of the control system which has been under water.

## LIGHTING INSTRUCTIONS

- Stop! Read the safety information above on this label.
- Set the thermostat to lowest setting.
- Turn off all electrical power to the appliance.
- Locate valve under the burner assembly.
- If the control knob is not already in the off position, ie. the word "OFF" in the 9 o'clock position, then push in the gas control knob slightly and turn clockwise to "OFF".  
NOTE: Knob cannot be turned from "PILOT" to "OFF" unless knob is pushed in slightly. Do not use force.
- Wait five (5) minutes to clear out any gas. If you then smell gas. STOP! Follow "B" in the safety information above on this label. If you don't smell gas then go to the next step.
- Now push in the control knob slightly and turn counter-clockwise to the "PILOT" position.
- Push in the control knob all the way and hold it. With the other hand push in the red ignitor button until you hear a click. Now observe closely the pilot burner located on the rear center-left hand side of the main burner. If a flame has appeared then continue to depress the control knob for 20 seconds. If the flame did not appear then continue to depress the red ignitor button every 5 seconds until a flame is established. NOTE: If after 30 seconds a flame has not yet been established then turn the control knob back to the off position and repeat steps 5, 6 & 7.
- Once the pilot has been established hold the control knob in the depressed position for approximately 25 seconds before releasing. If the flame goes out then repeat steps 7 and 8.
- Now turn the control knob to the "ON" position. The burner will not light unless the wall switch thermostat or remote control is turned "ON" or in the case of the thermostat there is a call for heat.
- Close the access door and turn all electric power back to the appliance.

## TO TURN OFF THE APPLIANCE

- Set the thermostat to lowest setting.
- Turn off all electric power to the appliance if service is to be performed.
- Open the control access door.
- Push in the gas control knob slightly and turn clockwise to the "OFF" position. Do not force.
- Replace control access panel.

### Recommended Maximum Lead Length (Double Wire) When Using Wall Switch or Thermostat

Wire Size	Max. Length
14 GA.	100 FT.
16 GA.	64 FT.
18 GA.	40 FT.
20 GA.	25 FT.
22 GA.	16 FT.

#### Pilot Burner Adjustment

- Adjust pilot screw to provide proper sized flame.

**CAUTION: DO NOT WIRE 120 VOLT POWER TO MILLI-VOLT SWITCHES OR THERMOSTAT.**

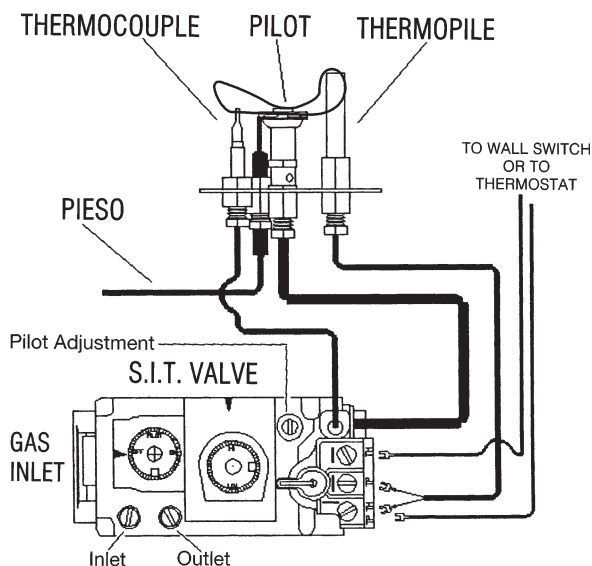

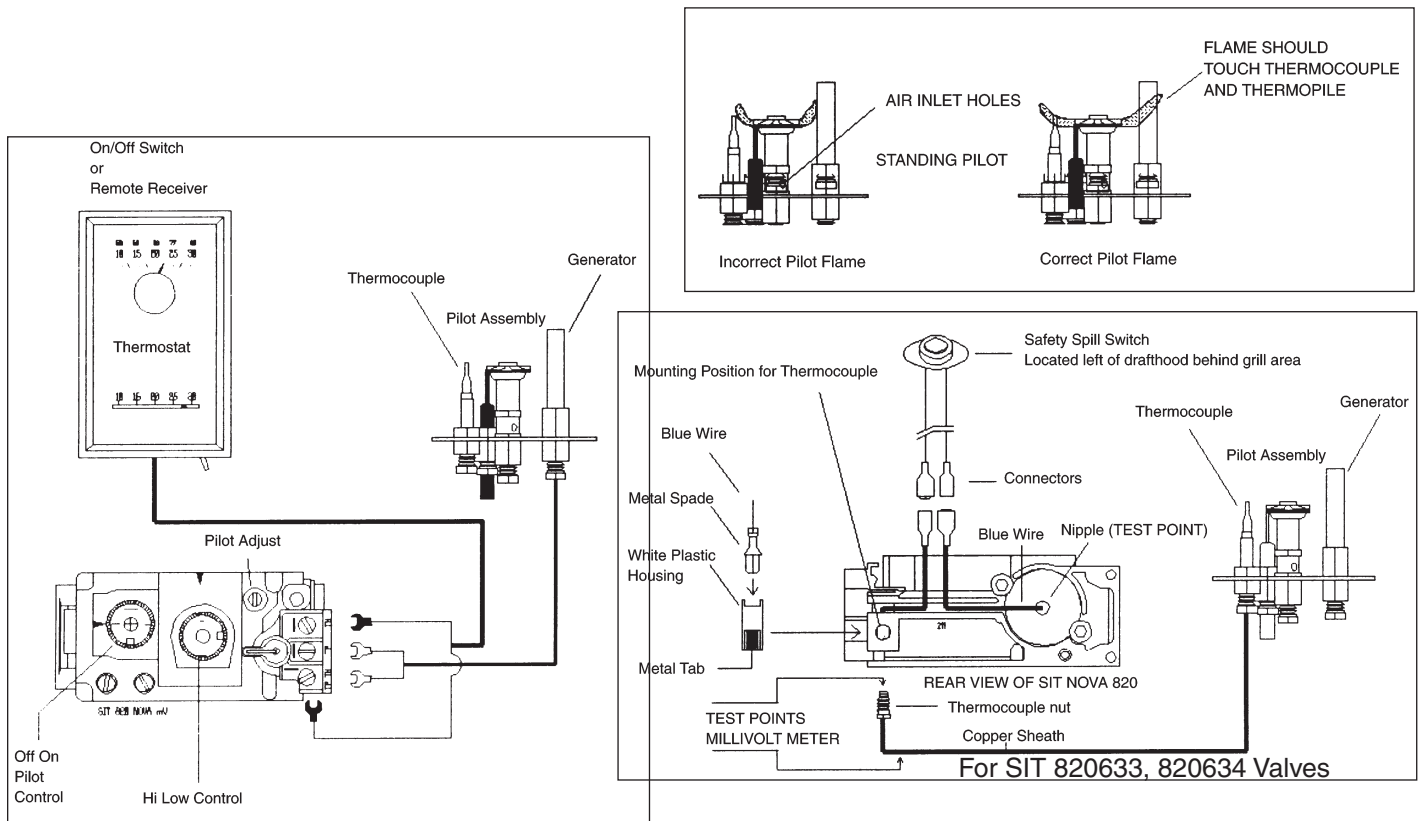

## **SPILL SAFETY SWITCH**

### Wiring Diagram

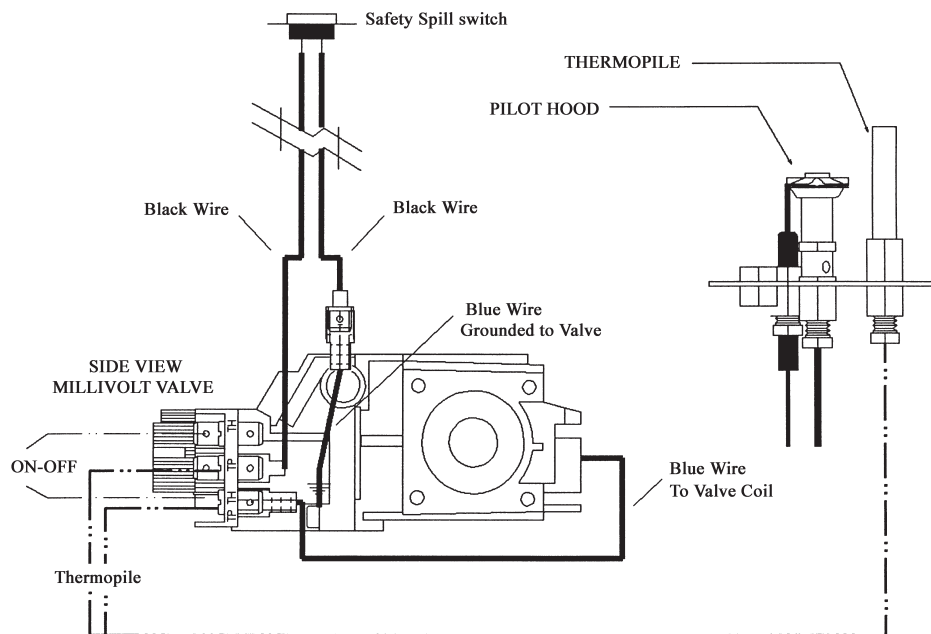

820.639 and 820.640 True Millivolt Systems.  
This System does not have a thermocouple.

For Units with serial numbers greater than 36350.

## Vent Instructions

**NOTE: A chimney venting this fireplace shall not vent any other appliance.**

This appliance may be vented into various types of applications: "A" Vent of solid fuel wood burning chimney, Masonry Clay lining and "B" Vent liquid fuel gas chimney.

**NOTE: Four (4) inch is required if existing chimney is five (5) inches or larger. Four (4) inch single wall or "B" Vent liquid fuel gas chimney may be used to adapt existing chimney or liner to fireplace.**

Single wall pipe must have 6" clearance to combustibles

When installing with "B" Vent liquid fuel gas chimney install as per "B" Vent Manufacturer Installation specifications. Offset vertical or vertical installations may be installed.

**NOTE: Installation of "B" Vent must follow "B" Vent Manufacturers Installation instructions when being used.**

Seal all connections in venting system.

### Chimney Installations

**Three types of chimney systems may be used with this unit.**

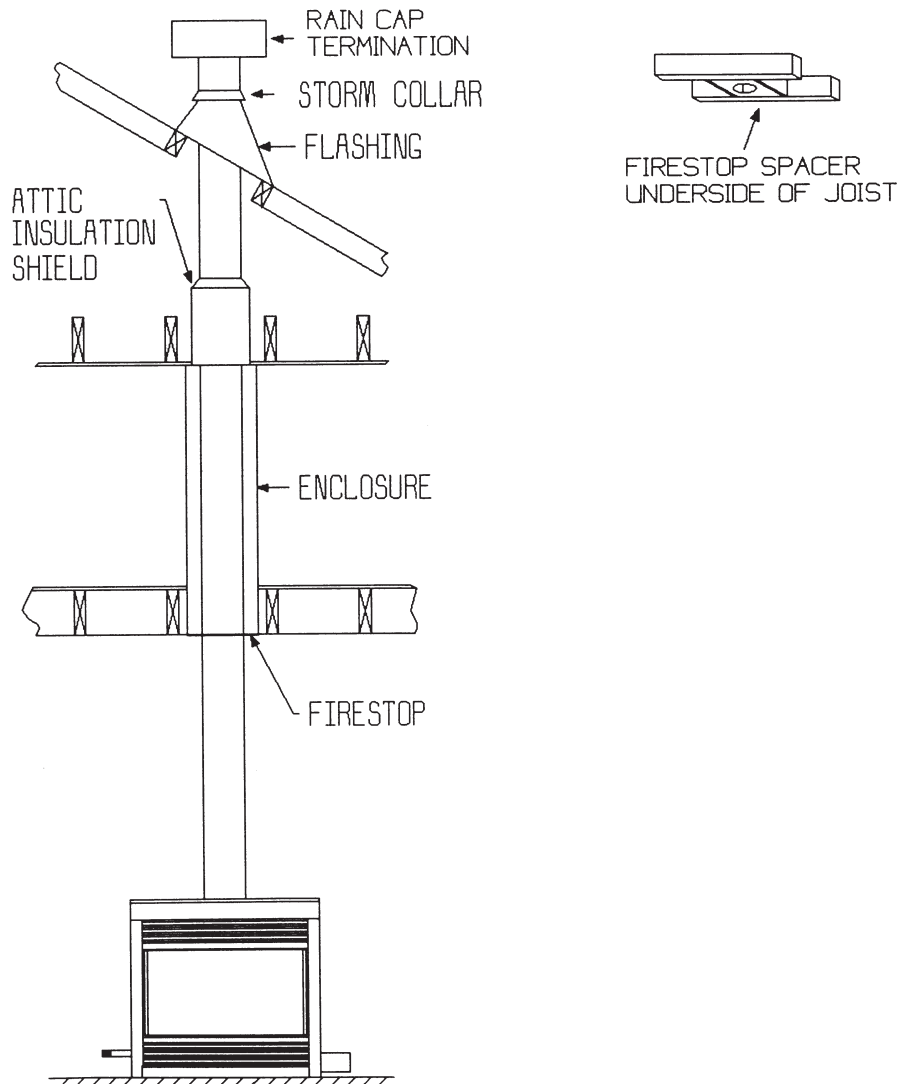

**A chimney venting this fireplace shall not vent any solid fuel burning appliance.**

## Parts List

PART NO.	DESCRIPTION
ZV3600N	Fireplace Decorative Top Flue (as above) NG, Tempered Glass, 21,000 BTU
ZV3600LP	Fireplace Decorative Top Flue (as above) LP, Tempered Glass, 20,000 BTU
<b>Log Sets: (Required for each unit)</b>	
LOGC42	Log Set - Four Piece - Classic Oak
LOGC43	Log Set - Four Piece - Traditional Oak
LOGC44	Log Set - Eight Piece - Burnt Oak
<b>Grills: (Required for each unit)</b>	
Z36GBA	Grill Kit - Classic Builder Antique Brass
Z36GBC	Grill Kit - Classic Builder Chrome
Z36GBP	Grill Kit - Classic Builder Polish Brass
Z1GBL	Grill Kit - Black
Z1GAB	Grill Kit - Antique Brass
Z1GPB	Grill Kit - Polish Brass
Z36GCR	Grill Kit - Chrome
Z36PBL	Panel Grill Kit - Black
<b>Fireplace Accessories Options:</b>	
Z36SAB	Surround - Antique Brass (Coverage Old Style 33 3/4" H x 39 7/8" W)
Z36SCR	Surround - Chrome (Coverage New Style 34 1/2" H x 41 1/8" W)
Z36SPB	Surround - Polish Brass (Coverage New Style 33 1/2" H x 41 1/8" W)
Z36SLAB	Surround Slim Line - Antique Brass (Coverage 34 1/4" H x 37 1/2" W)
Z36SLCR	Surround Slim Line - Chrome (Coverage 34 1/4" H x 37 1/2" W)
Z36SLPB	Surround Slim Line - Polish Brass (Coverage 34 1/4" H x 37 1/2" W)
Z36SLBL	Surround Slim Line - Gun Metal Black (Coverage 34 1/4" H x 37 1/2" W)
Z1ADBL	Arch Door Frame - Black
Z36ADDX	Arch Door Frame - Deluxe Black (352)
Z36ADTH	Arch Door Frame - Top half Black (353T)
Z36ADDA	Arch Door Frame - Double Arch Black (354)
Z36ADDD	Arch Door Frame - Double Door Arch Black (354)
Z1ADAB	Arch Door Frame - Antique Brass
Z36ADCR	Arch Door Frame - Chrome
Z1ADPB	Arch Door Frame - Polish Brass
Z33FK	Fan Kit w/Variable Speed Wall Mount Control (Temperature Sensing)
Z1MT	Thermostat Millivolt Wall Mount
Z80PT	Thermostat Programmable Digital Millivolt Wall Mount (1F80-40)
Z1RC	Remote Control Millivolt (On/Off with LED) (Model I)
ZART	Remote Control Thermostat Millivolt (Model K)
RMCBN	Remote Control - Basic - Natural Gas (On/Off, Hi/Lo Flame Adjustment, Millivolt Only)
RMCBP	Remote Control - Basic - Liquid Propane (On/Off, Hi/Lo Flame Adjustment, Millivolt Only)
DCHS	Remote Control Heatshield
Z36RL	Refractory Liner
Z65FAK	Fresh Air Kit
<b>Designer Doors for 36" Fireplaces - Operative</b>	
Z36DDA1BL	Designer Door Arch - Series 1 - Black
Z36DDTA1A	Trim - Antique for Designer Arch - Series 1
Z36DDTA1C	Trim - Chrome for Designer Arch - Series 1
Z36DDTA1P	Trim - Polish for Designer Arch - Series 1
Z36DDS1BL	Designer Door Straight - Series 1 - Black
Z36DDS2BL	Designer Door Straight - Series 2 - Black
Z36DDS3BL	Designer Door Straight - Series 3 - Black
Z36DDTS1A	Trim - Antique for Designer Straight - Series 1
Z36DDTS1C	Trim - Chrome for Designer Straight - Series 1
Z36DDTS1P	Trim - Polish for Designer Straight - Series 1

PART NO.	DESCRIPTION
<b>Child Safety Screens</b>	
Z36CSS	Child Safety Screen - 36" DV Fireplaces
ZV4200N	Fireplace Decorative Rated (as above) NG, Tempered Glass, 21,000 BTU
ZV4200LP	Fireplace Decorative Rated (as above) LP, Tempered Glass, 20,000 BTU
<b>Log Sets: (Required for each unit)</b>	
LOGC42	Log Set - Four Piece - Classic Oak
LOGC43	Log Set - Four Piece - Traditional Oak
LOGC44	Log Set - Eight Piece - Burnt Oak
<b>Grill Kit: (Required for each unit)</b>	
Z42GBA	Grill Kit - Classic Builder Antique
Z42GBC	Grill Kit - Classic Builder Chrome
Z42GBP	Grill Kit - Classic Builder Polish Brass
Z42GBL	Grill Kit - Black
Z42GAB	Grill Kit - Antique Brass
Z42GPB	Grill Kit - Polish Brass
Z42GCR	Grill Kit - Chrome
Z42PBL	Panel Grill Kit - Black
<b>Fireplace Accessories Options:</b>	
Z42SAB	Surround - Antique Brass (Coverage 36 5/8" H x 45 1/8" W)
Z42SCR	Surround - Chrome (Coverage 36 5/8" H x 45 1/8" W)
Z42SPB	Surround - Polish Brass (Coverage 36 5/8" H x 45 1/8" W)
Z42SLAB	Surround Slim Line - Antique Brass (Coverage 36 3/8" H x 43 3/8" W)
Z42SICR	Surround Slim Line - Chrome (Coverage 36 3/8" H x 43 3/8" W)
Z42SLPB	Surround Slim Line - Polish Brass (Coverage 36 3/8" H x 43 3/8" W)
Z42SLBL	Surround Slim Line - Gun Metal Black (Coverage 36 3/8" H x 43 3/8" W)
Z42ADBL	Arch Door Frame - Black
Z42ADDX	Arch Door Frame - Deluxe Black (352)
Z42ADTH	Arch Door Frame - Top Half Black (353T)
Z42ADDA	Arch Door Frame - Double Arch Black (354)
Z42ADDD	Arch Door Frame - Double Door Arch Black (354)
Z42ADAB	Arch Door Frame - Antique Brass
Z42ADCR	Arch Door Frame - Chrome
Z42ADPB	Arch Door Frame - Polish Black
Z33FK	Fan Kit w/Variable Speed Wall Mount Control (Temperature Sensing)
Z1MT	Thermostat Millivolt Wall Mount
Z80PT	Thermostat Programmable Digital Millivolt Wall Mount (1F80-40)
Z1RC	Remote Control Millivolt (On/Off with LED) (Model I)
ZART	Remote Control Thermostat Millivolt (Model K)
RMCBN	Remote Control - Basic - Natural Gas (On/Off, Hi/Lo Flame Adjustment, Millivolt Only)
RMCBP	Remote Control - Basic - Liquid Propane (On/Off, Hi/Lo Flame Adjustment, Millivolt Only)
DCHS	Remote Control Heatshield
Z42RL	Refractory Liner (3 Piece)
Z65FAK	Fresh Air Kit
<b>Designer Doors for 42" Fireplaces - Operative</b>	
Z42DDA1BL	Designer Door Arch - Series 1 - Black
Z42DDTA1A	Trim - Antique for Designer Arch - Series 1
Z42DDTA1C	Trim - Chrome for Designer Arch - Series 1
Z42DDTA1P	Trim - Polish for Designer Arch - Series 1
Z42DDS1BL	Designer Door Straight - Series 1 - Black
Z42DDS2BL	Designer Door Straight - Series 2 - Black
Z42DDS3BL	Designer Door Straight - Series 3 - Black
Z42DDTS1A	Trim - Antique for Designer Straight - Series 1
Z42DDTS1C	Trim - Chrome for Designer Straight - Series 1
Z42DDTS1P	Trim - Polish for Designer Straight - Series 1



## Parts List

PART NO.	DESCRIPTION
<b>Child Safety Screens</b>	
Z42CSS	Child Safety Screen - 42" DV Fireplaces
<b>Valve System Parts - SIT NOVA</b> (If Serial Number is LESS than 36184)	
1000-P136WR	Thermopile GOAI-524
1001-P035SI	Electrode Sparker 915.035 SIT
1001-P129SI	Thermocouple 290.129 SIT unified
1001-P157SI	Orifice Pilot LP 977.157 SIT
1001-P159SI	Orifice Pilot NG 977.159 SIT
1001-P508SI	HT Cable 16
1001-P633SI	Valve Nova LP Hi/Lo 0820633
1001-P634SI	Valve Nova NG Hi/Lo 0820634
1001-P605SI	Pilot Burner LP 190.605 unified SIT
1001-P606SI	Pilot Burner NG 190.606 unified SIT
<b>Valve System Parts - SIT NOVA</b> New top convertible SIT (If Serial Number is between 36184-36350)	
1000-P136WR	Thermopile GOAI-524
1001-P069SI	Electrode Sparker 915.069 TC SIT
1001-P216SI	Thermocouple 290.216 TC SIT
1001-P165SI	Orifice Pilot NG 977.165 TC SIT
1001-P167SI	Orifice Pilot LP 977.167 TC SIT
1001-P508SI	HT Cable 16
1001-P633SI	Valve Nova LP Hi/Lo 0820633
1001-P634SI	Valve Nova NG Hi/Lo 0820634
1001-P713SI	Pilot Burner LP 199.713 TC SIT
1001-P714SI	Pilot Burner NG 199.714 TC SIT
<b>Valve System Parts - SIT NOVA</b> New SIT TC True Millivolt (If Serial Number is GREATER than above)	
1000-P136WR	Thermopile GOAI-524
1001-P069SI	Electrode Sparker 915.069 TC SIT
1001-P165SI	Orifice Pilot NG 977.165 TC SIT
1001-P167SI	Orifice Pilot LP 977.167 TC SIT
1001-P639SI	Valve Nova LP Hi/Lo 0820639 True MV
1001-P640SI	Valve Nova NG Hi/Lo 0820640 True MV
1001-P745SI	Pilot Burner LP 199.745 TC TM
1001-P746SI	Pilot Burner NG 199.746 TC TM
<b>Miscellaneous Parts</b>	
1000-214	#Piezo-Igniter 1244-17 MARK 21
1000-215	#Pal Nut (18MMX1.5MM)BLK (1364.03)
1000-218	#Switch Ivory (1451/001)
1000-227	#Cover Ivory (86001/001)
1000-255	#Orifice Brass - (State Size)
6000-130	#Explosion Felt Gasket
2000-080	#Thermo Disc 2450 (For Blower)
1000-085	#Control Variable Speed KBWC-13BV
1000-306	Thermalcord - Adhesive Back for Door Frame
1000-305	Ceramic Glass - For All ZDV3600
3600-311	Tempered Glass (ZV3600)
4200-311	Tempered Glass (ZV4200)
36ZV-P300TD	Spill Switch

### Replacement Burner Assembly

36ZV-BNGSI	Burner Assembly ZV3600N-SIT
36ZV-BLPSI	Burner assembly ZV3600LP-SIT
42ZV-BNGSI	Burner assembly ZV4200N-SIT
42ZV-BLPSI	Burner assembly ZV4200LP-SIT

### Valve System Parts - Honeywell

1001-P8520EN	Valve hi/lo-NG- HONEYWELL
1001-P8520EP	Valve hi/lo-LP - HONEYWELL

### Conversion Kit (SIT Valve only)

3600ZV-CKLP	LP Conversion Kit for ZV3600
3600ZV-CKNG	NG Conversion Kit for ZV3600
4200ZV-CKLP	LP Conversion Kit for ZV4200
4200ZV-CKNG	NG Conversion Kit for ZV4200

## Trouble Shooting The Gas Control System



**WARNING:** BEFORE DOING ANY GAS CONTROL SERVICE WORK, REMOVE THE GLASS FRONT.

**NOTE:** Before troubleshooting the gas control system, be sure external gas shut off is in the "On" position.

Problem	Possible Causes	Corrective Action
Spark igniter will not light.	Defective or misaligned electrode at pilot.	Check for spark at electrode and pilot: if no spark and electrode wire is properly connected, replace igniter.
	Defective igniter (push-button)	Using a match, light pilot. If pilot lights, turn off pilot and push the red button again. If pilot will not light - check gap at electrode and pilot should be 1/8" to 1/4" to have a strong spark.
Pilot will not stay lit after carefully following lighting instructions.	Defective safety spill switch	Check pilot flame. Must impinge on generator and thermocouple. Clean and/or adjust pilot for maximum flame impingement on generator and thermocouple. Be sure wire connections from spill safety switch are connected securely to wires on back of valve. If pilot still doesn't light, unplug spill switch wires at valve and then plug thermocouple wires (blue in color) together. If this works, the spill switch is defective.
	Defective thermocouple	Replace thermocouple
	Defective valve magnet.	Turn valve knob on "On", place wall switch on "On". Millivolt meter should read greater than 100mV. If the reading is okay and the burner does not come on, replace the gas valve.
Pilot burning, no gas to burner, Valve knob "ON", Wall Switch "ON"	Wall switch or wires defective.	Check wall switch and wires for proper connections. Jumper wire across terminals at wall switch. If burner comes on, replace defective wall switch. If okay, jumper wires, across wall switch wires at valve. If burner comes on, wires are faulty or connections are bad.
	Generator may not be generating sufficient voltage.	Check generator with millivolt meter. Take reading at generator terminals of gas valve. Should read 325 millivolts minimum while holding valve knob depressed in pilot position and wall switch "off" Replace faulty generator if reading is below specified minimum.
	Plugged burner orifice.	Check burner orifice for stoppage and remove.
	Defective automatic valve operator.	Remove wall switch wires from gas valve. Install jumper wires from top bottom terminals of gas valve. Turn valve on "ON". If main burner does not light, replace valve.
Frequent Pilot outage problem.	Pilot flame may be too low or blowing (high) causing the pilot safety to drop out.	Clean and/or adjust pilot flame for maximum flame impingement on generator and thermocouple.



## LIMITED LIFETIME WARRANTY

This Limited Lifetime Warranty applies only while the unit remains at the site of the original installation and only if the unit is installed inside the continental United States, Alaska, Hawaii, and Canada. The warranty applies only if the unit is installed and operated in accordance with the printed instructions and in compliance with applicable installation and building codes and good trade practices.

### BASIC ONE YEAR WARRANTY

During the first year after installation, we will provide a replacement for any component part of your unit found to be defective in materials or workmanship, including labour costs. Repair work requires prior approval by Kingsman, labour costs are based on a predetermined rate schedule and any repair work must be done through an authorized Kingsman dealer.

### LIMITED LIFETIME WARRANTY

The heat exchanger, combustion chamber and burner of every Kingsman product excluding the Outdoor Firepit are warranted against materials or workmanship during the period the product is owned by the original owner. The part to be replaced must be returned to our distributor in exchange for the replacement part. Any labor, material, freight and/or handling charges associated with any repair or replacement pursuant to this Limited Lifetime Warranty will not be covered by this warranty.

### GENERAL TERMS

In lieu of providing a replacement part, we may, at our option, provide the distributor's component purchase price from us or a credit equal to the distributors component purchase price from us toward the purchase of any new unit which we distribute. If a credit is given in lieu of a replacement part, the rating plate from the unit being replaced must be submitted on a warranty claim, and the unit being replaced must be made available to our distributor for disposition.

In establishing the date of installation for any purpose, including determination of the starting date for the term of this Limited Lifetime Warranty, reasonable proof of the original installation date must be presented\*, otherwise the effective date will be based upon the date of manufacture plus thirty (30) days.

We will not be responsible for and you, the user, will pay for: (a) damages caused by accident, abuse, negligence, misuse, riot, fire, flood, or Acts of God (b) damages caused by operating the unit where there is a corrosive atmosphere containing chlorine, fluorine, or any other damaging chemicals (other than in a normal residential environment) (c) damages caused by any unauthorized alteration or repair of the unit affecting its stability or performance (d) damages caused by improper matching or application of the unit or the unit's components (e) damages caused by failing to provide proper maintenance and service to the unit (f) any expenses incurred for erecting, disconnecting or dismantling the unit (g) parts or supplies used in connection with service or maintenance (h) damage repairs, inoperation or inefficiency resulting from faulty installation or application (i) electricity or fuel costs or any increase in electricity or fuel cost whatsoever including additional or unusual use of supplemental electric heat.

We shall not be liable for any incidental, consequential, or special damages or expenses in connection with any use or failure of this unit. We have not made and do not make any representation or warranty of fitness for a particular use or purpose, and there is no implied condition of fitness for a particular use or purpose. We make no express warranties except as stated in this Limited Lifetime Warranty. No one is authorized to change this Limited Lifetime Warranty or to create for us any other obligation or liability in connections with this unit. Any implied warranties shall last for one year after the original installation. Some states and provinces do not allow the exclusion or limitation of incidental or consequential damages or do not allow limitations on how long an implied warranty or condition lasts, so the above limitations or exclusions may not apply to you. The provisions of this limited warranty are in additions to and not a modification of or subtraction from any statutory warranties and other rights and remedies provided by law.

Save this certificate. It gives you specific legal rights, and you may also have other rights which may vary from state to state and province to province.

In the event your unit needs servicing, contact your dealer or contractor who installed or serviced your unit. When requesting service, please have the model and serial number from each unit readily available. If your dealer needs assistance, the distributor is available for support and we, in turn support the distributor's efforts.

Fill in the installation date and model and serial numbers of the unit in the space provided below and retain this limited warranty for your files.

**Model No.** \_\_\_\_\_ **Serial No.** \_\_\_\_\_ **Date installed** \_\_\_\_\_

**Dealer or Contractor Name:** \_\_\_\_\_

\*To receive advantage of your warranty, you must retain the original records that can establish the installation date of your unit.